

PLAZA EAST

11100 NE 8th St, Bellevue

Washington Partners

Corporate Real Estate

**AVAILABLE FOR
SUBLEASE**

FLOOR 8 | SUITE 800
6,998 RSF - DIVISIBLE TO 3,068 SF



PLAZA EAST

11100 NE 8th St, Bellevue

Washington Partners

Corporate Real Estate



- 6,998 RSF, divisible to 3,068 SF
- \$38.00 FS
- 3/1,000 parking ratio
- Available with 90 day notice
- Master lease expires 6/8/20
- Views of Mt. Rainer
- Great access to I-405
- Furniture potentially available
- New build out

CONTACT:

CRAIG LEVINE

425.451.3171

craigl@wapartners.com

FLOOR 8 | SUITE 800

6,998 RSF - DIVISIBLE TO 3,068 SF

DIVISIBLE SPACE
3,068 SF

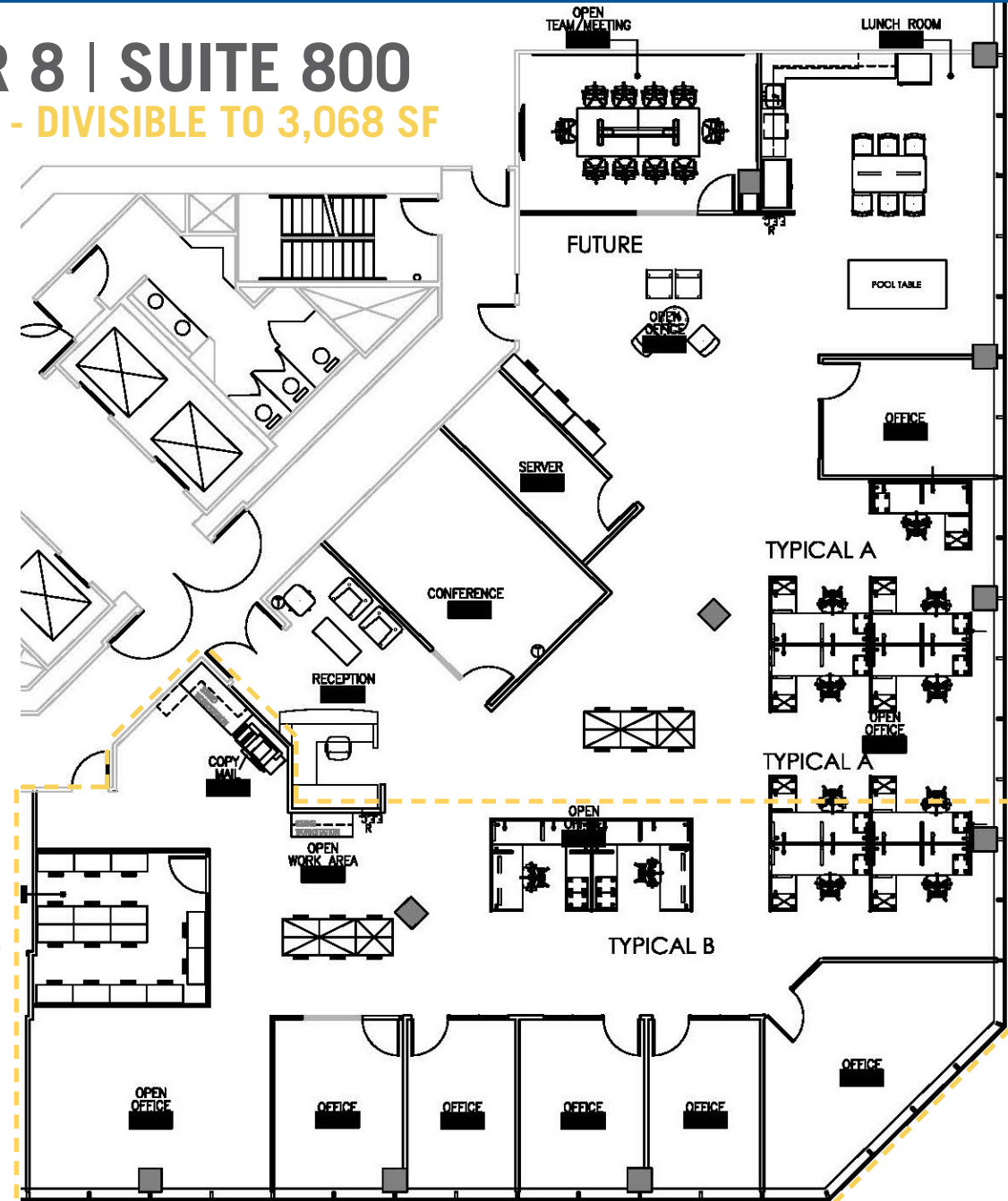

This information supplied herein is from sources we deem reliable. It is provided without any representation, warranty or guarantee, expressed or implied as to its accuracy. Prospective Buyer or Tenant should conduct an independent investigation and verification of all matters deemed to be material, including, but not limited to, statements of income and expenses. Consult your attorney, accountant, or other professional advisor.