

# WILLOWS PATHWAY BUILDING

5,100 RSF OFFICE / FLEX / WAREHOUSE



14907 NE 95th Street | Redmond, Washington

## PROPERTY FEATURES

- 5,100 RSF - Office / Flex / Warehouse Space
  - Approx. 2,550 SF - Office
  - Approx. 2,550 SF - Flex / Warehouse
- HVAC throughout
- Grade level loading
- 4/1,000 parking
- Available immediately
- Great space for office, flex, production, and storage tenants
- Asking Rates:
  - \$1.40/SF/Mo, NNN - Office
  - \$0.80/SF/Mo, NNN - Warehouse
  - NNN: \$0.43/SF/Mo

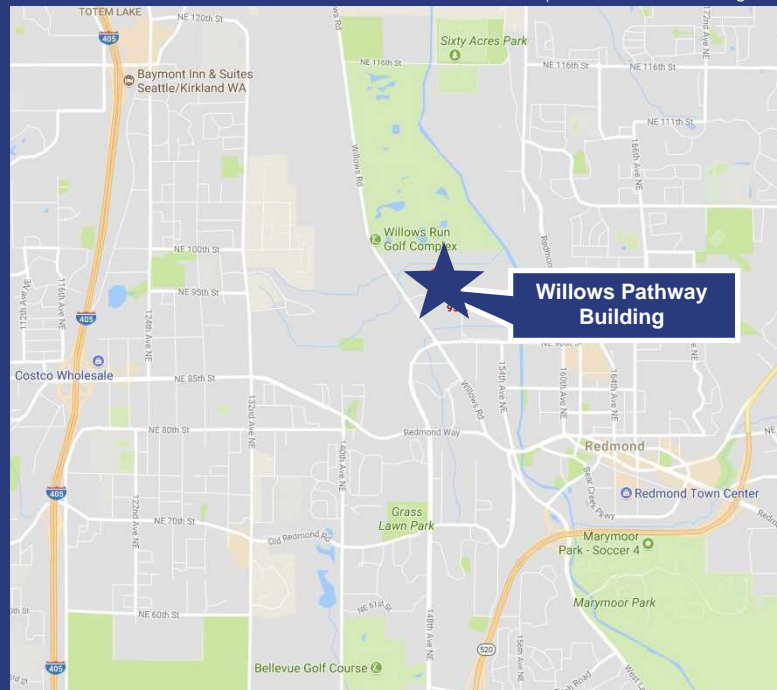

For more information, please contact:



BRODERICK GROUP  
10500 NE 8th Street, Suite 900  
Bellevue, WA 98004  
(425) 646-3444

### TYLER SLONE

425.274.4281 | slone@broderickgroup.com

### CONNOR GILCHRIST

425.274.4286 | gilchrist@broderickgroup.com

broderickgroup.com

The information contained herein has been given to us by the owner or sources that we deem reliable. We have no reason to doubt its accuracy, but we do not guarantee it. Prospective tenants should carefully verify all information contained herein.

# WILLOWS PATHWAY BUILDING

5,100 RSF OFFICE / FLEX / WAREHOUSE

14907 NE 95th Street | Redmond, Washington

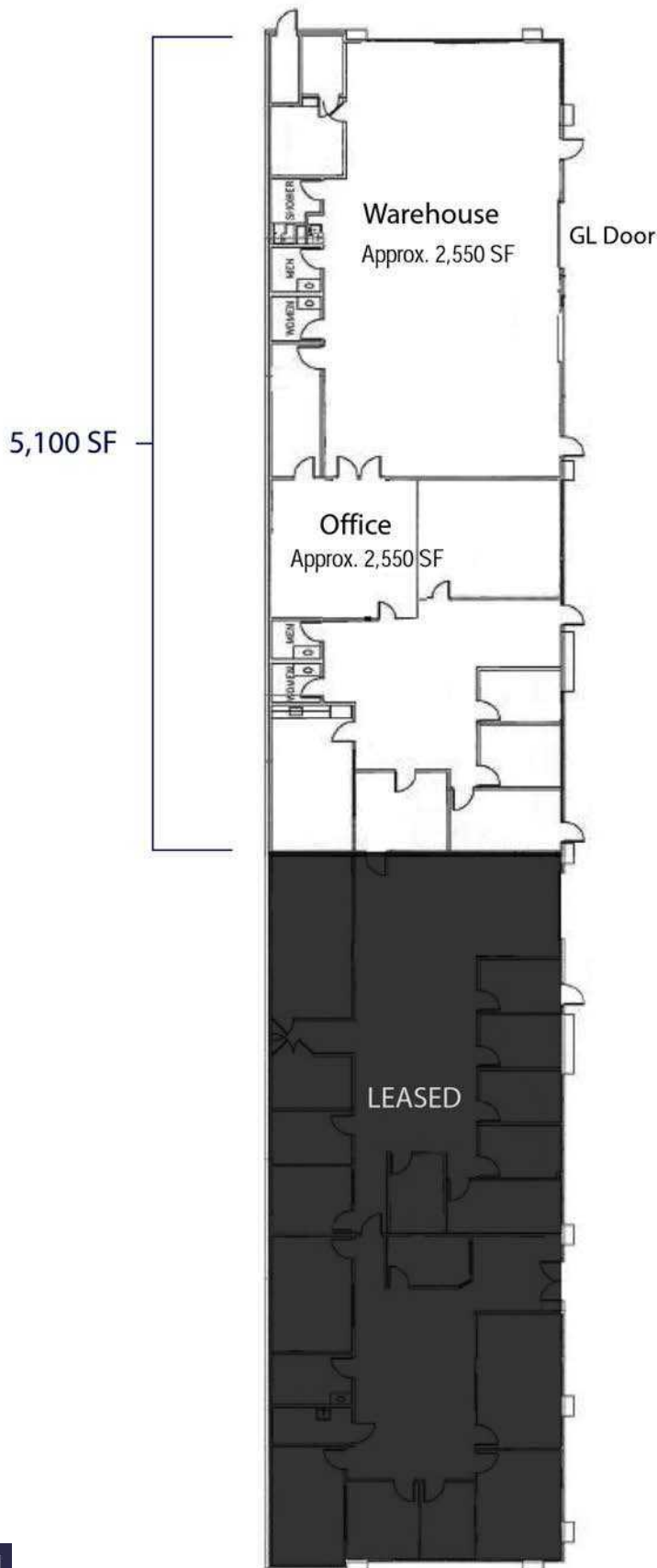

**TYLER SLONE**

425.274.4281

slone@broderickgroup.com

**CONNOR GILCHRIST**

425.274.4286

gilchrist@broderickgroup.com



The information contained herein has been given to us by the owner or sources that we deem reliable. We have no reason to doubt its accuracy, but we do not guarantee it. Prospective tenants should carefully verify all information contained herein.