

WILLOWS PATHWAY BUILDING

5,100 RSF OFFICE / FLEX / WAREHOUSE

14907 NE 95th Street | Redmond, Washington

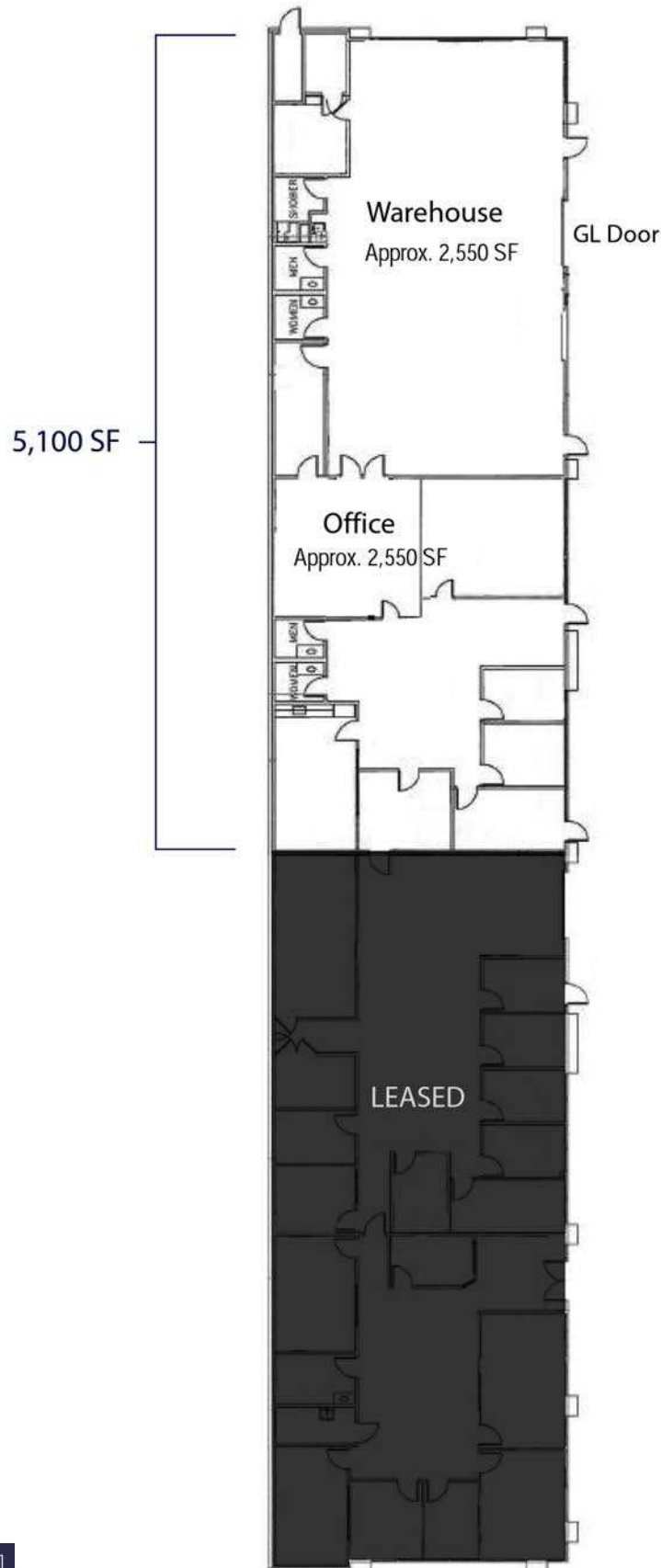

TYLER SLONE

425.274.4281

slone@broderickgroup.com

CONNOR GILCHRIST

425.274.4286

gilchrist@broderickgroup.com



The information contained herein has been given to us by the owner or sources that we deem reliable. We have no reason to doubt its accuracy, but we do not guarantee it. Prospective tenants should carefully verify all information contained herein.