



FOR LEASE

1-90

LAKE PLACE

2005 NW SAMMAMISH ROAD • ISSAQUAH, WA 98027

CBRE

FIRST FLOOR ±39,125 RSF

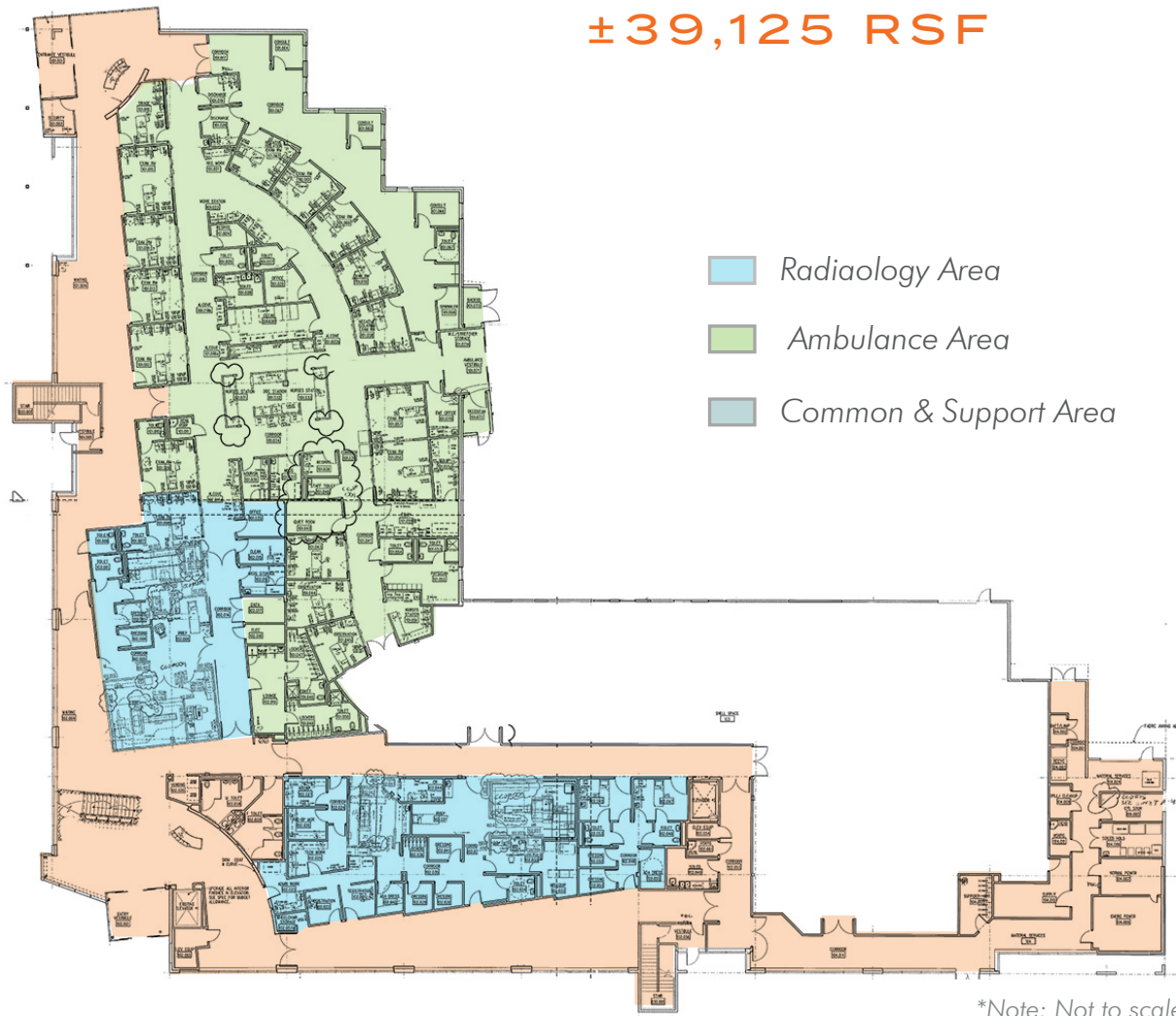

PROPERTY HIGHLIGHTS

• Space Available

±55,225 SF, Medical/Office/Lab space available

• Premier Class A Medical/Office/Lab

Former Issaquah (I-90) Swedish Medical Center. Class A improvements throughout. Dramatic two-story atrium lobby entry.

Free-standing medical/office/lab including:

- Emergency care
- Imaging Center
- Clinic Space
- Lab and clinical lab

• High Visibility | Signage

- Highway visibility from I-90.
- Prominent I-90 frontage and marquee building signage available.

• Area Amenities

Close proximity to multiple retail and service amenities

SECOND FLOOR ±16,100 RSF

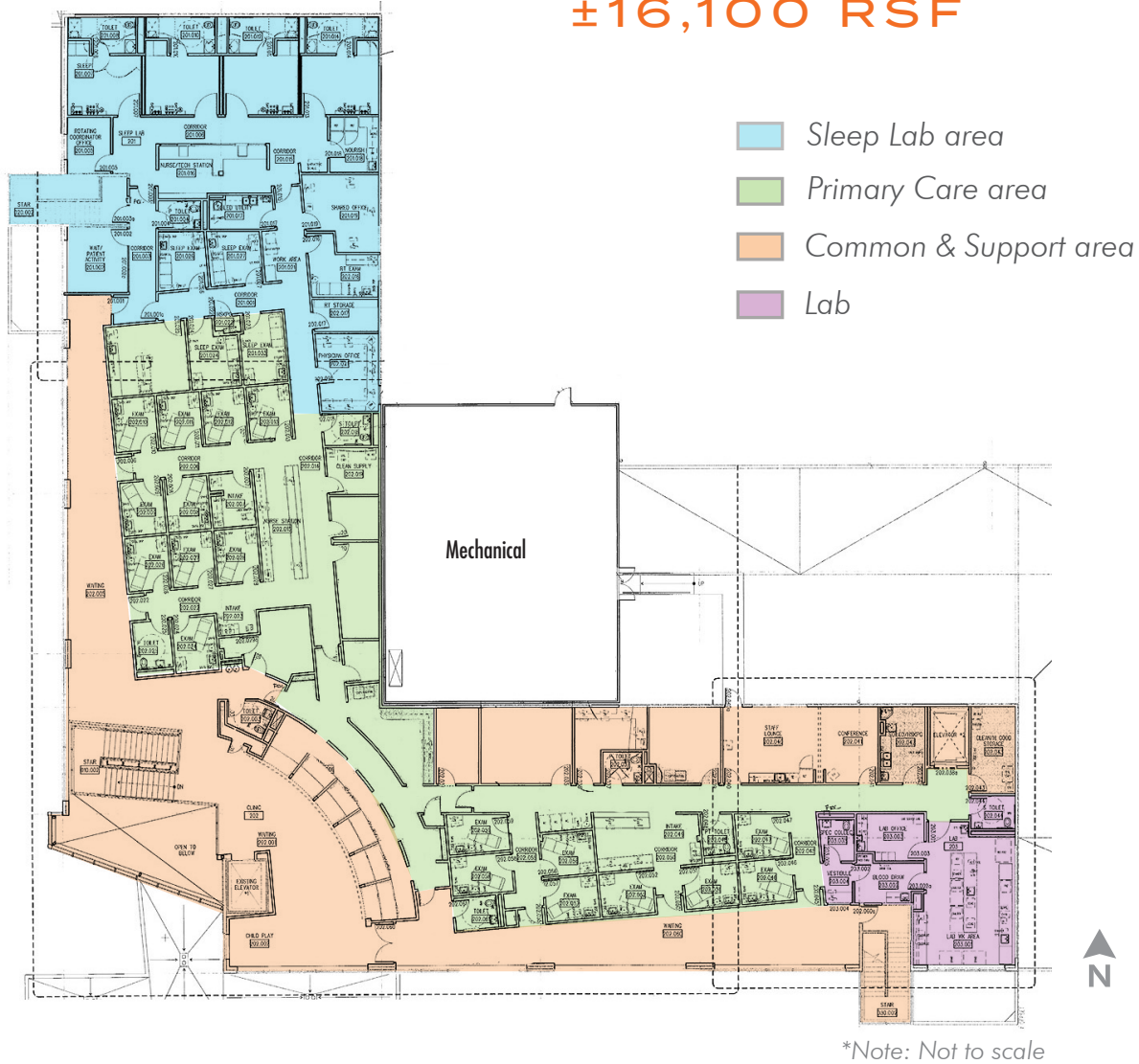

BUILDING "B" SUMMARY	
ADDRESS	2005 NW Sammamish Road, Building B Issaquah, Washington
BUILDING SIZE/RSF	Total: ±55,225 First Floor: ±39,125 Second Floor: ±16,100
USE	Currently medical
PARKING	102 striped surface stalls with additional parking available nearby
ELECTRICITY	2000 amps, 277/480v, 3 phase
FIRE SAFETY	State-of-the-art system, fully sprinklered
EXISTING BUILD OUT	<p>First Floor: Freestanding, emergency department with exam rooms, outpatient imaging center, radiology, staff/support offices, public area and shell space.</p> <p>Second Floor: Outpatient clinic space, sleep lab, clinical lab, primary care, and public and staff areas.</p>

FOR LEASE

I-90 LAKE PLACE

2005 NW SAMMAMISH ROAD • ISSAQUAH, WA 98027



- LOCAL AMENITIES**
1. MOTEL 6
 2. HOLIDAY INN SEATTLE-ISSAQUAH
 3. PCC NATURAL MARKETS
 4. OFFICE DEPOT
 5. COSTCO
 6. LOWE'S HOME IMPROVEMENT
 7. RED ROBIN
 8. HILTON GARDEN INN SEATTLE/ISSAQUAH
 9. ENTERPRISE RENT-A-CAR
 10. QFC
 11. WELLS FARGO BANK
 12. CHASE BANK
 13. BANK OF AMERICA
 14. TRADER JOES
 15. WILD FIN AMERICAN GRILL
 16. CHIPOTLE MEXICAN GRILL
 17. TARGET

CONTACT US

SCOTT DAVIS
Executive Vice President
+1425 462 6912
scott.davis@cbre.com

TIM OWENS
Senior Vice President
+1 425 462 6913
tim.owens@cbre.com

CBRE, Inc.
929 108th Ave NE
Suite 700
Bellevue, WA 98004



© 2022 CBRE, Inc. All rights reserved. This information has been obtained from sources believed reliable, but has not been verified for accuracy or completeness. You should conduct a careful, independent investigation of the property and verify all information. Any reliance on this information is solely at your own risk. CBRE and the CBRE logo are service marks of CBRE, Inc. All other marks displayed on this document are the property of their respective owners, and the use of such logos does not imply any affiliation with or endorsement of CBRE. Photos herein are the property of their respective owners. Use of these images without the express written consent of the owner is prohibited.jg 1-7-22