

For Lease

# Retail Land

# NAI Black



## 57th Avenue & Palouse Hwy

Spokane, Washington 99223

### Property Description

Total Lot Size: 3.18 Acres

Space Available:

Proposed Space:

Building 1: 7,500 SF +/- LEASED

Building 2: 3,025 SF +/-

Building 3: 8,560 SF +/- (Retail)

Building 4: 4,500 SF +/- ("C" Store) LEASED

Building 5: 3,000 SF +/- (Quick Service Restaurant)

Great location on a busy intersection on the South Hill.

Traffic Count: 57th Avenue - 7,692 ADT

Palouse Hwy - 5,583 ADT

### Lease Rate:

Contact Listing Agent For  
More Information

### OFFERING SUMMARY

Available SF	3,000 - 8,560 SF
Lot Size	3.18 Acres

### DEMOGRAPHICS

Stats	Population	Avg. HH Income
1 Mile	8,577	\$89,758
3 Miles	43,255	\$96,759
5 Miles	102,347	\$89,359

For more information

**Dave Black, SIOR CCIM**

O: 509 622 3535

dblack@naiblack.com

No warranty or representation, expression or implied, is made as to the accuracy of the information contained herein, and the same is submitted subject to errors, omissions, change or price, rental or other conditions, prior to sale, lease, financing, or withdrawal without notice, and of special listing conditions imposed by our principals no warranties or representations are made as to the condition of the property or any hazards contained therein or any to be implied.

801 W. Riverside Avenue, Suite 300  
Spokane, WA 99201  
509 623 1000 tel  
[naiblack.com](http://naiblack.com)

For Lease

# Retail Land

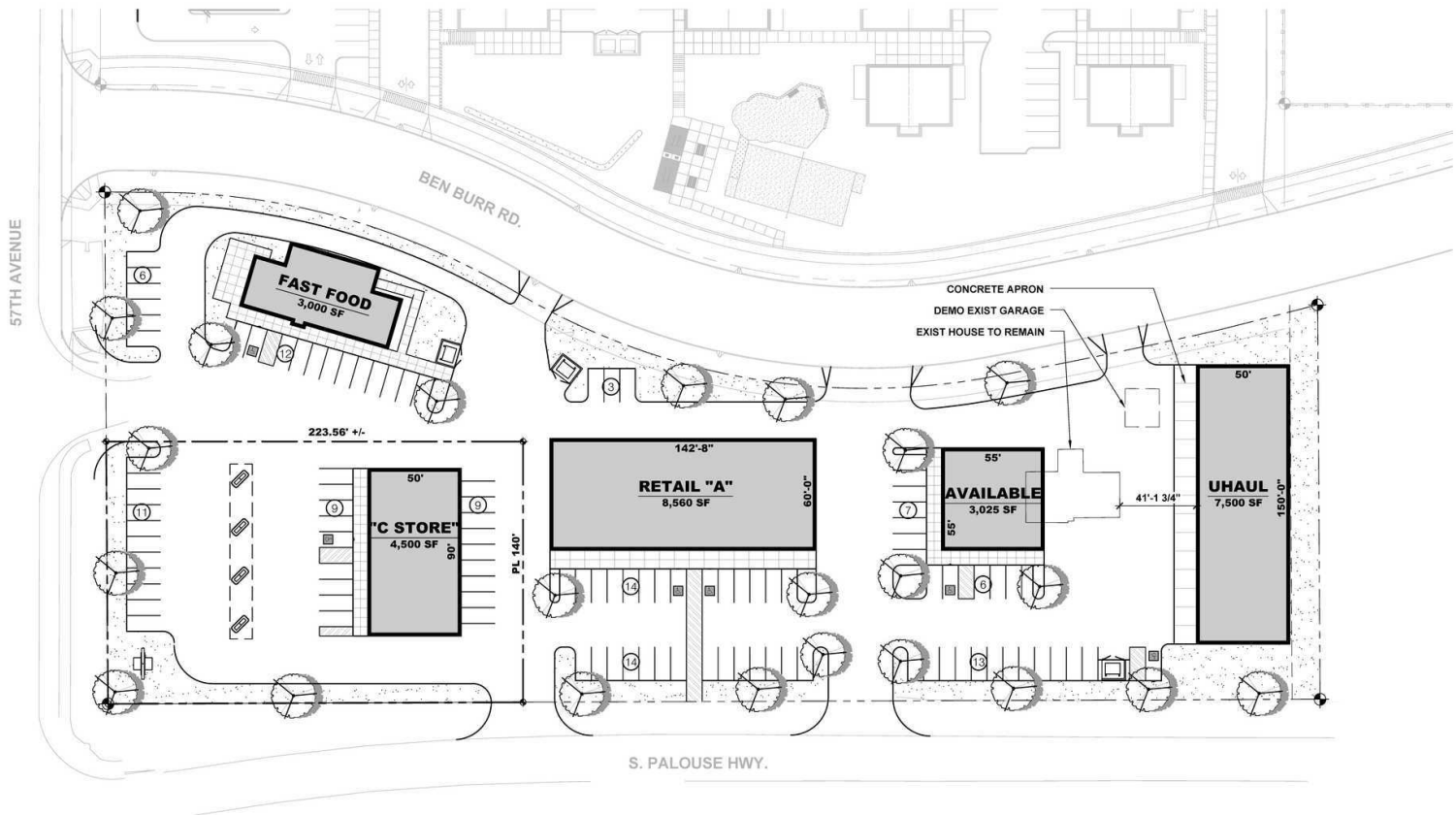

**PRELIMINARY SITE PLAN**  
57TH & PALOUSE - 01.23.19



**MAP** **MERCER**  
**ARCHITECTURE**  
& **PLANNING**  
1950 N. BROADWAY RD., #101  
SPokane Valley, WA 99212

NAI Black respects the intellectual property rights of others. If you believe that your intellectual property rights have been violated by NAI Black or by a third party who has uploaded Content on our Site, please provide the following information to the NAI Black designated copyright agent as addressed below: a. A description of the copyrighted work or other intellectual property that you claim has been infringed; b. A specific description of where the material that you claim is infringing is located on the Site so the agent is able to locate it; c. An address, telephone number, and e-mail address where NAI Black can contact you and, if different, an e-mail address where the alleged infringing party, if not NAI Black, can contact you; d. A signed statement that you have a good-faith belief that the material use is not authorized by the copyright owner or other intellectual property rights owner, by its agent, or by law; e. A signed statement by you under penalty of perjury that the information in your notice is accurate and that you are the copyright or intellectual property owner or are authorized to act on the owner's behalf. After reviewing the complaint and determining if the complaint is valid, NAI Black will work to quickly remove the infringing material or disable access to it. Note: There are substantial penalties for false claims. NAI Black may request additional information before removing any infringing material. NAI Black may provide the alleged infringing party with your e-mail address so that that person can respond to your allegations. NAI Black has registered a designated agent with the Copyright Office pursuant to 17 U.S.C. 512(c). If you believe your copyright material is being used on this Site without permission, please notify the designated agent as follows:  
By e-mail: [mary@commercialnls.com](mailto:mary@commercialnls.com) | Subject Line: Copyright Concern  
By mail: Commercial Brokers Association Attn: DMCA Designated Agent | 12131 113th Ave NE Suite 101 | Kirkland, WA 98034

If e-mailing your copyright infringement notice, then NAI Black must receive the signed statement(s) mentioned above by mail, or attached to the e-mail, before we are required to take action.