



FOR LEASE

Lacey Corporate Center

5215 CORPORATE CENTER COURT SE, LACEY, WA



Suite 5215C | 1,903 SF available

STREET FRONTAGE signage

BRAND NEW space in Lacey Corporate Center on prominent corner

LANDLORD OFFERING full building standard tenant improvement package

LOCAL TENANTS INCLUDE Flagstar Bank, Peterson and Carmack Cosmetic Dentistry, Lacey Physical Therapy, RE/MAX

AMPLE parking

LEASE RATE \$18.00, NNN

NNN estimated at \$7.00 PSF

EVAN PARKER

360.705.0174

evan.parker@kidder.com

AMY EVANS

360.705.1377

amy.evans@kidder.com

KIDDER.COM

This information supplied herein is from sources we deem reliable. It is provided without any representation, warranty, or guarantee, expressed or implied as to its accuracy. Prospective Buyer or Tenant should conduct an independent investigation and verification of all matters deemed to be material, including, but not limited to, statements of income and expenses. Consult your attorney, accountant, or other professional advisor.

**Kidder
Mathews**

FOR LEASE

5215 Corporate Center Court SE

LACEY, WA

Suite 5125C | 1,903 SF

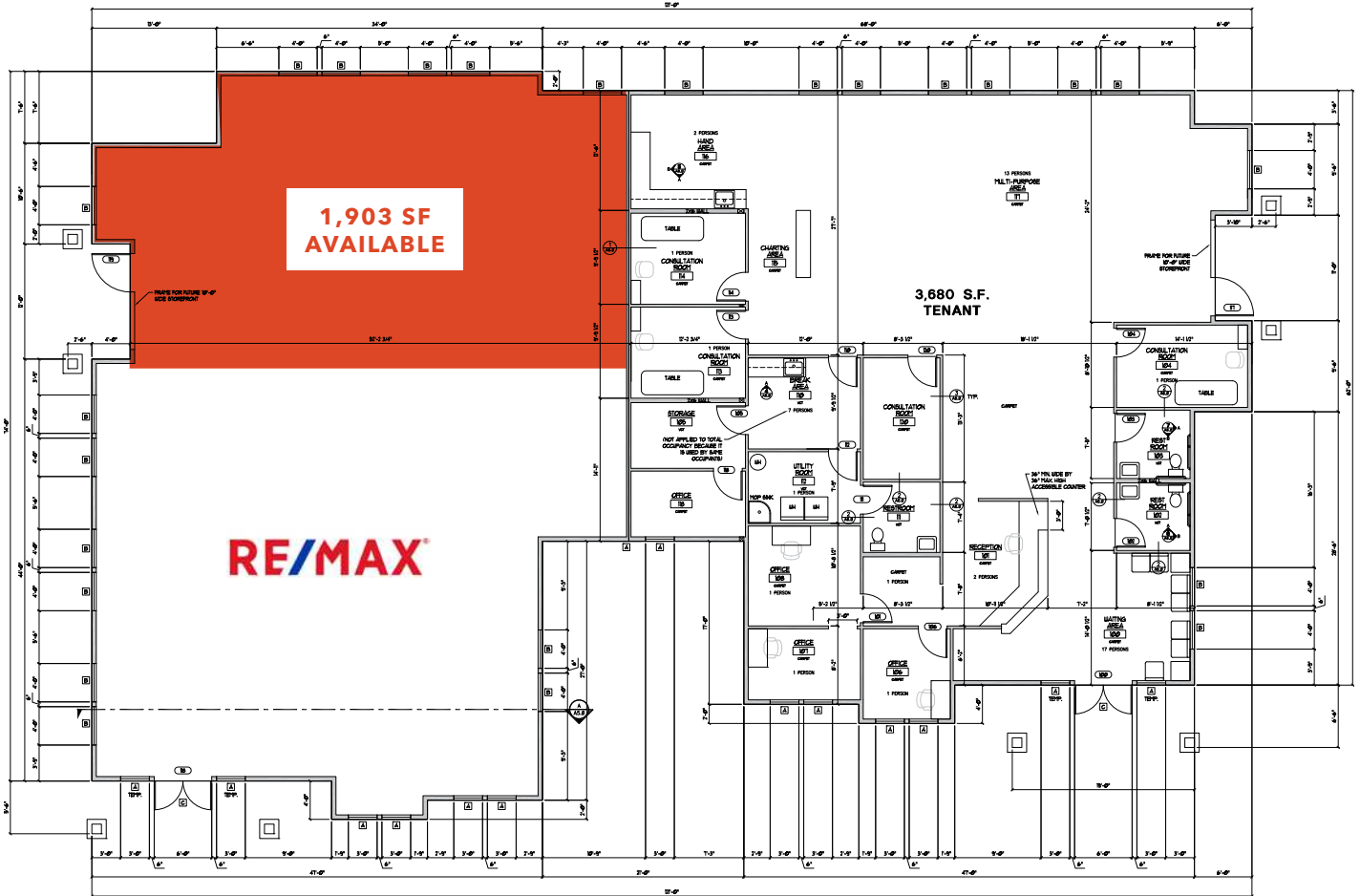

EVAN PARKER
360.705.0174
evan.parker@kidder.com

AMY EVANS
360.705.1377
amy.evans@kidder.com

KIDDER.COM

This information supplied herein is from sources we deem reliable. It is provided without any representation, warranty, or guarantee, expressed or implied as to its accuracy. Prospective Buyer or Tenant should conduct an independent investigation and verification of all matters deemed to be material, including, but not limited to, statements of income and expenses. Consult your attorney, accountant, or other professional advisor.

