

FOR LEASE

WOODINVILLE WEST

16932

WOODINVILLE-REDMOND ROAD NE

Woodinville, Washington 98072



PROPERTY FEATURES

- + Office: \$15.00/RSF, NNN
- + Warehouse: \$7.80/RSF, NNN
- + Operating Expenses: \$5.40/RSF/Year (includes electricity & gas)
- + Parking 3.0/1,000 RSF
- + Located in Woodinville proper next to downtown amenities
- + Great freeway accessibility to I-405 and SR-522
- + Abundant natural light with river views from every office
- + On-site deli and property management



CONTACT US

TIM OWENS

First Vice President
+1 425 462 6913
tim.owens@cbre.com

SCOTT BARBER

Senior Associate
+1 425 462 6913
scott.barber@cbre.com

CBRE, Inc.

10885 NE 4th Street
Suite 500
Bellevue, Washington 98004

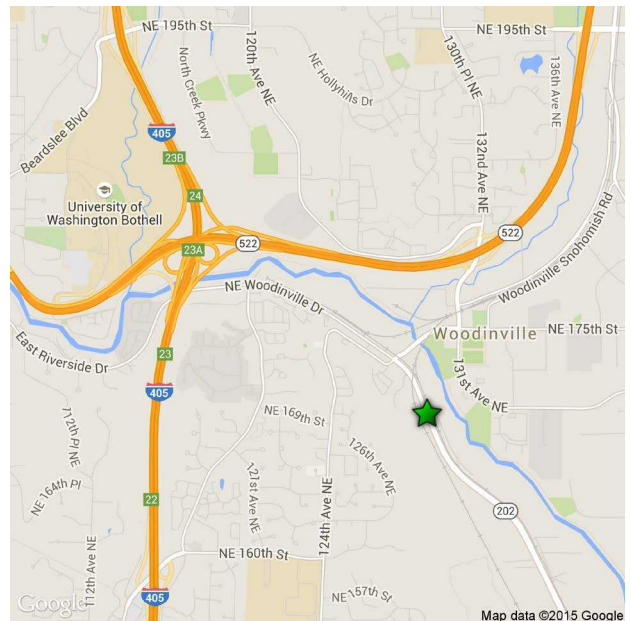

www.cbre.com/bellevue

CBRE

FOR LEASE WOODINVILLE WEST

16932
WOODINVILLE-REDMOND ROAD NE
Woodinville, WA 98072

AVAILABLE SPACES

| BUILDING/SUITE | TOTAL SIZE (±RSF) | OFFICE/ WAREHOUSE (±RSF) | FLOOR | LOADING DOORS | AVAILABILITY |
|----------------|----------------------|--------------------------------|-------|------------------|---------------|
| A - 205 | 671 | 671/0 | 2nd | None | Available Now |



BUILDING A SUITE 205

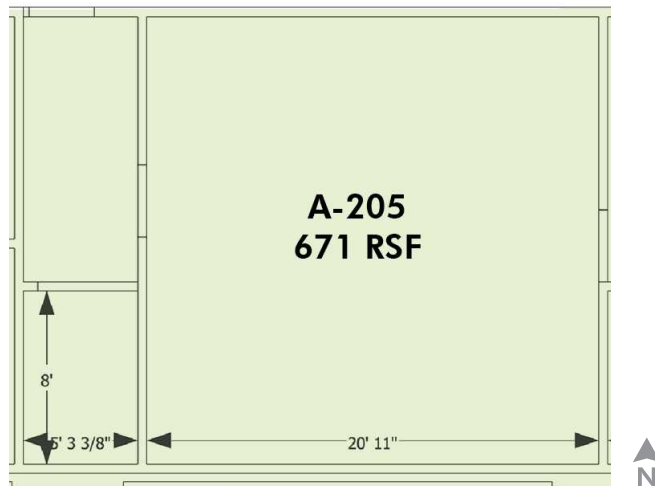

Not to scale

© 2016 CBRE, Inc. This information has been obtained from sources believed reliable. We have not verified it and make no guarantee, warranty or representation about it. Any projections, opinions, assumptions or estimates used are for example only and do not represent the current or future performance of the property. You and your advisors should conduct a careful, independent investigation of the property to determine to your satisfaction the suitability of the property for your needs. CBRE and the CBRE logo are service marks of CBRE, Inc. and/or its affiliated or related companies in the United States and other countries. All other marks displayed on this document are the property of their respective owners. Photos herein are the property of their respective owners and use of these images without the express written content of the owner is prohibited. TL 9-26-16