

Valley Avenue Business Park

914 Valley Avenue NW
Building 3, Suite 105
Puyallup, WA

97,873 SF total

4,344 SF office

Potentially divisible

30' clear height

18 dock doors

3 grade-level doors

ESFR sprinklers

Immediate access to SR-167 via
Valley Avenue

Available August 1, 2017

Lease term through
August 31, 2021

\$0.475/\$0.85 plus NNN

\$0.1825, NNN



Location



Contact

Thad Mallory, SIOR

206.248.7338

tmallory@kiddermathews.com

Travis Stanaway

206.248.6526

traviss@kiddermathews.com

Valley Avenue Business Park

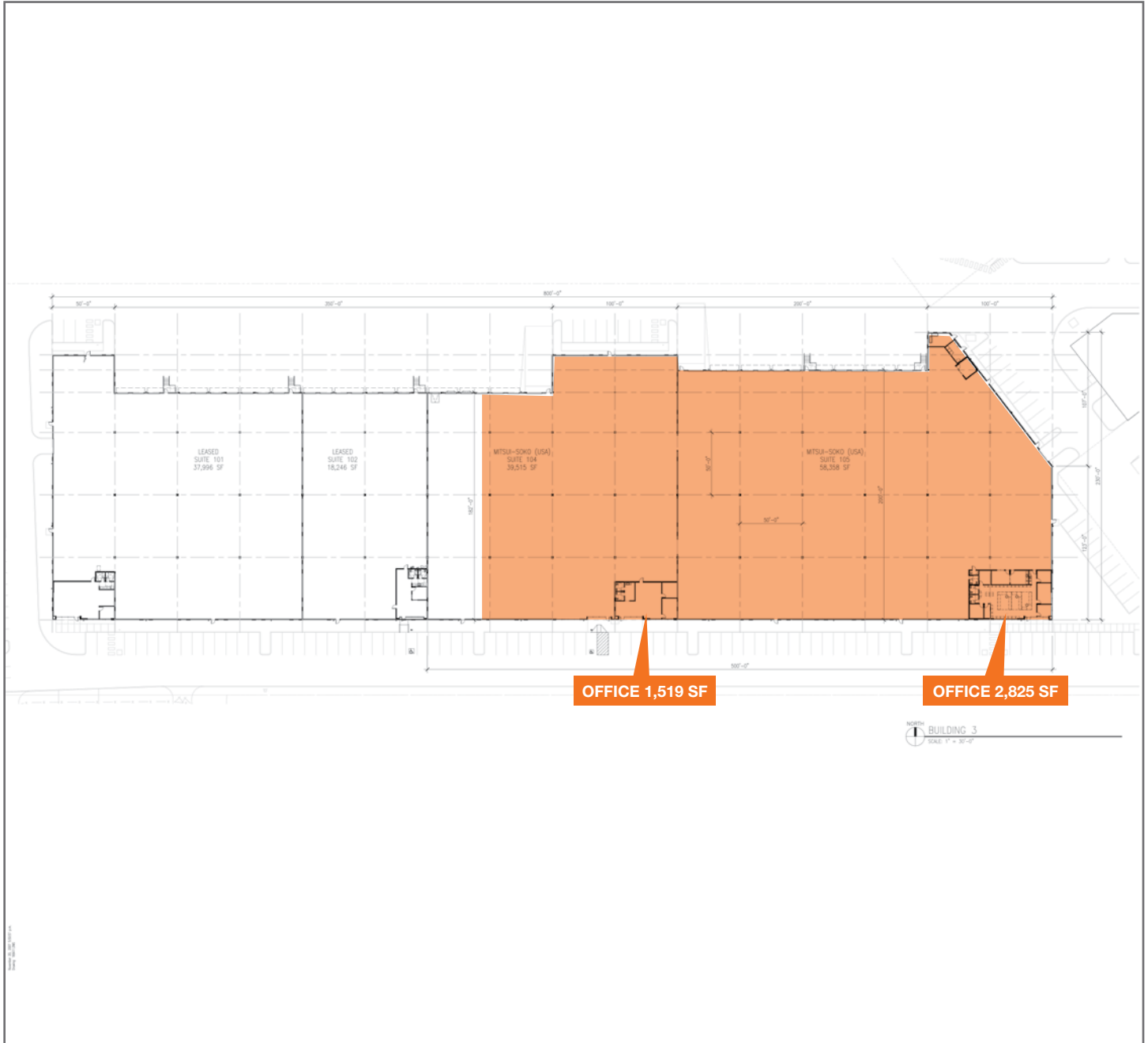

Contact

Thad Mallory, SIOR
206.248.7338
tmallory@kiddermathews.com

Travis Stanaway
206.248.6526
traviss@kiddermathews.com