

ENERGIZED LOBBY

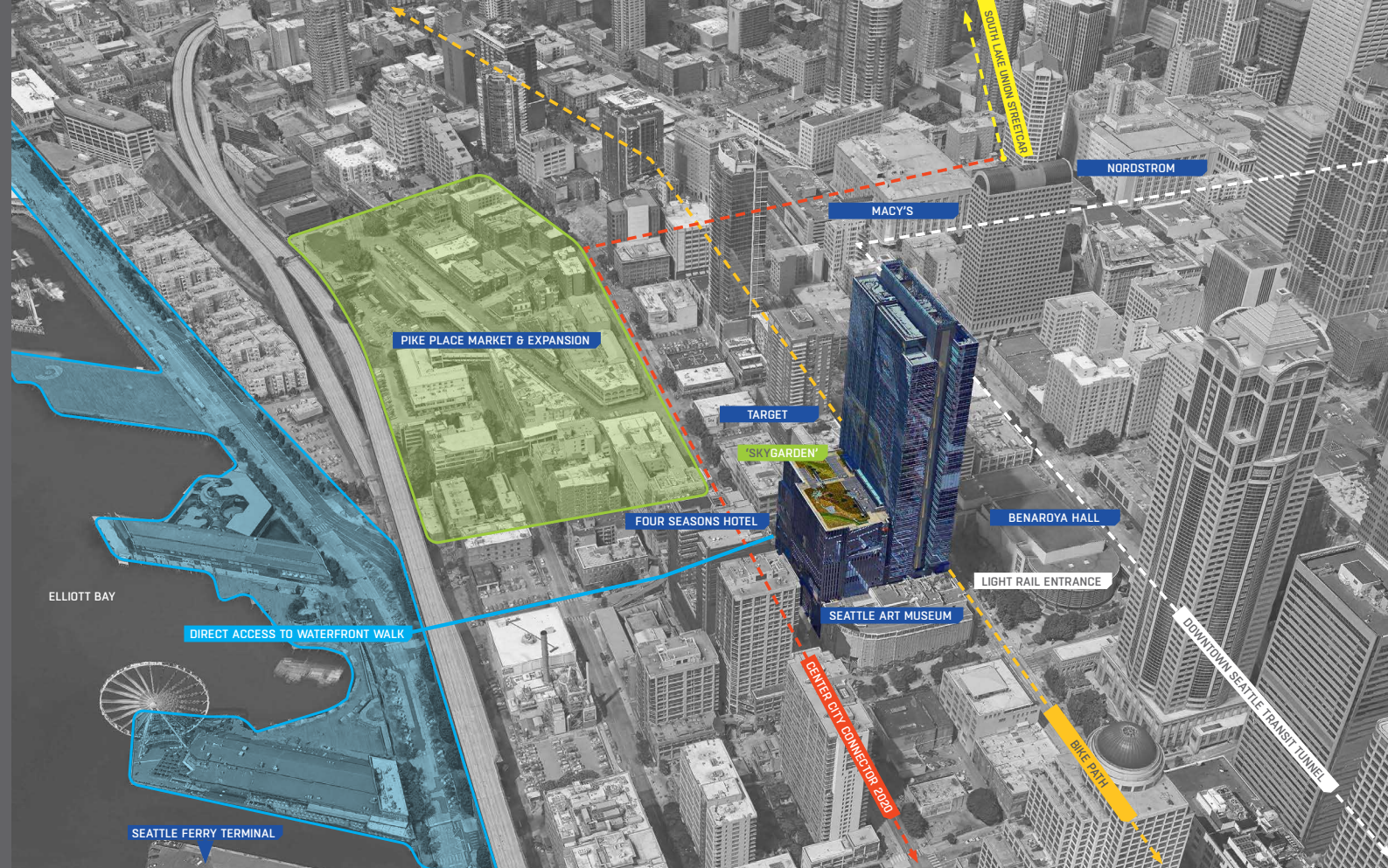
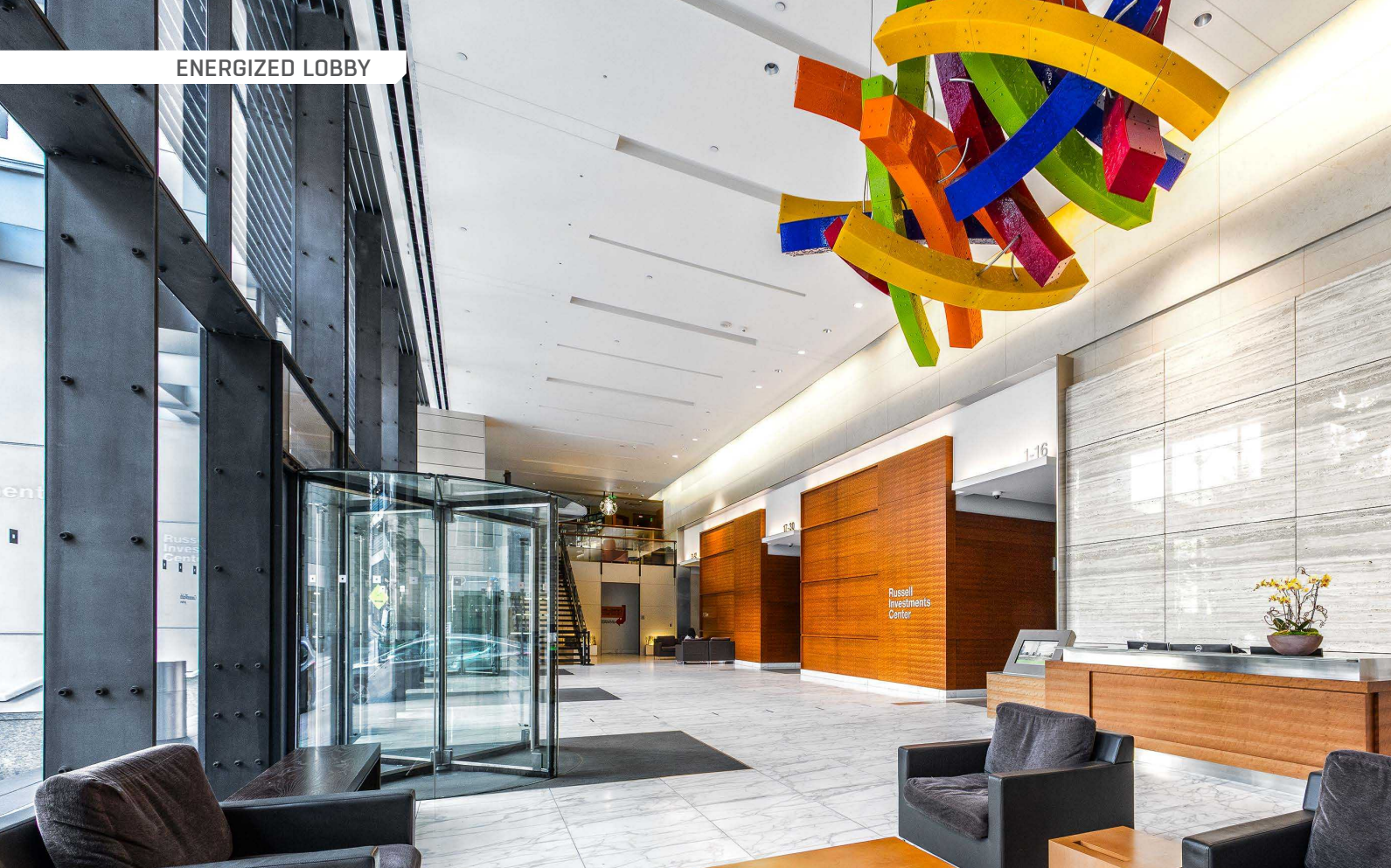

RUSSELL INVESTMENTS CENTER
SEATTLE'S ELEVATED WORKPLACE

SEE MORE AT...

WWW.RUSSELLINVESTMENTSCENTER.COM

CREATIVE TENANT SPACE



TO LEARN MORE OR
SCHEDULE A TOUR, CONTACT:

GREG INGLIN | 206 292 6128 | greg.inglin@cbre.com

LAURA FORD | 206 292 6120 | laura.ford@cbre.com

CBRE

www.russellinvestmentscenter.com

CommonWealth
partners

© 2022 CBRE, Inc. All rights reserved. This information has been obtained from sources believed reliable, but has not been verified for accuracy or completeness. You should conduct a careful, independent investigation of the property and verify all information. Any reliance on this information is solely at your own risk. CBRE and the CBRE logo are service marks of CBRE, Inc. All other marks displayed on this document are the property of their respective owners, and the use of such logos does not imply any affiliation with or endorsement of CBRE. Photos herein are the property of their respective owners. Use of these images without the express written consent of the owner is prohibited.

1301 Second Avenue | Seattle, WA 98101



UNPARALLELED VIEWS OF THE WATERFRONT AND SEATTLE SKYLINE
MAXIMIZED NATURAL LIGHT
10,000 SF TENANT LOUNGE WITH 4 CONFERENCE ROOMS
23,000 SF LANDSCAPED 'SKYGARDEN' ROOFTOP DECK
STATE-OF-THE-ART FITNESS CENTER
QUICK ACCESS TO MASS TRANSIT
ELECTRIC CAR CHARGERS & SECURE BIKE STORAGE
AWARD WINNING ARCHITECTURE
IN THE HEART OF THRIVING DOWNTOWN SEATTLE
LEED PLATINUM

Inspiration is an undervalued asset. And while it can be found in a number of sources - the workplace, where you spend a large part of your life - should be one of those sources. Russell Investments Center is just that; an 'Inspiration Engine'. A dynamic environment both inside and out, where inspiration begets motivation, driving efficiency and innovation. A place as attractive to millennial talent as it is to senior leadership. Reinforcing all of this is the 17th floor 'SKYGARDEN' - a 23,000 SF landscaped rooftop deck and 10,000 SF exclusive indoor tenant space. Combined, this elevated experience offers tranquility, interaction and inspiration.

AND STEPS AWAY FROM RUSSELL INVESTMENTS CENTER'S PREMIER DOWNTOWN LOCATION IS A VARIETY OF LEISURE AND CULTURAL ATTRACTIONS...

- Take in nature with direct access to the walkable Seattle Waterfront.
- Explore history and the local retail scene at Pike Place Market.
- Entertain clients at the Four Seasons Hotel next door.
- Be moved by the on-site Seattle Art Museum & Symphony.
- Mix things up at lunch or dinner with Downtown Seattle's burgeoning food scene.

ALL WITHIN A TWO BLOCK RADIUS OF RUSSELL INVESTMENTS CENTER

MORE THAN AN OFFICE BUILDING...AN INSPIRATION ENGINE



THE
SKYGARDEN
ON THE 17TH FLOOR

ENGAGE. UNWIND. EXPLORE.