

HENDERSON BAY

FOR SALE

\$3,000,000

12800 Goodnough Drive NW
Gig Harbor, WA

23,557 CPD - PURDY DR NW

GOODNOUGH DR NW

48,000 CPD - HWY 16



GIG HARBOR LAND

Lisa Tallman

First Western Properties—Tacoma Inc. | 253.472.0404
6402 Tacoma Mall Blvd, Tacoma, WA 98409 | fwp-inc.com

12800 GOODNOUGH DRIVE NW:

344,944 +/- SF (7.92 ACRES) \$3,000,000

- Excellent Zoning! B-2 City of Gig Harbor
- In incorporated City of Gig Harbor
- Close Access to Gig Harbor North and Downtown
- Excellent access to Highway 16

PARCEL NUMBERS:

- 0122255007
- 0122255008
- 0122255009
- 0122255010

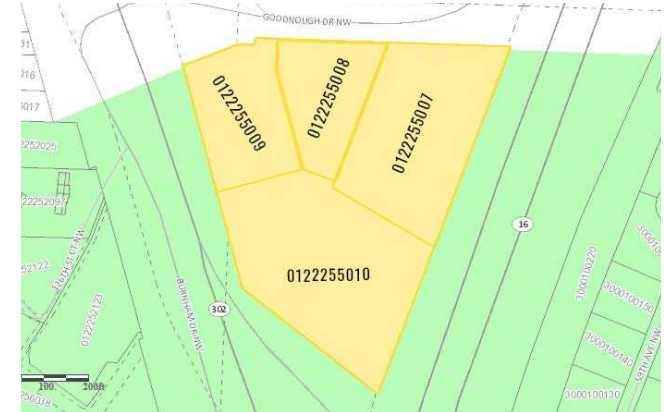

Population



Average HH Income

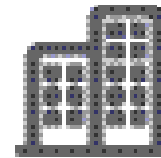

Daytime Population

Regis - 2023

	Population	Average HH Income	Daytime Population
Mile 1	2,840	\$172,070	2,791
Mile 3	23,674	\$137,244	16,361
Mile 5	46,370	\$135,396	30,580

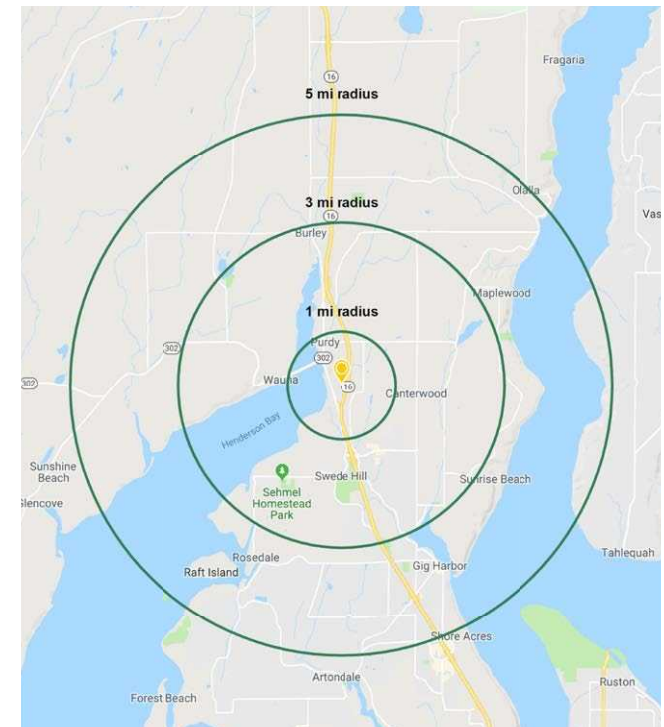

LOCATION DETAILS

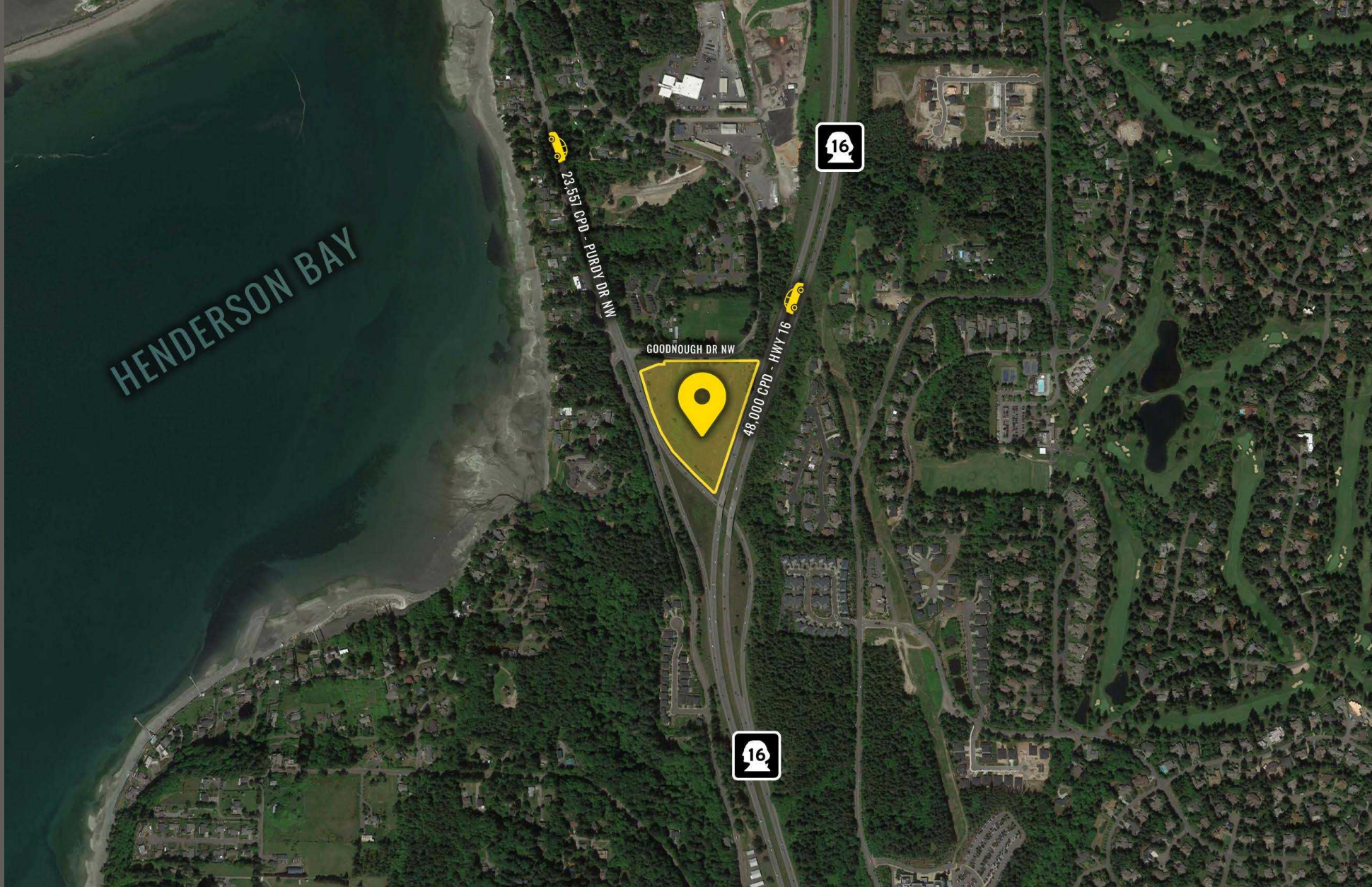

Easy access to
Highway 16



Located by the
Henderson Bay



48,000 CPD
Highway 16



23,557 CPD
Purdy Drive NW

CITY SUMMARY



GIG HARBOR, WA is both a bay on the Puget Sound and a harbor town that has been named one of the Smithsonian Magazines Top Five Small Towns for culture, heritage and charm. Its unique location, close to metropolitan centers, yet positioned on a quiet, beautiful and historic peninsula - provides visitors and residents with excellent site-seeing, history, culture, dining, shopping and more.

TACOMA | KIRKLAND | PORTLAND | SEATTLE



RELATIONSHIP FOCUSED. RESULTS DRIVEN.

LISA TALLMAN

253.471.5504

lisa@firstwesternproperties.com



First Western Properties—Tacoma Inc. | 253.472.0404
6402 Tacoma Mall Blvd, Tacoma, WA 98409 | fwp-inc.com

© First Western Properties, Inc. DISCLAIMER: The above information has been secured from sources believed to be reliable, however, no representations are made to its accuracy. Prospective tenants or buyers should consult their professional advisors and conduct their own independent investigation. Properties are subject to change in price and/or availability without notice.