

# FOR LEASE



## Great location in Maple Square

Lease Price: \$14.00 / SF / Modified Gross

*Landlord pays NNN's & utilities*

*Tenant pays janitorial*

Space Available: ± 16,456 SF

*Former Daycare: ± 7,520 SF*

*Office/Warehouse: ± 8,936 SF*

- Convenient access off of Maple and Ash
- 1328 N. Maple is partially divisible
- Open office areas, conference rooms and non-commercial kitchen
- Multiple offices, storage room overhead door
- Ideal for open office use in former daycare
- Free parking



KIEMLEHAGOOD.COM

## OFFICE SPACE

1313 - 1328 N Maple Street  
Spokane, WA 99201

View  
Location



**CRAIG SOEHREN, BROKER**

509.755.7548

craigs@kiemlehaood.com

**KIEMLE  
HAGOOD**

# Floor Plans

1313 - 1328 N Maple Street | Spokane, WA

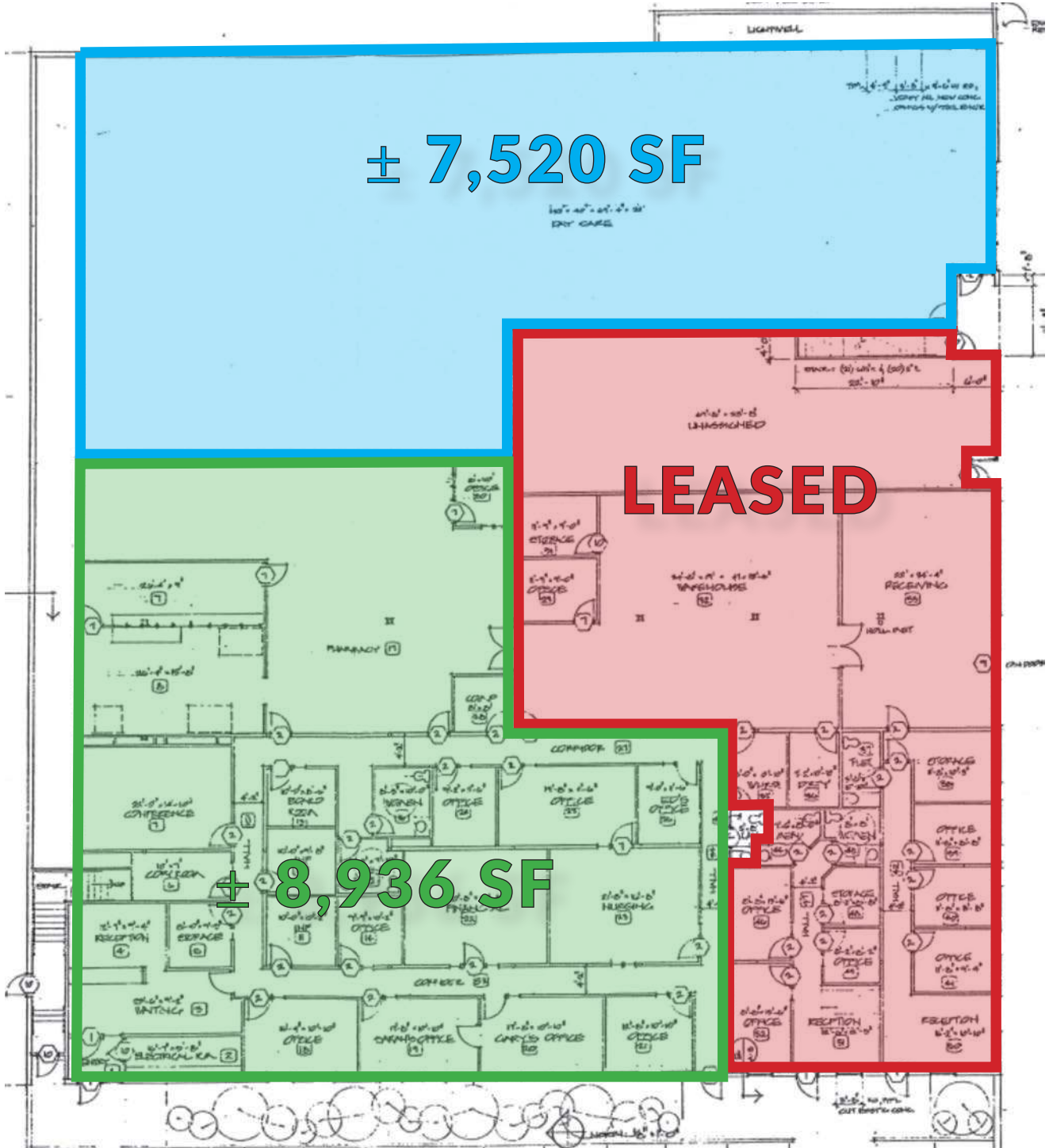



# OFFICE SPACE

1313 - 1328 N Maple Street  
Spokane, WA 99201

**CRAIG SOEHREN, BROKER**  
509.755.7548 [craigs@kiemlehgagood.com](mailto:craigs@kiemlehgagood.com)



601 WEST MAIN AVENUE, SUITE 400  
SPOKANE, WA 99201

**OFFICE LOCATIONS**  
SPOKANE | COEUR D'ALENE | TRI-CITIES | PALOUSE | MISSOULA

No warranty or representation, expressed or implied, is made by Kiemle Hagood, its agents or its employees as to the accuracy of the information contained herein. All information furnished is from sources deemed reliable and submitted subject to errors, omissions, change of terms and conditions, prior sale, lease or financing, or withdrawal without notice. No one should rely solely on the above information, but instead should conduct their own investigation to independently satisfy themselves.



Kiemle Hagood respects the intellectual property of others:  
If you believe the copyright in your work has been violated through this Website, please contact our office for notice of claims of copyright infringement. For your complaint to be valid under the Digital Millennium Copyright Act of 1998 (DMCA), you must provide the following information when providing notice of the claimed copyright infringement: Identify the material on the Website that you believe infringes your work, with enough detail so that we may locate it on the Website; provide your address, telephone number and email address; provide a statement that you have a good faith belief that the disputed use is not authorized by the copyright owner, its agent, or the law; provide a statement that the information in the notification is accurate, and under penalty of perjury, that the complaining party is authorized to act on behalf of the owner of an exclusive right that is allegedly infringed; and provide your physical or electronic signature. Upon receiving your complaint, Kiemle Hagood will, upon review, remove content that you believe infringes your copyright if the complaint is found to be valid.