

FOR LEASE

3001 Mile Hill Drive
Port Orchard, WA 98366



MILE HILL RETAIL

Lisa Tallman | Jamie Firth

First Western Properties—Tacoma Inc. | 253.472.0404
6402 Tacoma Mall Blvd, Tacoma, WA 98409 | fwp-inc.com



AVAILABLE

2,890 SF \$22.00 PSF PLUS \$10.00 EST NNN

1,400 SF \$22.00 PSF PLUS \$10.00 EST NNN

- Endcap with drive-thru
- Adjacent to Albertsons anchored shopping center
- Located on Port Orchard's busy Mile Hill Drive with over 17,000 vehicles passing by daily



| Regis - 2022 |  Population |  Average HH Income |  Daytime Population |
|--------------|--|---|--|
| Mile 1 | 7,761 | \$82,667 | 5,695 |
| Mile 3 | 51,569 | \$83,818 | 33,316 |
| Mile 5 | 102,837 | \$89,094 | 67,730 |

TENANTS

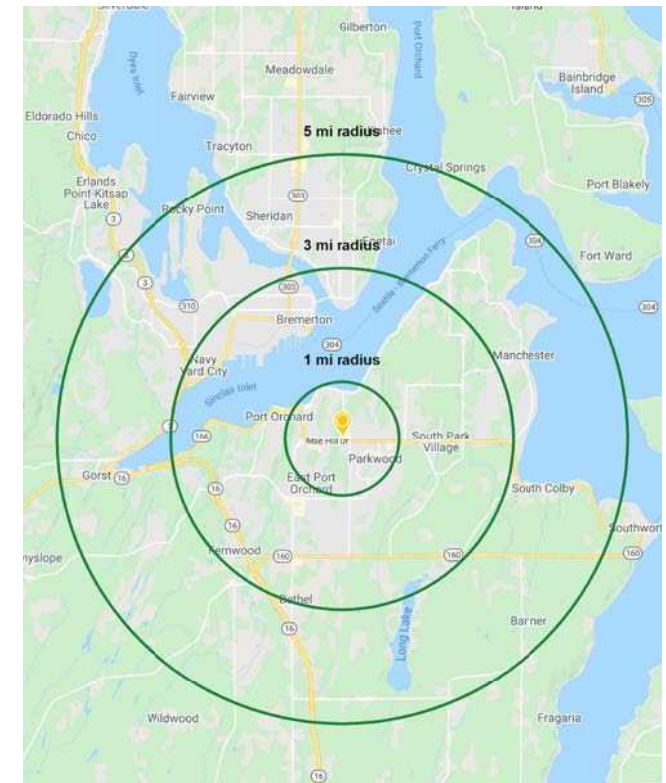

LOCATION DETAILS

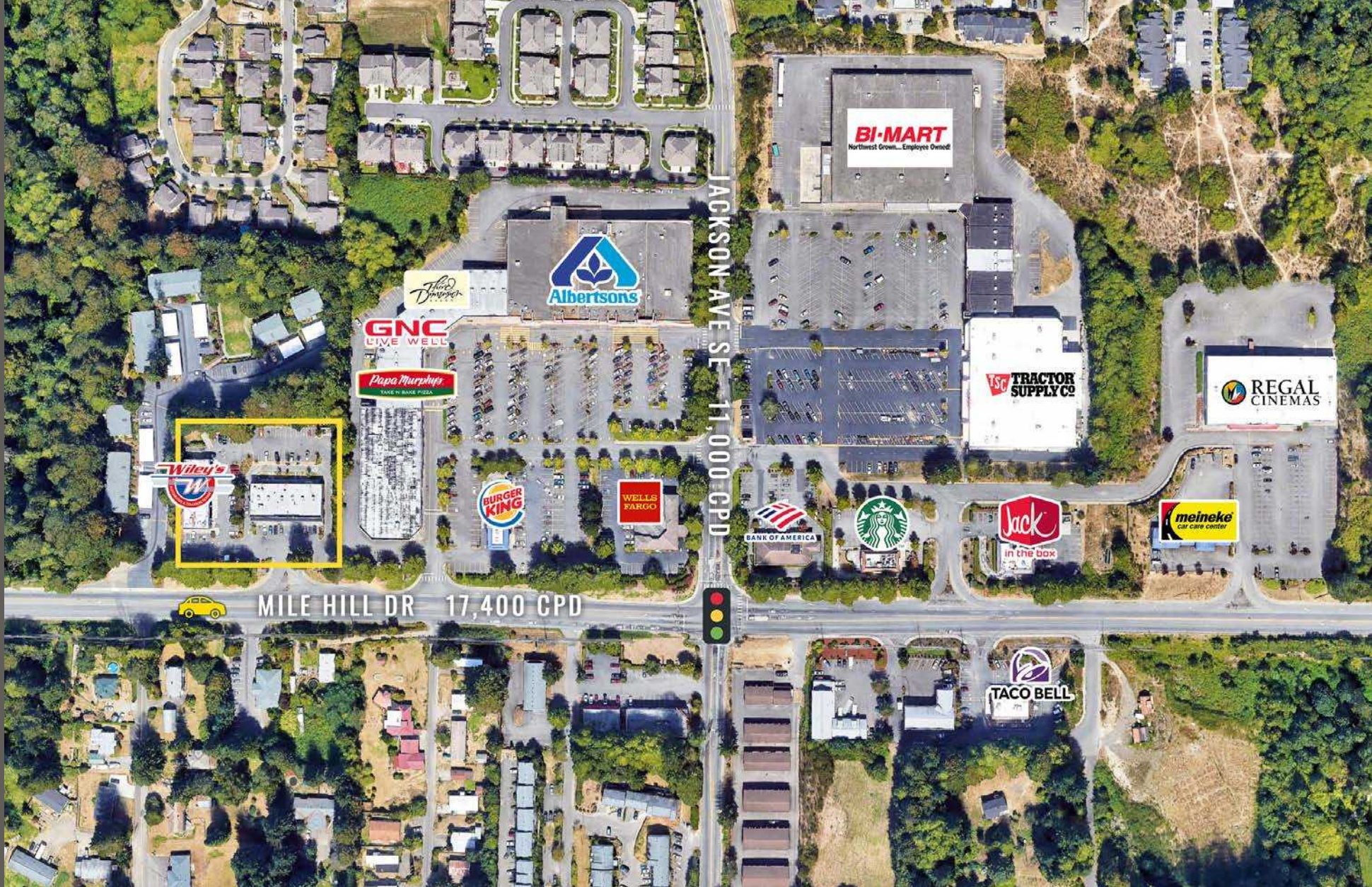

Located moments from HWY 16



Located in the Port Orchard Retail Core



17,400 CPD Mile Hill Drive



11,000 CPD Jackson Ave SE

LOCATION AERIAL

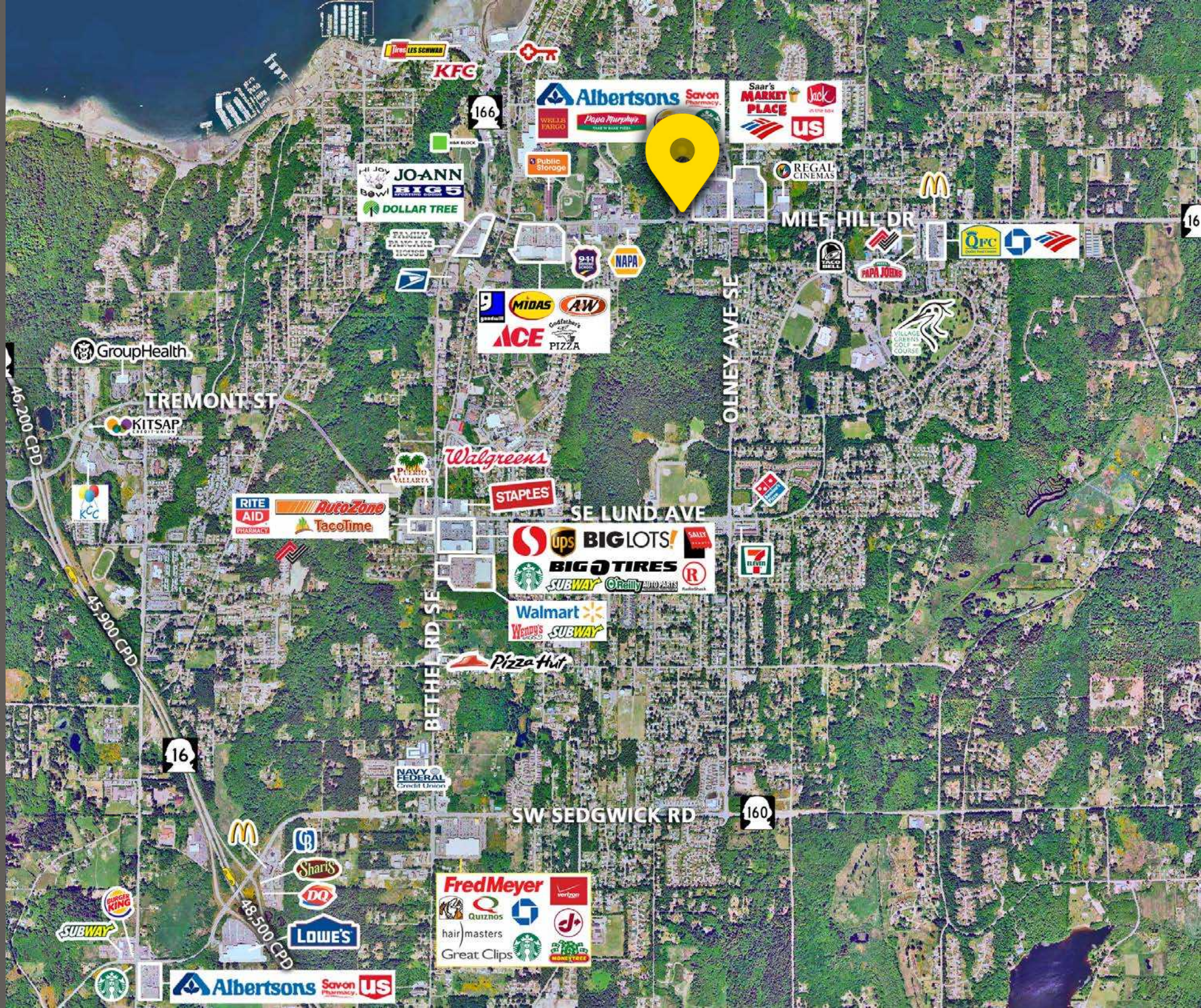

SITE PLAN

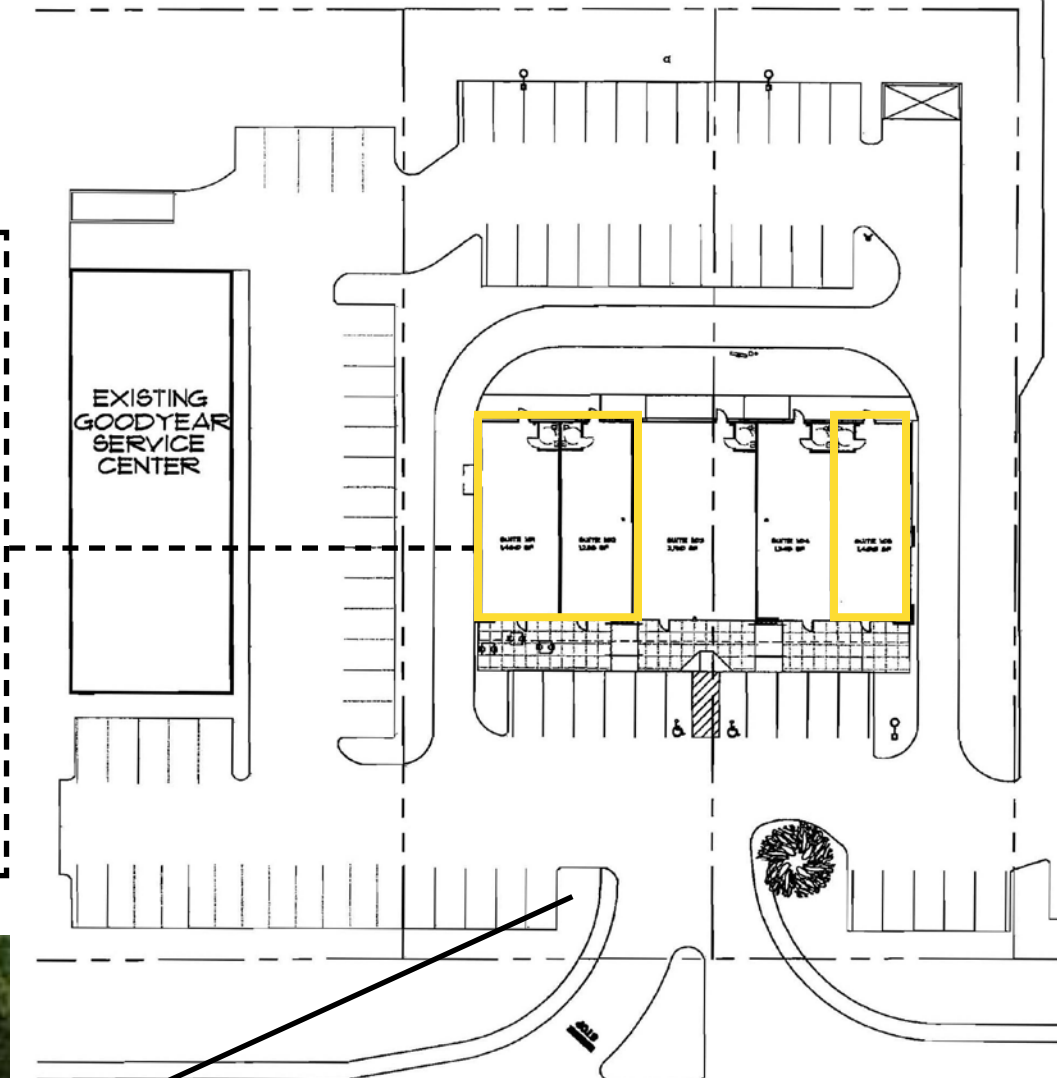
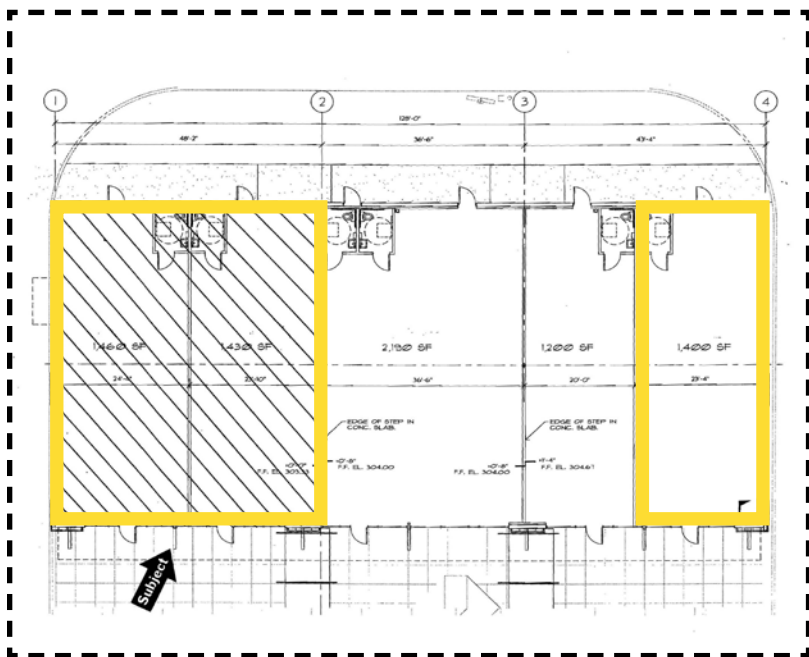

TACOMA | KIRKLAND | PORTLAND

RELATIONSHIP FOCUSED. RESULTS DRIVEN.

LISA TALLMAN

253.471.5504
lisa@firstwesternproperties.com

JAMIE FIRTH

253.284.3649
jamie@firstwesternproperties.com



First Western Properties—Tacoma Inc. | 253.472.0404
6402 Tacoma Mall Blvd, Tacoma, WA 98409 | fwp-inc.com

© First Western Properties, Inc. DISCLAIMER: The above information has been secured from sources believed to be reliable, however, no representations are made to its accuracy. Prospective tenants or buyers should consult their professional advisors and conduct their own independent investigation. Properties are subject to change in price and/or availability without notice.