

# Mariner Marketplace

12720 4th Ave W,  
Everett, WA 98204

Prime Retail Location



# Mariner Marketplace

12720 4th Ave. W | Everett, WA 98204



## Property Features

- Prime retail location
- Suite I: ±900 RSF
- Direct access to I-5
- Adjacent to planned Link Light Rail Stop and walking distance (1-2 minutes) to bus stops
- Local, responsive ownership
- Low market vacancy for similar size retail space
- Situated on high-traffic signalized intersection with a 21,370 car volume off 4th Ave. W and a 32,929 car volume off I-5 E and 128th St. W
- Asking rate: \$2,250/month, NNN

# Floor Plan

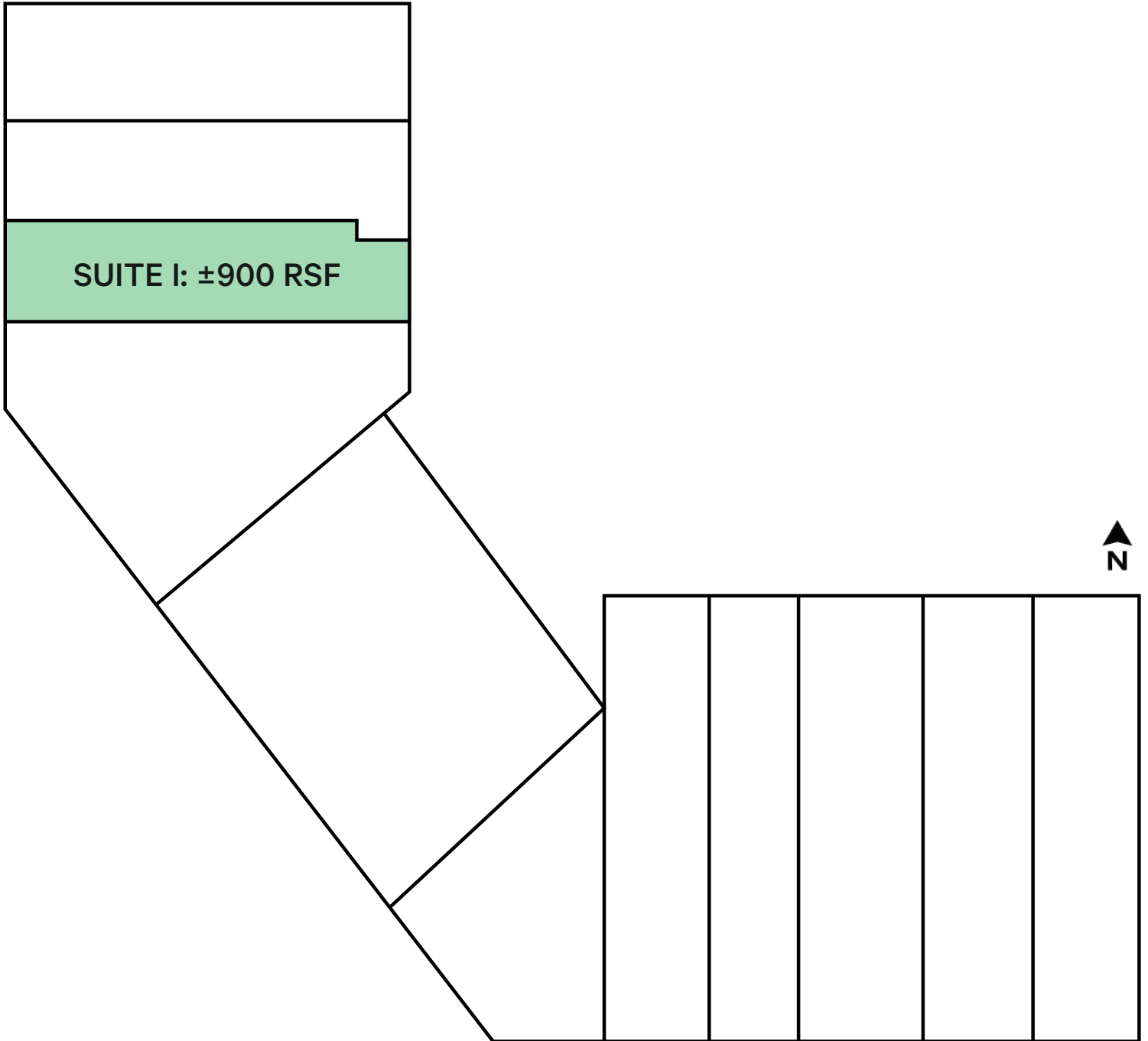

# Amenity Map

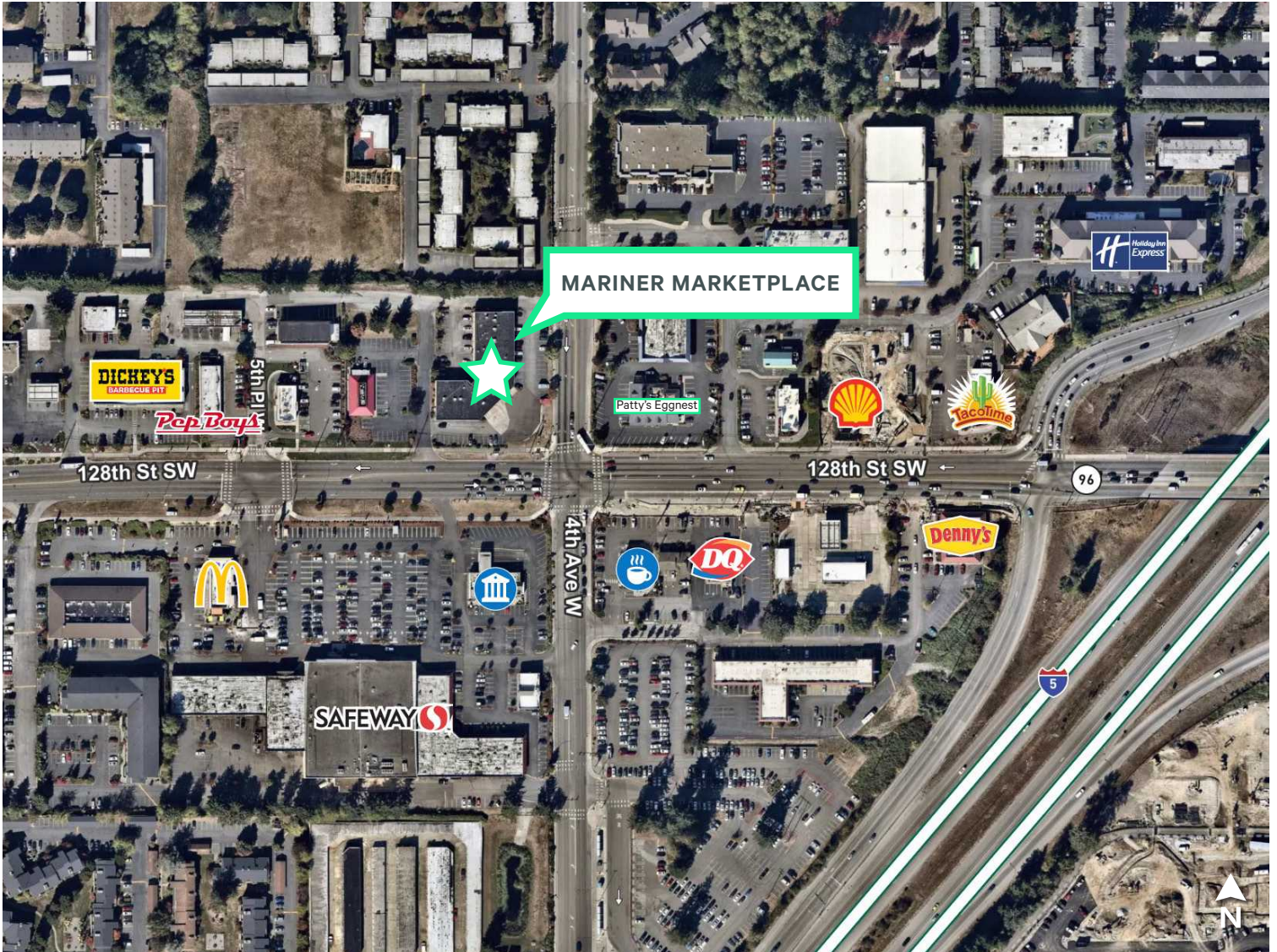

## Contact Us

**Erik Larson**

First Vice President  
+1 425 462 6954  
erik.larson@cbre.com

**Ric Brandt**

Senior Vice President  
+1 425 462 6901  
ric.brandt@cbre.com

**John Bauer**

Senior Vice President  
+1 425 462 6906  
john.bauer@cbre.com

**CBRE**

929 108th Avenue  
Suite 700  
Bellevue, WA. 98004

© 2023 CBRE, Inc. All rights reserved. This information has been obtained from sources believed reliable, but has not been verified for accuracy or completeness. You should conduct a careful, independent investigation of the property and verify all information. Any reliance on this information is solely at your own risk. CBRE and the CBRE logo are service marks of CBRE, Inc. All other marks displayed on this document are the property of their respective owners, and the use of such logos does not imply any affiliation with or endorsement of CBRE. Photos herein are the property of their respective owners. Use of these images without the express written consent of the owner is prohibited. KMN 7-7-23