



FOR LEASE

# 4047 Pacific Ave

LACEY, WA (SWC SLEATER-KINNEY & PACIFIC)



## Prime retail space in Lacey

**BRIAN ENGELKING**

253.722.1418

[brian.engelking@kidder.com](mailto:brian.engelking@kidder.com)

**Kidder  
Mathews**

This information supplied herein is from sources we deem reliable. It is provided without any representation, warranty, or guarantee, expressed or implied as to its accuracy. Prospective Buyer or Tenant should conduct an independent investigation and verification of all matters deemed to be material, including, but not limited to, statements of income and expenses. Consult your attorney, accountant, or other professional advisor.

**KIDDER.COM**

FOR LEASE

# 4047 Pacific Ave

LACEY, WA (SWC SLEATER-KINNEY & PACIFIC)



1,360-  
7,500

SQUARE FEET AVAILABLE

\$20-\$24

PLUS NNN

## New construction

**HIGH** traffic intersection

**EASY** 1-5 access

**APPROXIMATELY** 32,000 cars per day at intersection

**DIRECTLY** across the street from a new shopping center with national tenants Chipotle, Five Guys, MOD Pizza and 7 Eleven

### DEMOGRAPHICS

	1 Mile	3 Miles	5 Miles
Population	10,175	73,008	153,641
Median HH Income	\$54,646	\$73,931	\$76,339

KIDDER.COM

This information supplied herein is from sources we deem reliable. It is provided without any representation, warranty, or guarantee, expressed or implied as to its accuracy. Prospective Buyer or Tenant should conduct an independent investigation and verification of all matters deemed to be material, including, but not limited to, statements of income and expenses. Consult your attorney, accountant, or other professional advisor.

**km** Kidder Mathews

FOR LEASE

# 4047 Pacific Ave

LACEY, WA (SWC SLEATER-KINNEY & PACIFIC)

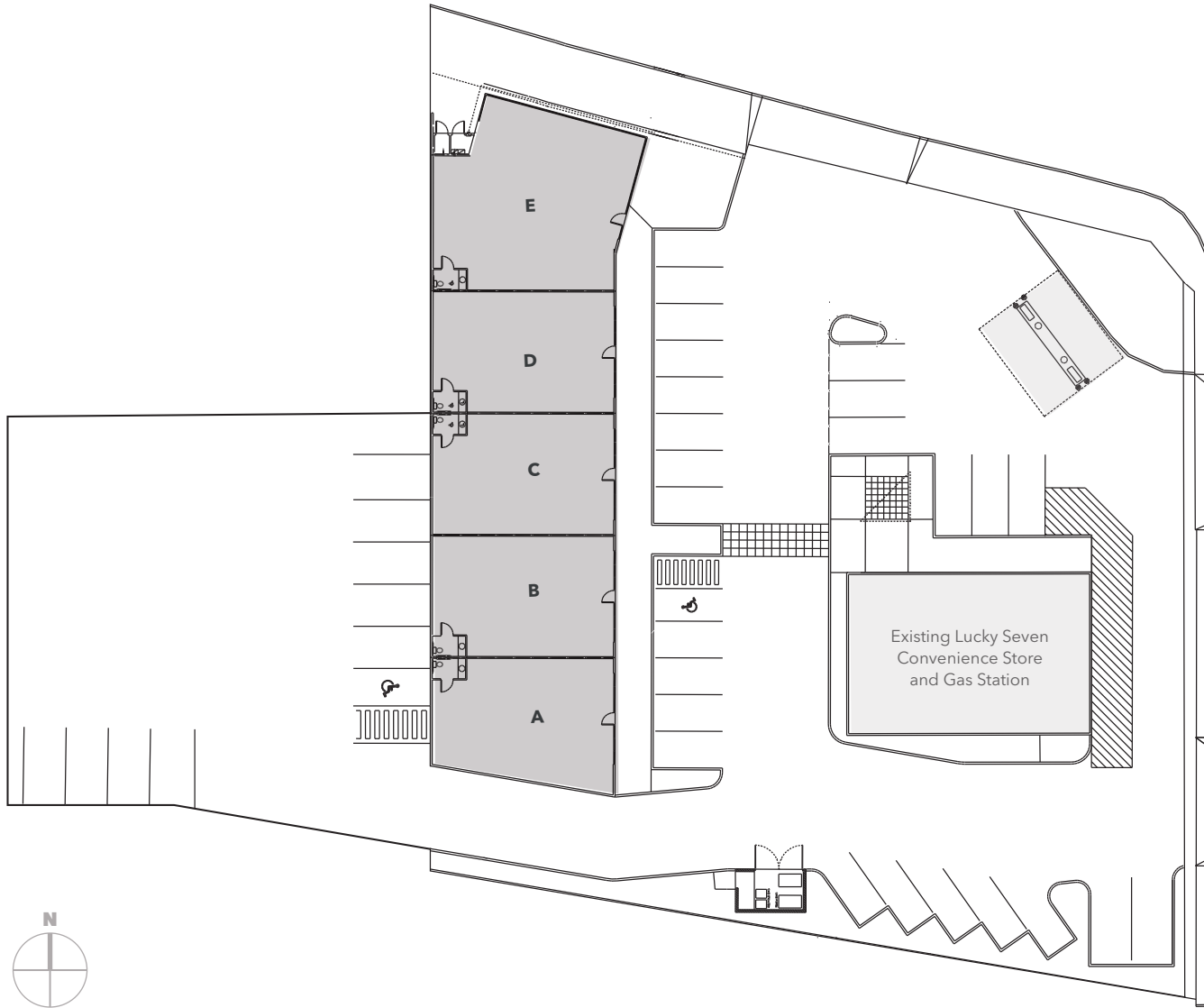

**BRIAN ENGELKING**  
253.722.1418  
brian.engelking@kidder.com

KIDDER.COM

This information supplied herein is from sources we deem reliable. It is provided without any representation, warranty, or guarantee, expressed or implied as to its accuracy. Prospective Buyer or Tenant should conduct an independent investigation and verification of all matters deemed to be material, including, but not limited to, statements of income and expenses. Consult your attorney, accountant, or other professional advisor.

**km** Kidder  
Mathews