

# FREMONT

## LAKE UNION CENTER

**Plaza Building:** 701 N 34th St | Seattle WA 98103

**2nd Floor: 31,840 SF Sublease**



**COLLIERS INTERNATIONAL**  
601 Union St, Suite 5300  
Seattle, WA, 98101  
[www.colliers.com](http://www.colliers.com)

**Connor McClain**  
Senior Vice President  
(425) 785-5660  
[connor.mcclain@colliers.com](mailto:connor.mcclain@colliers.com)

**Joe Conner**  
Associate  
(425) 698-7142  
[joe.conner@colliers.com](mailto:joe.conner@colliers.com)



**FREMONT**  
LAKE UNION CENTER  
Plaza Building

Fremont Bridge

# THE TRUE WORK- PLAY ADDRESS

- Expiration 6/30/2027
- Full 2nd Floor: 31,840 SF
- Furniture available
- 2.3/1,000 SF Parking
- On-site secure bike storage and locker rooms with showers
- Conveniently located near Hwy 99, with direct access to major bus routes
- Direct access to the 27-mile long Burke-Gilman Trail, connecting cyclists from North Puget Sound to the Ballard and Fremont neighborhoods

Burke-Gilman Trail



High-end Kitchen



High Ceilings

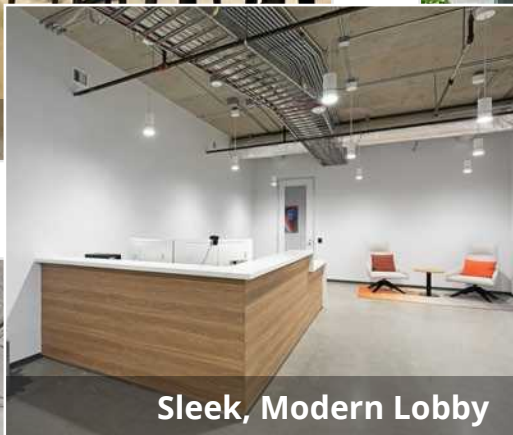

Sleek, Modern Lobby

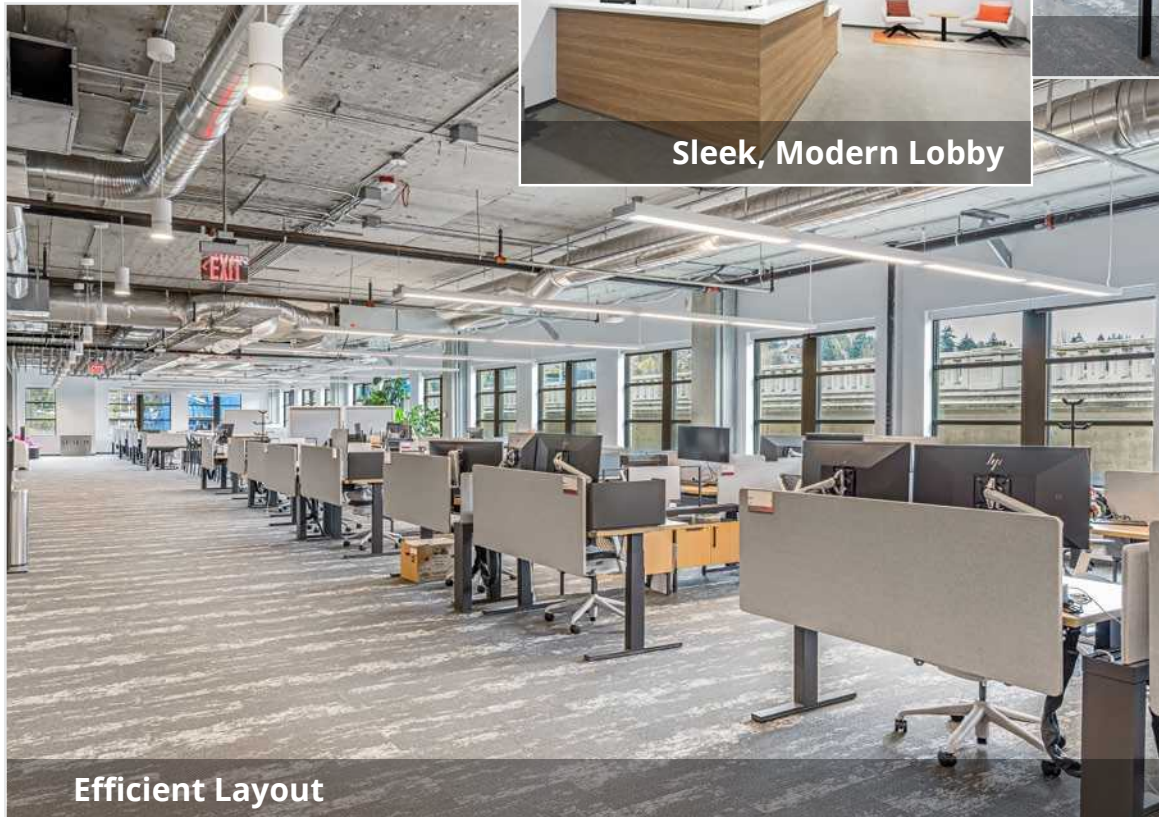

Efficient Layout



Conference Room

# Plaza Building

2nd Floor: 31,840 SF

Expiration 6/30/2027

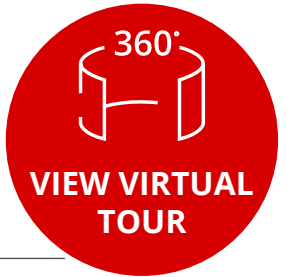

## Layout

- 229 workstations
- 21 conference rooms
- 1 large conference room (fits 40+ people)
- 13 call rooms
- 1 large kitchen
- 1 mother room

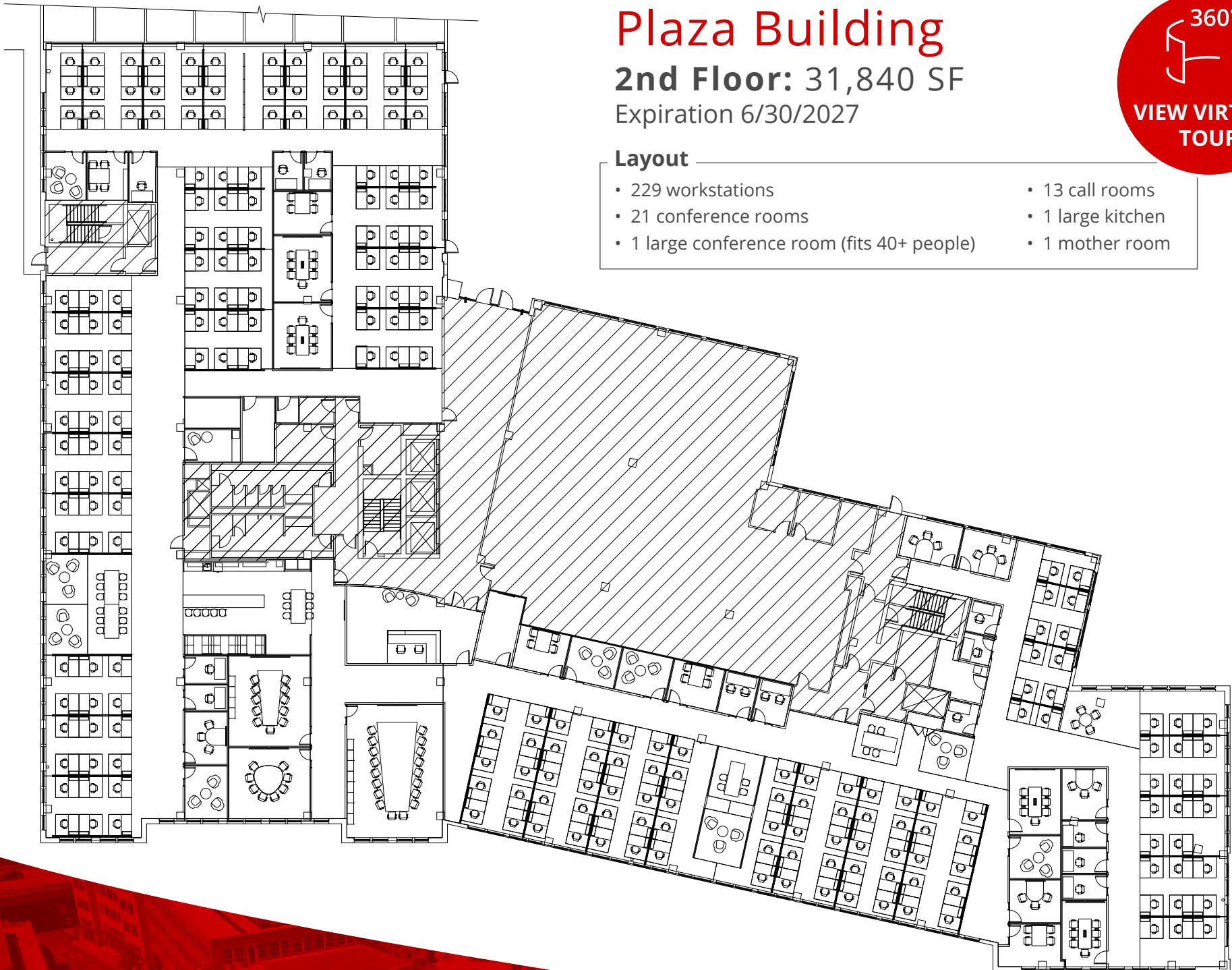

# FREMONT - THE CENTER OF THE UNIVERSE

**10 Minutes**  
to UW Campus

**10 Minutes**  
to Seattle CBD

**25 Minutes**  
to Bellevue CBD



Gas Works Park

Pablo y Pablo

The Whal Wins

Joule

Fiasco

Fremont Brewing

Cafe Turko

Just Burgers

Evergreens

Milstead Coffee

Kamakura

Fainting Goat Gelato

Kin Len Thai

Jai Thai

Pel Meni Dumpling

MOD Pizza

Eve Fremont

Red Star Taco

Triangle Spirits

Starbucks

Nuna Ramen

El Camino

PCC

Fremont Coffee Co.

The Barrel Thief

Brouwer's Cafe

Theo Chocolate

# FREMONT

## LAKE UNION CENTER

**Plaza Building: 701 N 34th St | Seattle WA 98103**  
**2nd Floor: 31,840 SF Sublease**



**COLLIERS INTERNATIONAL**  
601 Union St, Suite 5300  
Seattle, WA, 98101  
[www.colliers.com](http://www.colliers.com)

**Connor McClain**  
Senior Vice President  
(425) 785-5660  
[connor.mcclain@colliers.com](mailto:connor.mcclain@colliers.com)

**Joe Conner**  
Associate  
(425) 698-7142  
[joe.conner@colliers.com](mailto:joe.conner@colliers.com)