

# 24,791 SF

Industrial Space For Lease



## Prologis Harvest Business Park - Kent 9



6405 S 194th Street  
Kent, WA 98032 USA

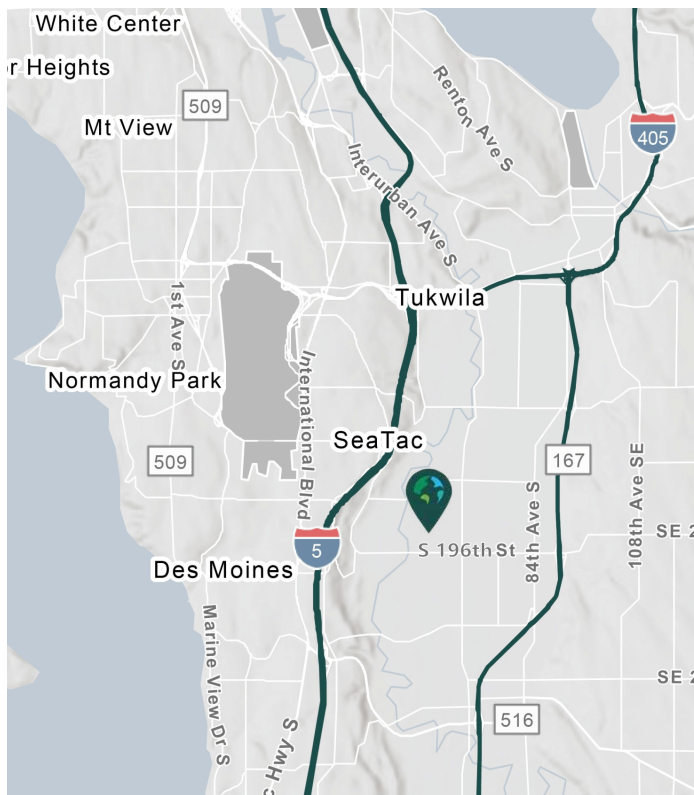

### LOCATION

- Strategic distribution location
- Great access to I-5 and SR-167
- Just minutes from SeaTac International Airport

### FACILITY

- Total building size: 63,944 SF
- Total available: 24,791 SF
- Total office: 7,465 SF in two nodes
- 22' clear height
- 6 dock-high doors
- 50' x 22'6" typical column spacing
- Wet sprinkler system
- 52 auto parking stalls
- Available April 1, 2024
- Contact brokers for rates

### ADVANTAGES AND AMENITIES

- Corporate image

**Your single-source service for efficient move-in and operations: [prologisessentials.com](https://www.prologisessentials.com)**

# 24,791 SF

Industrial Space For Lease



## Prologis Harvest Business Park - Kent 9

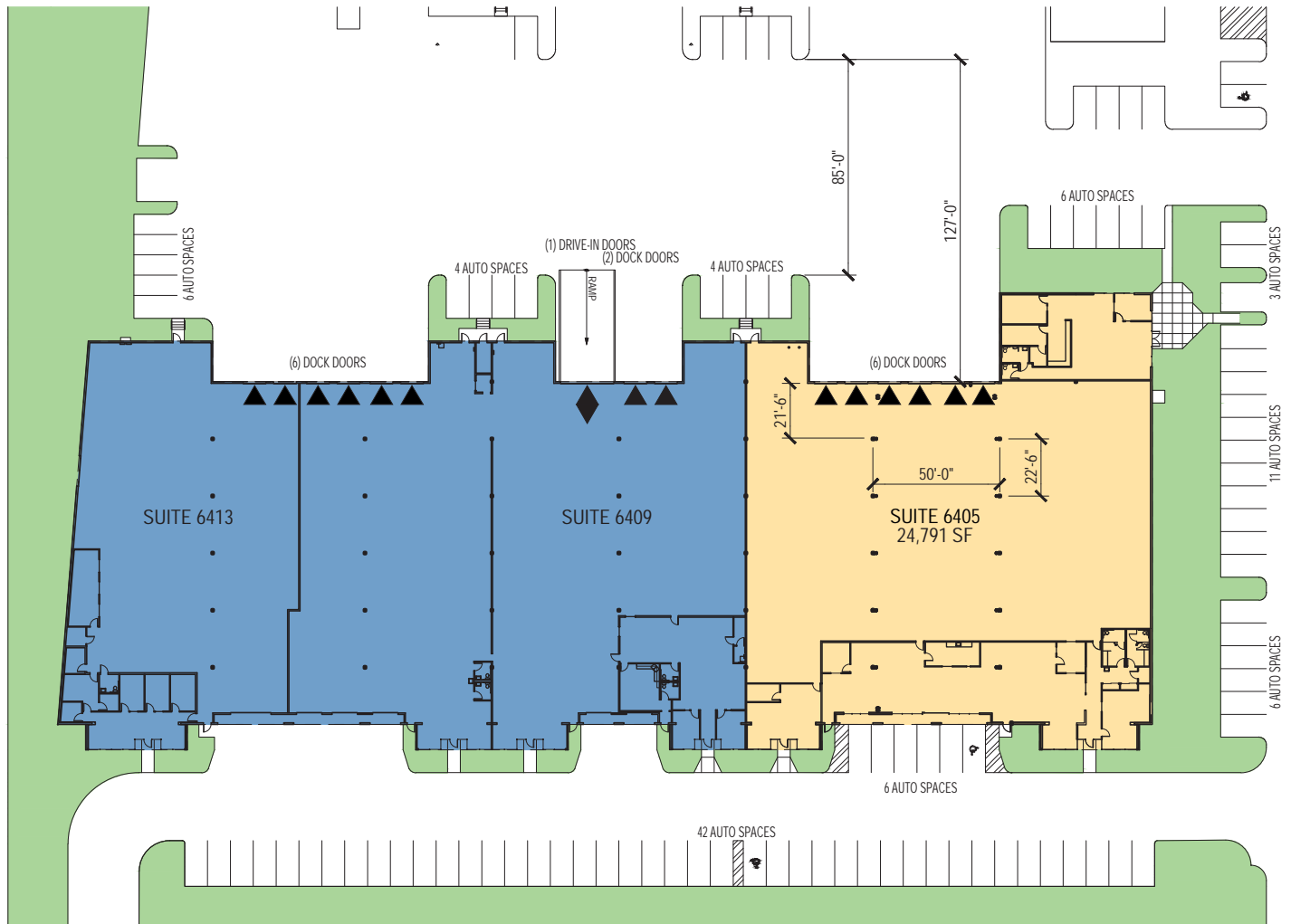

**Les Boudwin, SIOR**  
les.boudwin@jll.com  
ph +1 206 679 6393  
225 108th Avenue NE  
Suite 550  
Bellevue, WA 98004 USA

**Scott Carter**  
scott.carter@jll.com  
ph +1 425 761 5880  
225 108th Avenue NE  
Suite 550  
Bellevue, WA 98004 USA

**David Cahill**  
david.cahill@jll.com  
ph +1 206 930 5599  
601 Union Street  
Suite 2800  
Seattle, WA 98101 USA

**Prologis**  
Kimberley Nemethy  
knemethy@prologis.com  
ph +1 253 508 1737  
33930 Weyerhaeuser Way S  
Suite 100  
Federal Way, WA 98001 USA