



±55,000 SF

Industrial space for sublease

Available Now



Kent East Corporate Park

21430 S 86th Place, Kent, WA 98032

Highlights

- Great North Kent Valley Location
- Easily accessible to SR-167
- Nice corporate image

Property specifications

- ±55,000 SF available (divisible down to 30,000 SF)
- ±7,000 SF office
- 24' clear height
- 9-17 dock doors
- 1 drive-in door
- Contact brokers for rates

Chris Spofford

Senior Managing Director
+1 425 890 6961
chris.spofford@jll.com

David Cahill

Managing Director
+1 206 9305 5599
david.cahill@jll.com



±55,000 SF (Divisible to 30,000 SF)

Industrial space for sublease



Chris Spofford
Senior Managing Director
+1 425 890 6961
chris.spofford@jll.com

David Cahill
Managing Director
+1 206 930 5599
david.cahill@jll.com

±55,000 SF (Divisible to 30,000 SF)

Industrial space for sublease

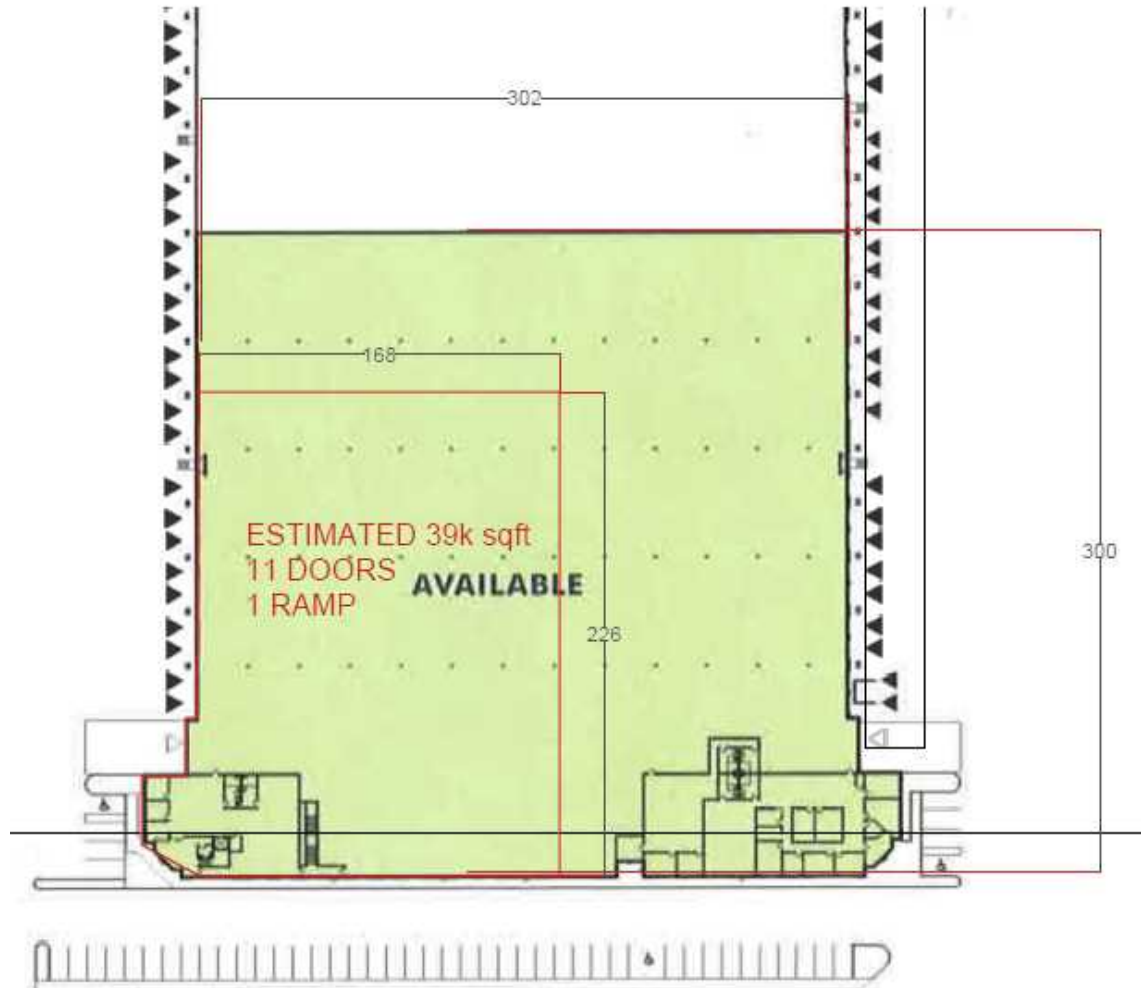

Option 1

- ±39,000 SF
- ±7,000 SF office
- 11 Dock high doors
- 1 Grade level door, ramped
- 24' clear height
- Contact brokers for rates

Chris Spofford
Senior Managing Director
+1 425 890 6961
chris.spofford@jll.com

David Cahill
Managing Director
+1 206 930 5599
david.cahill@jll.com

Although information has been obtained from sources deemed reliable, neither Owner nor JLL makes any guarantees, warranties or representations, express or implied, as to the completeness or accuracy as to the information contained herein. Any projections, opinions, assumptions or estimates used are for example only. There may be differences between projected and actual results, and those differences may be material. The Property may be withdrawn without notice. Neither Owner nor JLL accepts any liability for any loss or damage suffered by any party resulting from reliance on this information. If the recipient of this information has signed a confidentiality agreement regarding this matter, this information is subject to the terms of that agreement. © 2023 Jones Lang LaSalle IP, Inc. All rights reserved.



±55,000 SF (Divisible to 30,000 SF)

Industrial space for sublease

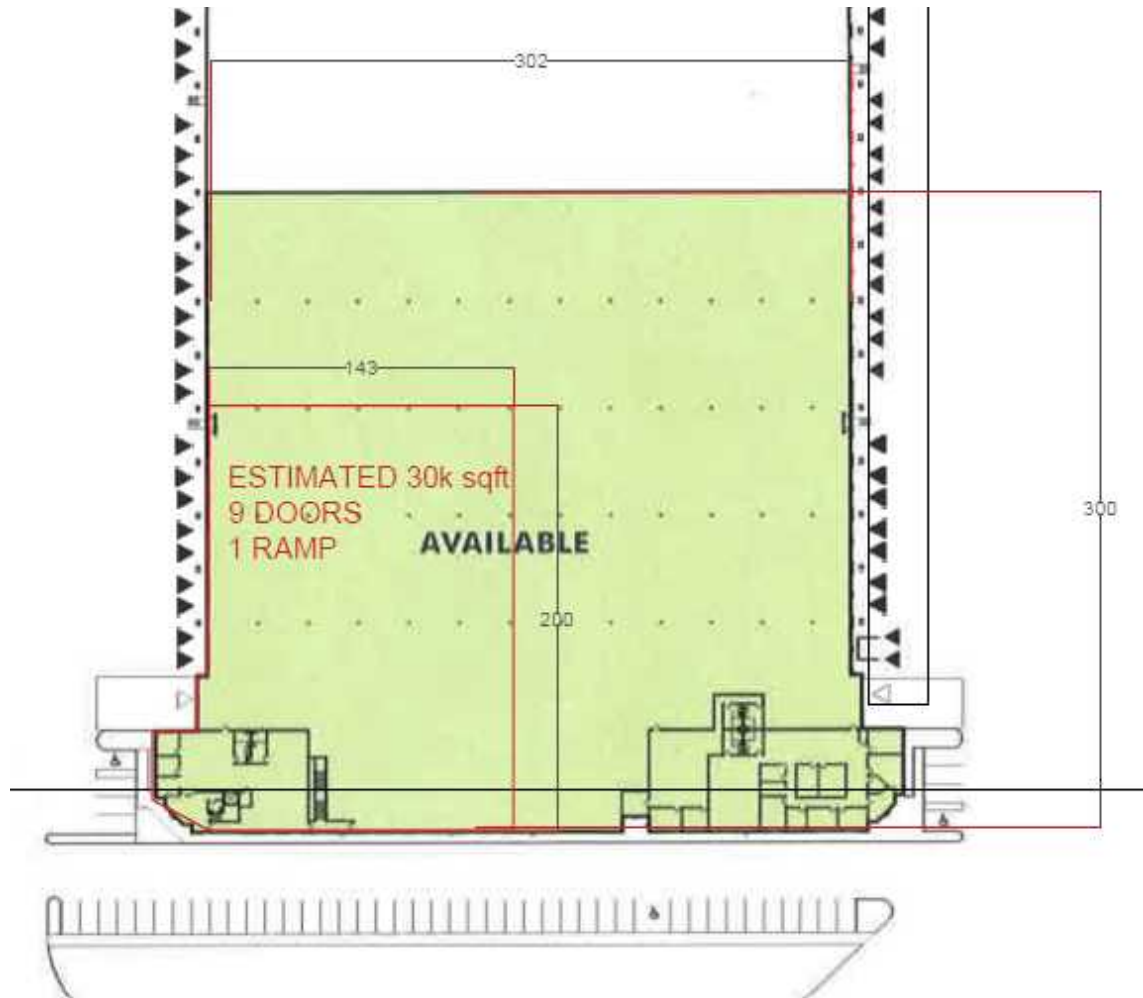

Option 2

- ±30,000 SF
- ±7,000 SF office
- 9 Dock high doors
- 1 Grade level door, ramped
- 24' clear height
- Contact brokers for rates

Chris Spofford

Senior Managing Director
+1 425 890 6961
chris.spofford@jll.com

David Cahill

Managing Director
+1 206 930 5599
david.cahill@jll.com

Although information has been obtained from sources deemed reliable, neither Owner nor JLL makes any guarantees, warranties or representations, express or implied, as to the completeness or accuracy as to the information contained herein. Any projections, opinions, assumptions or estimates used are for example only. There may be differences between projected and actual results, and those differences may be material. The Property may be withdrawn without notice. Neither Owner nor JLL accepts any liability for any loss or damage suffered by any party resulting from reliance on this information. If the recipient of this information has signed a confidentiality agreement regarding this matter, this information is subject to the terms of that agreement. © 2023 Jones Lang LaSalle IP, Inc. All rights reserved.



±55,000 SF (Divisible to 30,000 SF)

Industrial space for sublease

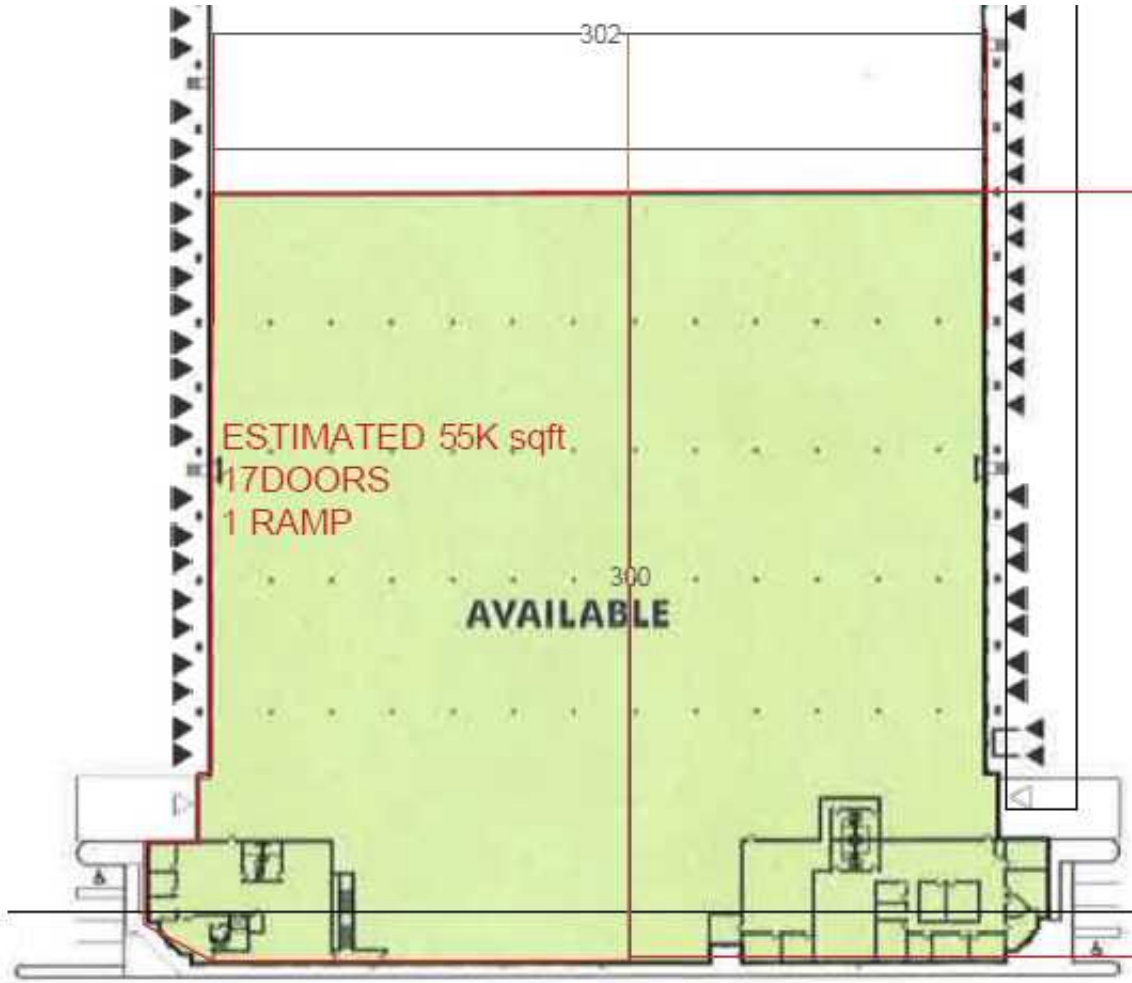

Option 3

- ±55,000 SF
- ±7,000 SF office
- 17 Dock high doors
- 1 Grade level door, ramped
- 24' clear height
- Contact brokers for rates

Chris Spofford
Senior Managing Director
+1 425 890 6961
chris.spofford@jll.com

David Cahill
Managing Director
+1 206 930 5599
david.cahill@jll.com

Although information has been obtained from sources deemed reliable, neither Owner nor JLL makes any guarantees, warranties or representations, express or implied, as to the completeness or accuracy as to the information contained herein. Any projections, opinions, assumptions or estimates used are for example only. There may be differences between projected and actual results, and those differences may be material. The Property may be withdrawn without notice. Neither Owner nor JLL accepts any liability for any loss or damage suffered by any party resulting from reliance on this information. If the recipient of this information has signed a confidentiality agreement regarding this matter, this information is subject to the terms of that agreement. © 2023 Jones Lang LaSalle IP, Inc. All rights reserved.

