

**FOR LEASE**

2801 Hollycroft Street  
Gig Harbor, WA 98335



# COLDWELL BANKER BUILDING

Ray Velkers

First Western Properties—Tacoma Inc. | 253.472.0404  
6402 Tacoma Mall Blvd, Tacoma, WA 98409 | fwp-inc.com



**COLDWELL BANKER BUILDING** is centrally located in Gig Harbor, adjacent to the busy Olympic Village and just off of Highway 16 at the top of the hill before making your way down to downtown Gig Harbor. The office building offers ample parking and available space on the first floor.

**AVAILABLE**

▶▶ 700 +/- SF OFFICE \$950/MO

INCLUDES UTILITIES

▶▶ 154 +/- SF OFFICE \$550/MO

INCLUDES UTILITIES

▶▶ 140 +/- SF OFFICE \$450/MO

INCLUDES UTILITIES



Population



Average HH Income



Daytime Population

Regis - 2022

	Population	Average HH Income	Daytime Population
Mile 1	6,250	\$109,030	8,447
Mile 3	26,064	\$125,548	24,457
Mile 5	89,044	\$125,222	62,863

**NEARBY RETAIL**

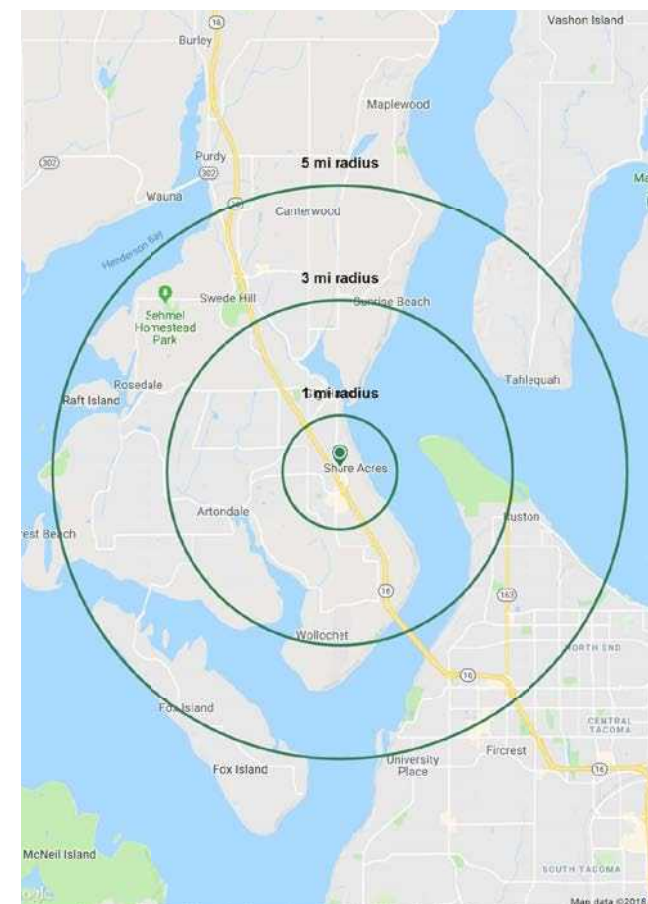

PHOTOS





FLOOR PLAN

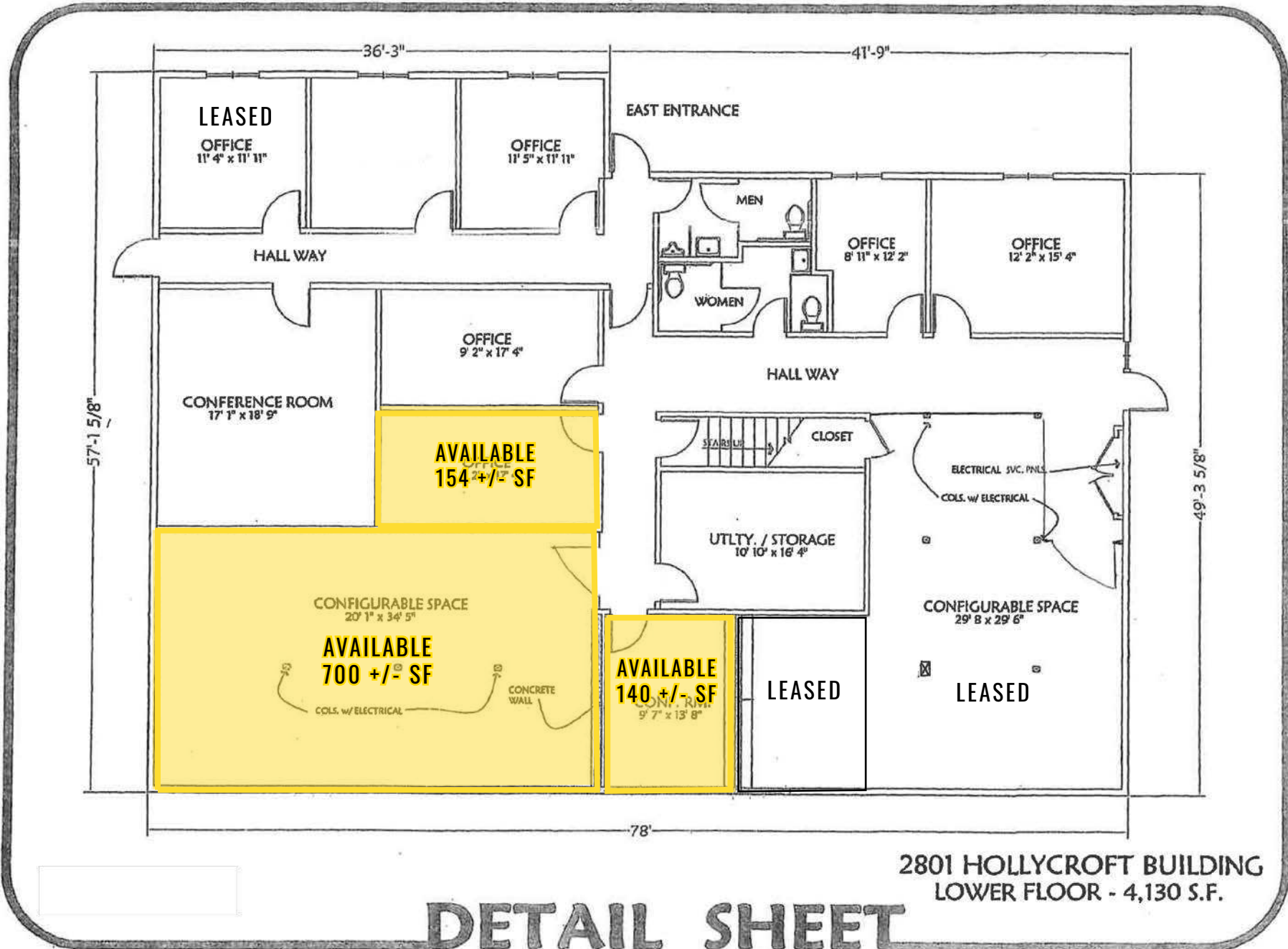

2801 HOLLYCROFT BUILDING  
LOWER FLOOR - 4,130 S.F.

DETAIL SHEET





LOCATION DETAILS

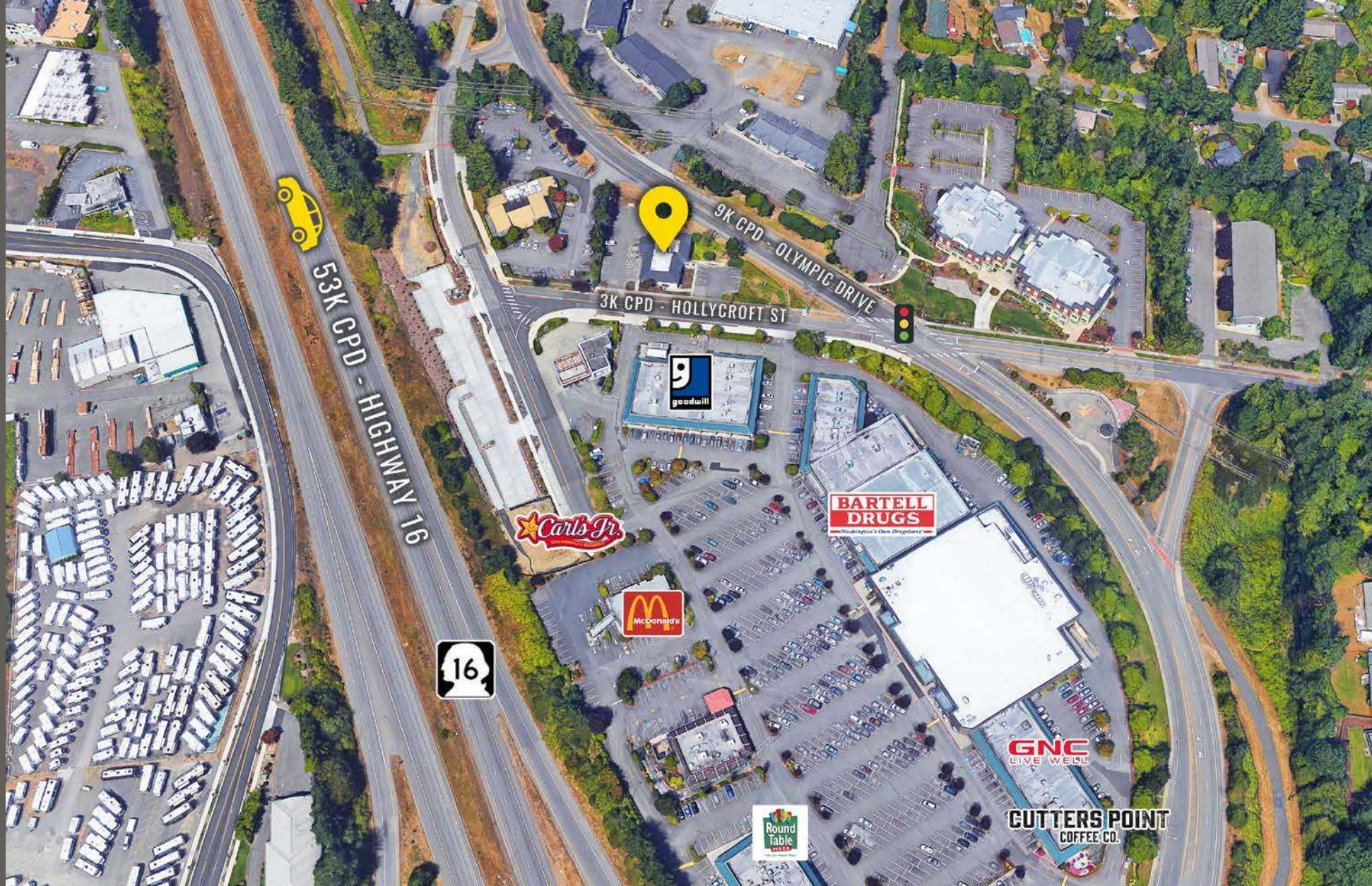

Located directly off of  
HWY 16 - Olympic Dr Exit



Adjacent to the busy  
Olympic Village



20,000 CPD  
Olympic Drive



3,000 CPD  
Hollycroft Street



LOCATION AERIAL



**Fred Meyer** **PETSMART**

**HOP JACK'S** **Starbucks** **FRANKY JONES**

**AutoZone** **TacoTime**

**OCEAN 5** **Columbia Bank** **KeyBank**

**goodwill** **RadioShack** **BARTELL DRUGS** **GNC LIVE WELL**

**McDonald's** **Round Table RESTAURANT** **GOODYEAR** **Carl's Jr.**

**RITE AID** **MUDBAY** **O'Reilly AUTO PARTS**

**ACE Hardware** **CHASE** **Starbucks**

**Bank of America** **Michaels** **SAFEWAY**

**Applebee's** **KOHL'S** **expect great things**

**Panera BREAD** **J.Jill** **LOFT**

**Blazing Union** **Coldwater Creek** **GALAXY THEATRES**

**CUTTERS POINT COFFEE CO.** **BEN & JERRY'S** **Marshalls**





**GIG HARBOR, WA** is both a bay on the Puget Sound and a harbor town that has been named one of the Smithsonian Magazines Top Five Small Towns for culture, heritage and charm. Its unique location, close to metropolitan centers, yet positioned on a quiet, beautiful and historic peninsula - provides visitors and residents with excellent site-seeing, history, culture, dining, shopping and more.



TACOMA | KIRKLAND | SEATTLE | PORTLAND



RELATIONSHIP FOCUSED. RESULTS DRIVEN.

RAY VELKERS

253.284.3632

[ray@firstwesternproperties.com](mailto:ray@firstwesternproperties.com)



First Western Properties—Tacoma Inc. | 253.472.0404  
6402 Tacoma Mall Blvd, Tacoma, WA 98409 | [fwp-inc.com](http://fwp-inc.com)

© First Western Properties, Inc. DISCLAIMER: The above information has been secured from sources believed to be reliable, however, no representations are made to its accuracy. Prospective tenants or buyers should consult their professional advisors and conduct their own independent investigation. Properties are subject to change in price and/or availability without notice.