

# KALANI INDUSTRIAL CENTER

FOR LEASE | Up to 33,797 SF  
Industrial/Flex space  
now available



4301 78TH ST SW MUKILTEO, WA 98275

**km** Kidder  
Mathews

FOR LEASE

# Kalani Industrial Center

4301 78TH ST SW MUKILTEO, WA 98275

## Site Plan

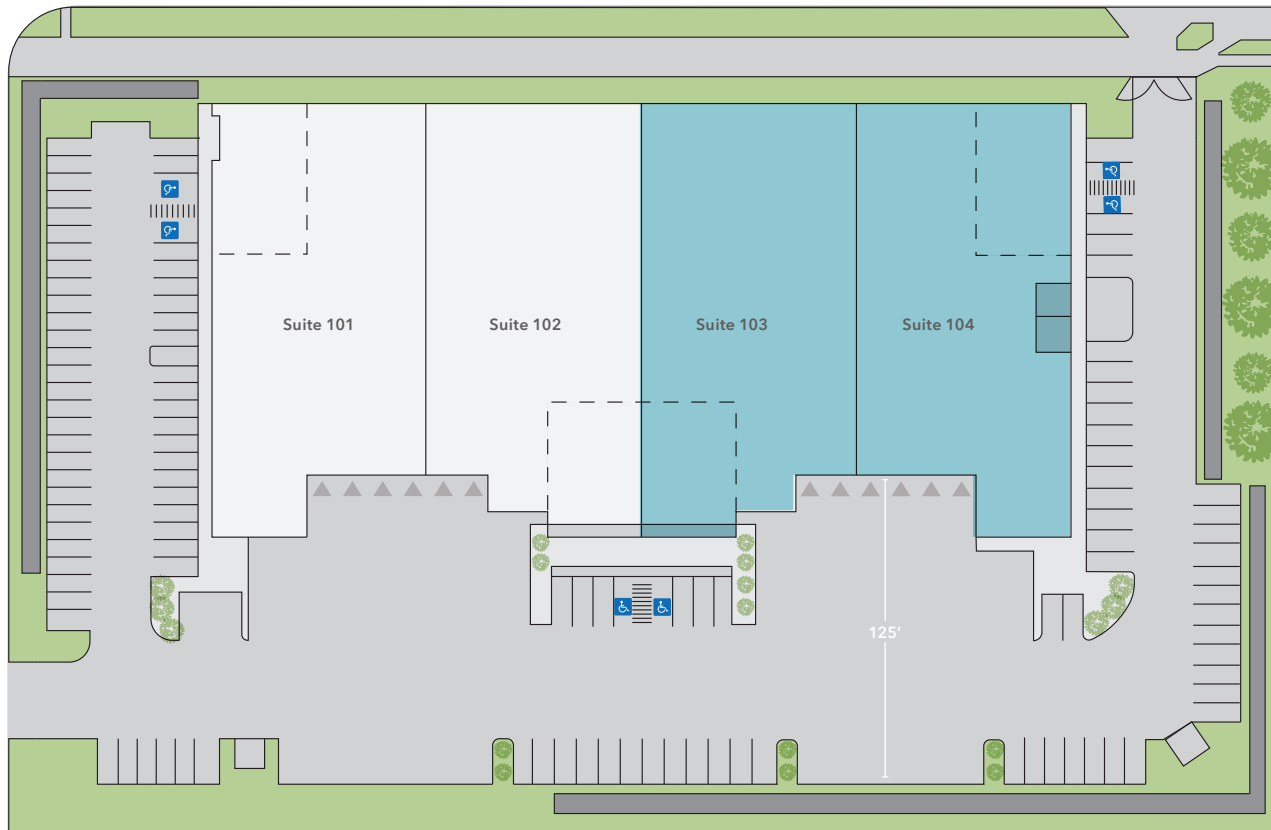

 Mezzanine



## Highlights

**SUITE 103** 17,246 SF  
(± 500 SF office)

**SUITE 104** 16,551 SF  
(± 3,150 SF office)

**NEW** construction

**DOCK** and grade  
level loading

**ESFR** sprinklers

**24'** clear

**3-PHASE** power

**CLOSE** proximity to I-5,  
and SR525/526

**UNIQUE** park-like setting

**MATTHEW HAGEN, SIOR**  
425.283.5782  
matt.hagen@kidder.com

**MATTHEW P. HENN**  
206.890.7800  
matt.henn@kidder.com

[KIDDER.COM](http://KIDDER.COM)

This information supplied herein is from sources we deem reliable. It is provided without any representation, warranty, or guarantee, expressed or implied as to its accuracy. Prospective Buyer or Tenant should conduct an independent investigation and verification of all matters deemed to be material, including, but not limited to, statements of income and expenses. Consult your attorney, accountant, or other professional advisor.

 **Kidder  
Mathews**

FOR LEASE

# Kalani Industrial Center

4301 78TH ST SW MUKILTEO, WA 98275

## Suite 103

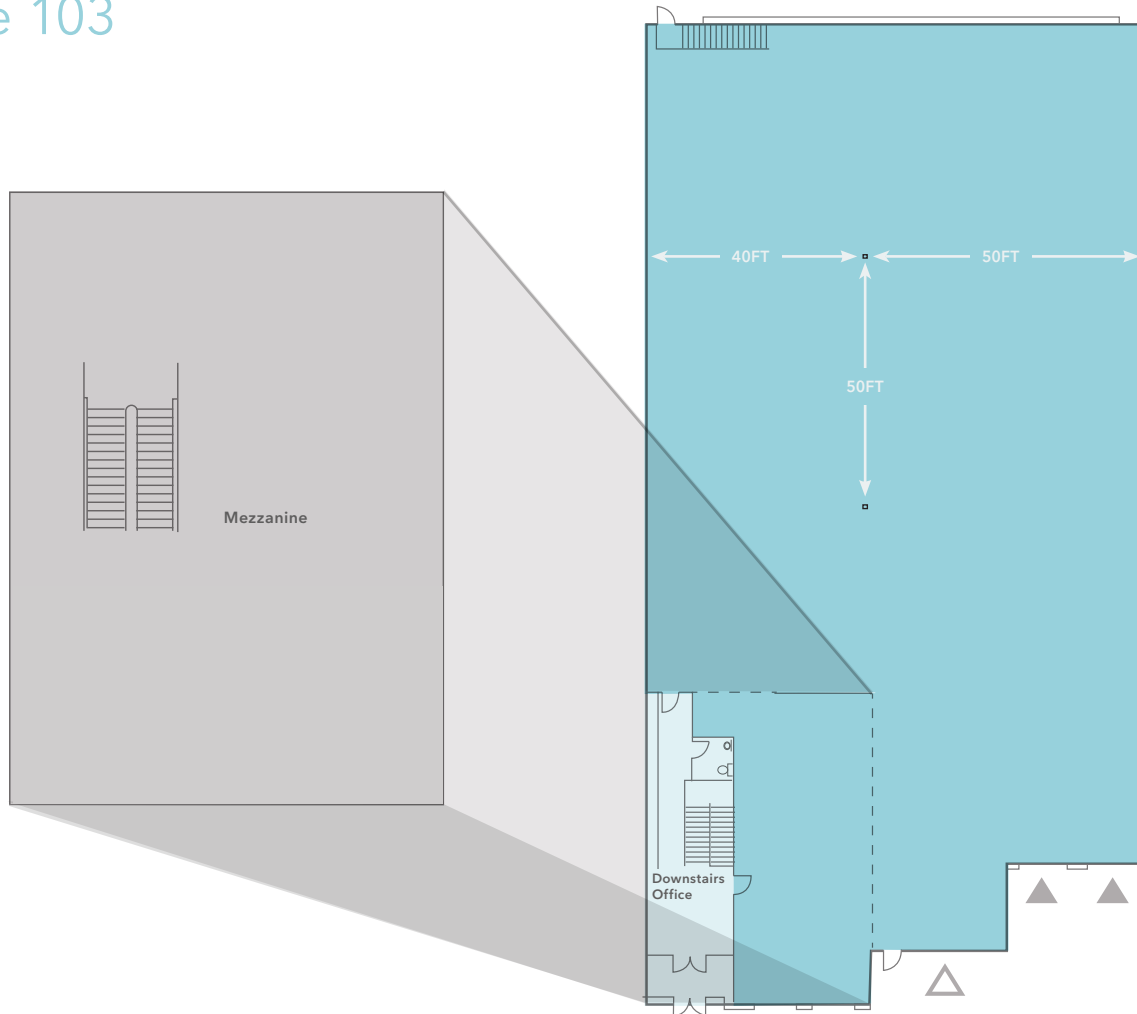

**17,246 SF**

TOTAL AREA (± 500 SF OF OFFICE)

**14,866 SF**

FIRST FLOOR

**± 500 SF**

DOWNSTAIRS OFFICE

**2,255 SF**

MEZZANINE

**MATTHEW HAGEN, SIOR**

425.283.5782

matt.hagen@kidder.com

**MATTHEW P. HENN**

206.890.7800

matt.henn@kidder.com

▲ Dock high doors

△ Grade level doors

[KIDDER.COM](http://KIDDER.COM)

This information supplied herein is from sources we deem reliable. It is provided without any representation, warranty, or guarantee, expressed or implied as to its accuracy. Prospective Buyer or Tenant should conduct an independent investigation and verification of all matters deemed to be material, including, but not limited to, statements of income and expenses. Consult your attorney, accountant, or other professional advisor.

**km Kidder Mathews**

FOR LEASE

# Kalani Industrial Center

4301 78TH ST SW MUKILTEO, WA 98275

## Suite 104

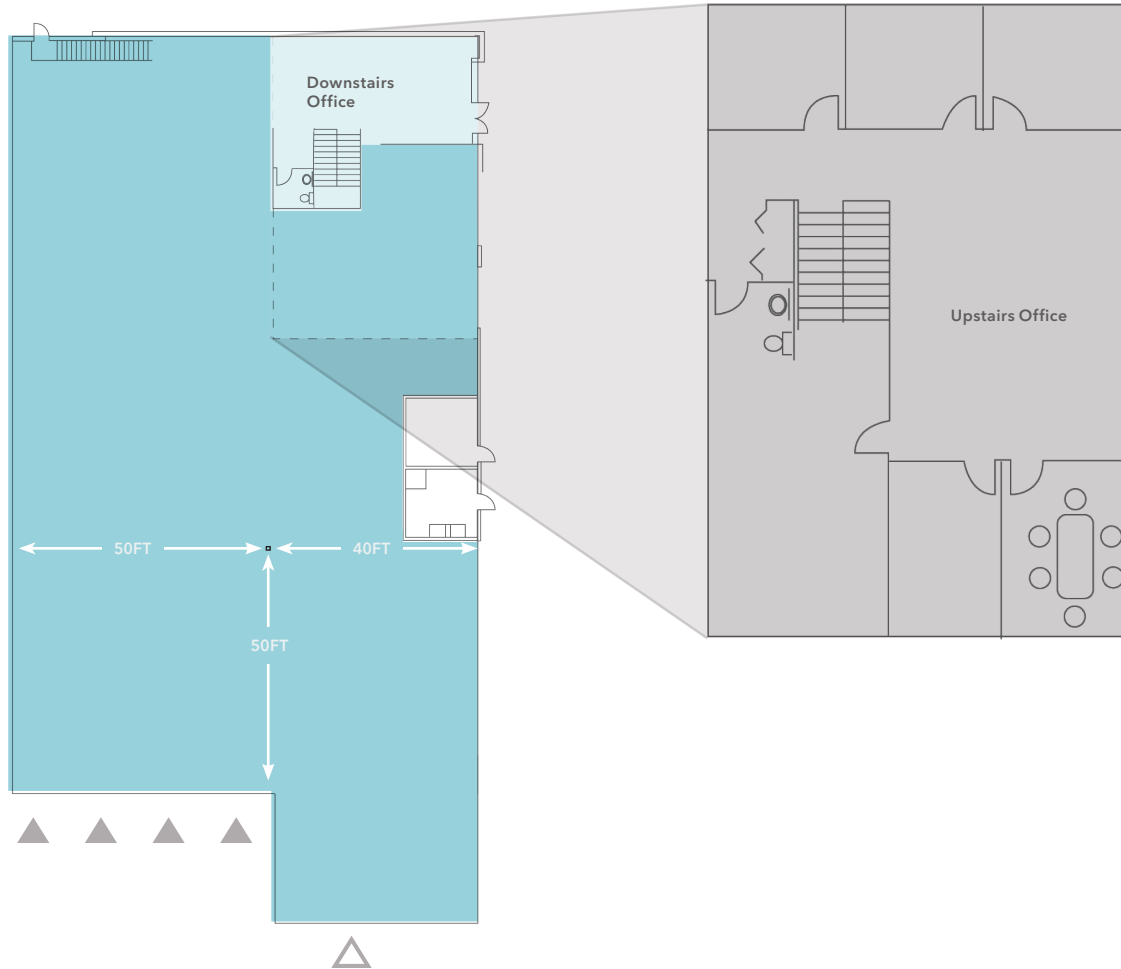

**16,551 SF**

TOTAL AREA (3,150 OF OFFICE)

**13,282 SF**

FIRST FLOOR

**717 SF**

DOWNSTAIRS OFFICE

**2,432 SF**

UPSTAIRS OFFICE

**MATTHEW HAGEN, SIOR**

425.283.5782

matt.hagen@kidder.com

**MATTHEW P. HENN**

206.890.7800

matt.henn@kidder.com

▲ Dock high doors

△ Grade level doors

KIDDER.COM

This information supplied herein is from sources we deem reliable. It is provided without any representation, warranty, or guarantee, expressed or implied as to its accuracy. Prospective Buyer or Tenant should conduct an independent investigation and verification of all matters deemed to be material, including, but not limited to, statements of income and expenses. Consult your attorney, accountant, or other professional advisor.

**km** Kidder Mathews



FOR LEASE

# Kalani Industrial Center

4301 78TH ST SW MUKILTEO, WA 98275

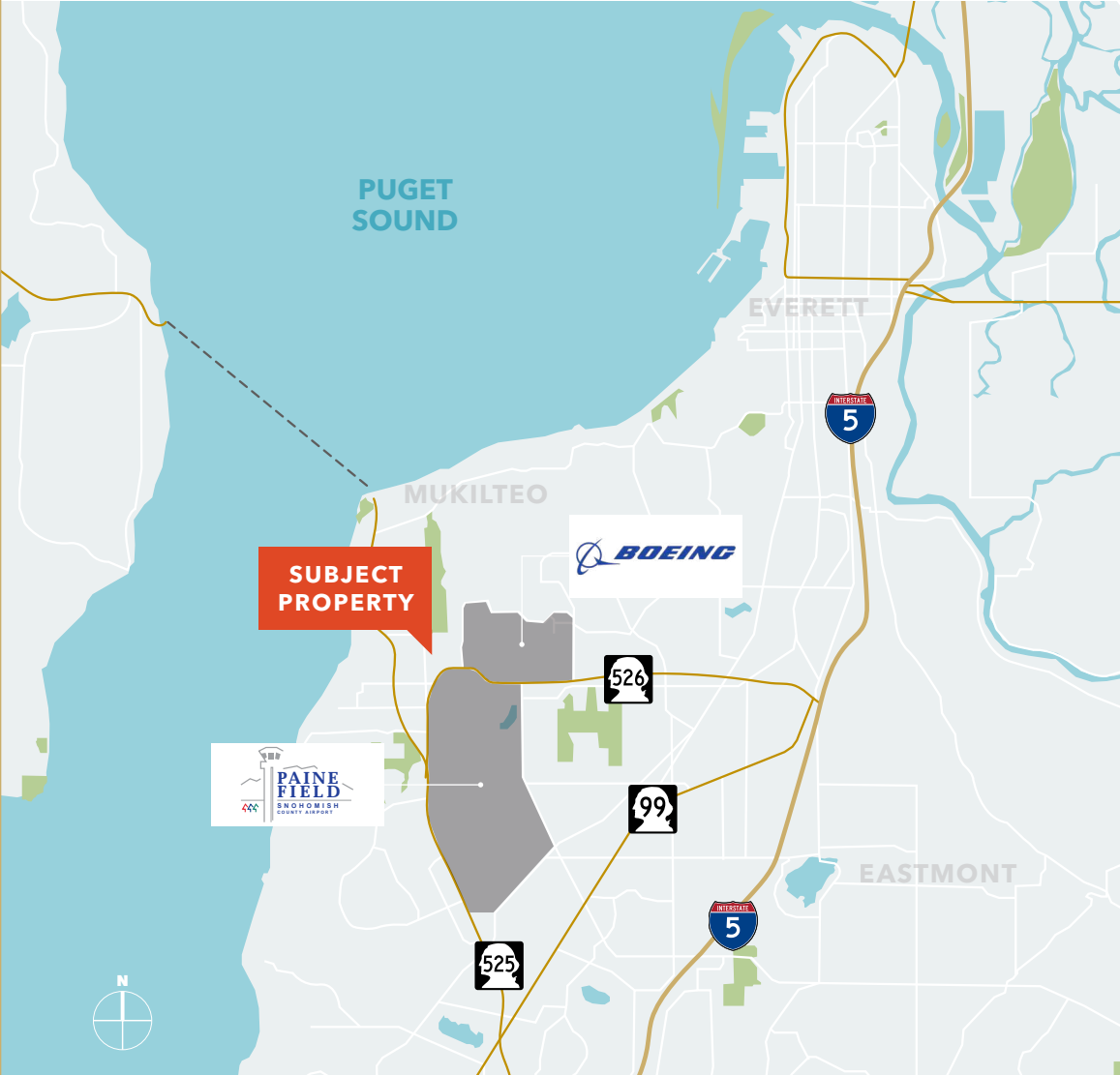
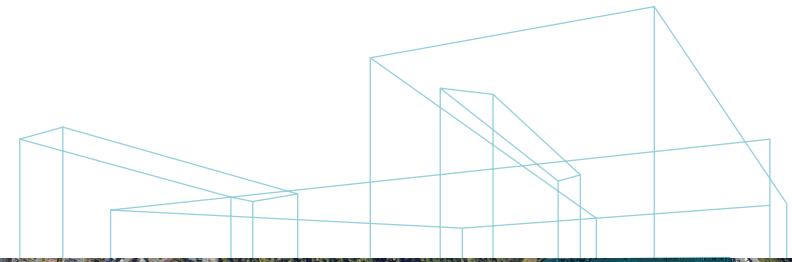

This information supplied herein is from sources we deem reliable. It is provided without any representation, warranty, or guarantee, expressed or implied as to its accuracy. Prospective Buyer or Tenant should conduct an independent investigation and verification of all matters deemed to be material, including, but not limited to, statements of income and expenses. Consult your attorney, accountant, or other professional advisor.



## Contact brokers for rates

**MATTHEW HAGEN, SIOR**  
425.283.5782  
[matt.hagen@kidder.com](mailto:matt.hagen@kidder.com)

**MATTHEW P. HENN**  
206.890.7800  
[matt.henn@kidder.com](mailto:matt.henn@kidder.com)

[KIDDER.COM](http://KIDDER.COM)

This information supplied herein is from sources we deem reliable. It is provided without any representation, warranty, or guarantee, expressed or implied as to its accuracy. Prospective Buyer or Tenant should conduct an independent investigation and verification of all matters deemed to be material, including, but not limited to, statements of income and expenses. Consult your attorney, accountant, or other professional advisor.