

For Lease

LAKEWOOD-TACOMA LOGISTICS CENTER

14801 SPRING ST SW
LAKEWOOD, WA

*208,370 SF Class A
Industrial Warehouse*

LAKEWOOD-TACOMA LOGISTIC CENTER



Available January 1, 2024

208,370 SF (3,170 SF office)

\$0.18 PSF, NNN

57 DH / 3 GL

1,200 amps, three-phase power

36' clear-height

130' truck courts

50' x 50' column spacing with 60' speed bay

69 trailer parking stalls

Tax benefits include Foreign Trade Zone #86, EB5 target employment area, HUB zone, new market tax credit eligible, no city B&O tax

208,370 SF

AVAILABLE

CALL

BROKER FOR RATES

SITE PLAN

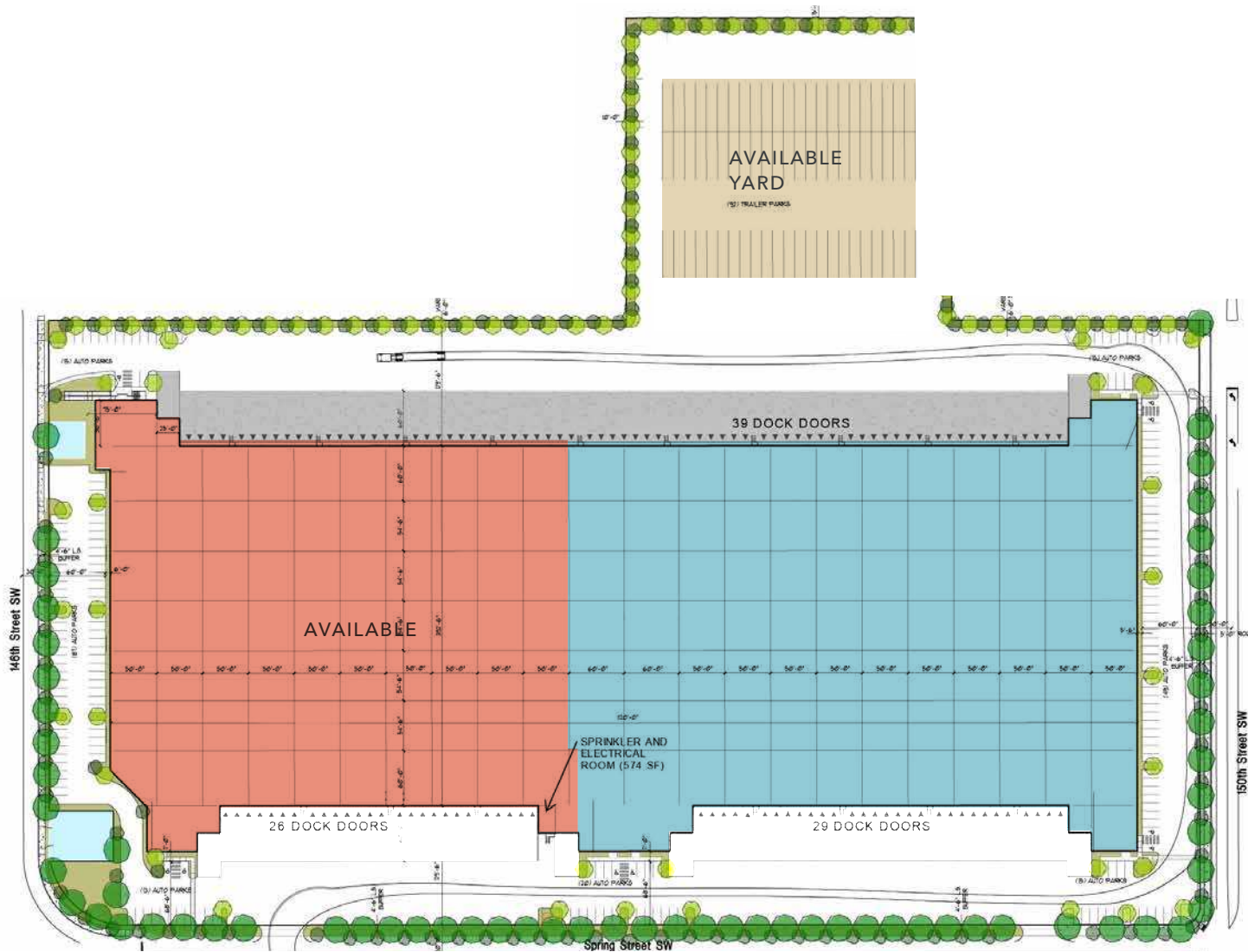

208,370 SF

AVAILABLE

\$0.18

NNN RATE (SF/YR)

01.2024

AVAILABLE

Available

208,370 SF with 3,170 SF office

FREEWAY ACCESS



LAKEWOOD-TACOMA LOGISTIC CENTER

Exclusively leased by

TODD CLARKE

253.722.1422

todd.clarke@kidder.com

TY CLARKE

253.722.1419

ty.clarke@kidder.com

KIDDER.COM

This information supplied herein is from sources we deem reliable. It is provided without any representation, warranty, or guarantee, expressed or implied as to its accuracy. Prospective Buyer or Tenant should conduct an independent investigation and verification of all matters deemed to be material, including, but not limited to, statements of income and expenses. Consult your attorney, accountant, or other professional advisor.

