



CLARION PARTNERS

For Lease



Seattle Distribution Center

6725 E Marginal Way S
Seattle, WA

14,025 Square Feet Available



BUILDING HIGHLIGHTS

- 14,025 SF available
- 366 SF office
- 26' clear height
- 6 dock high doors (3 oversized at 18' x 10')
- Column spacing 24' x 48'
- Concrete tilt-up construction (1967)
- Zoned IG1/U-85
- Seismic building upgraded to current code in 2006
- See attached plan for office / warehouse
- Call for rates

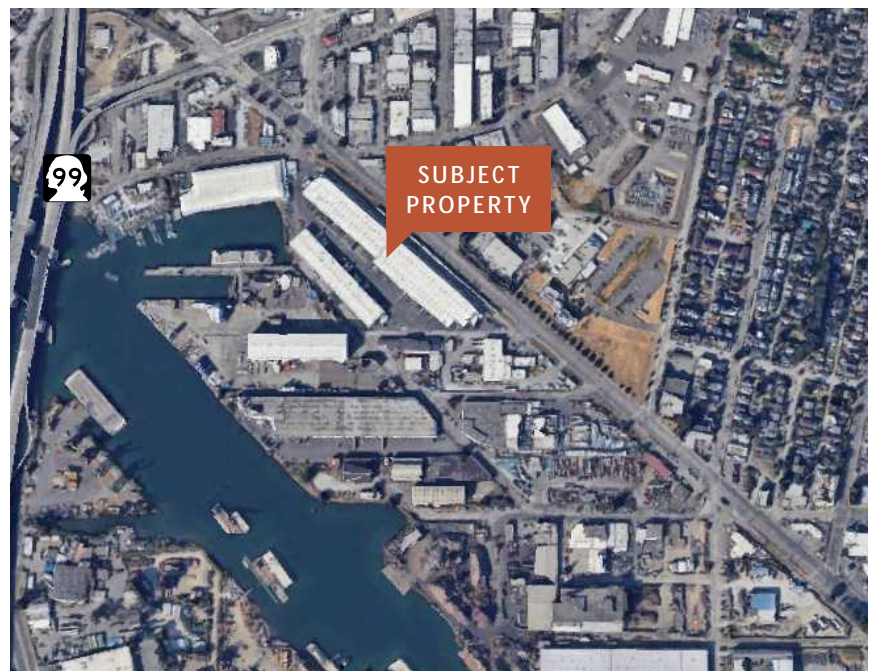

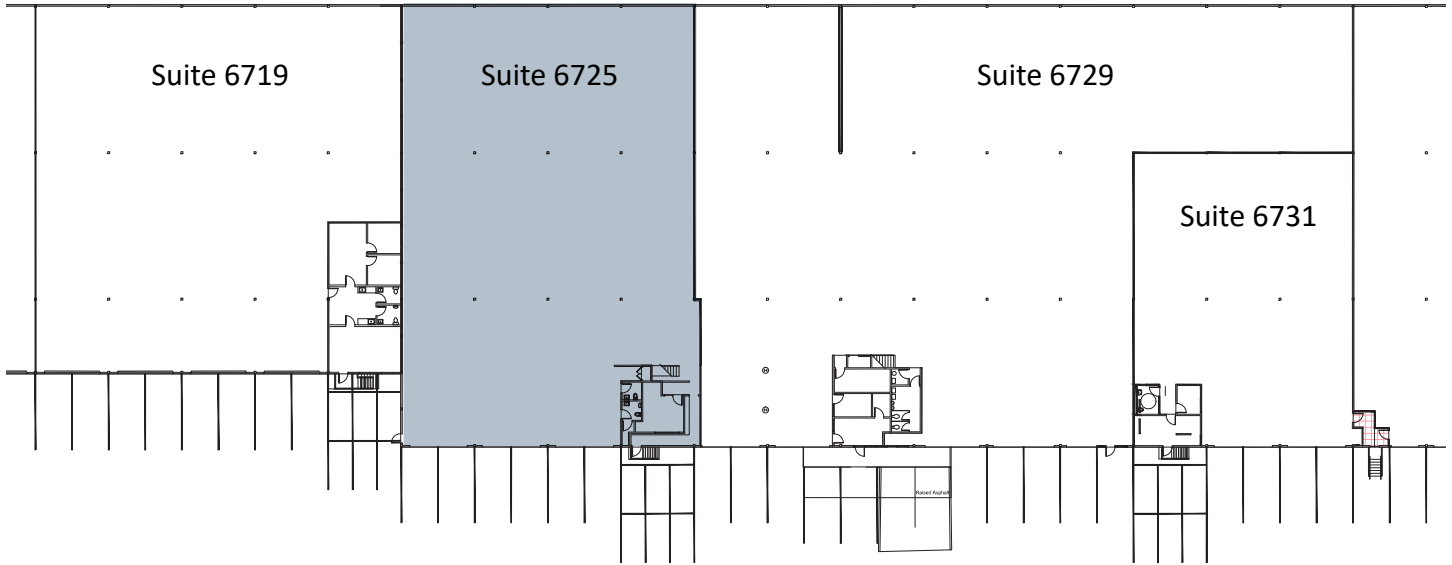

CLARION PARTNERS

www.clarionpartners.com

For more information on this opportunity, please contact



Evan Lugar

Kidder Mathews

206.248.6505

evan.lugar@kidder.com

Patricia Loveall, SIOR

CBRE

425.295.7690

patricia.loveall@cbre.com