

WEST 8TH

2001 8TH AVENUE, SEATTLE

SEPHORA

KILROY

Seattle's Premier Retail Core, Situated in the Heart of South Lake Union

Situated between downtown Seattle's commercial core and Lake Union, West 8th is located in the heart of one of Seattle's most popular and fastest growing neighborhoods, South Lake Union. The adjacent South Lake Union streetcar line puts West 8th within easy reach of the Seattle CBD, Lake Union, the Museum of History and Industry and many vibrant restaurants, cafes, and shops.

South Lake Union offers abundant amenities, bolstered by office and residential growth, making it a live/work/play environment. Join the many successful restaurants and retailers in South Lake Union, including Whole Foods Market, West Elm, Ann Saks, The Butcher's Table, and more.





Centrally located between the downtown Seattle's commercial core and South Lake Union



Ground level retail is ideally situated along Westlake Avenue and the South Lake Union line of the Seattle Streetcar route



Just blocks from the Washington State Convention Center Summit Expansion (coming January 2023)



Walker's Paradise with a walk score of 100



Transit score of 100 with close proximity to I-5, SR-99, the Seattle Streetcar, and the regional Light Rail System



Onsite parking available



SUITE 140

PROPERTY HIGHLIGHTS

SUITE 140
AVAILABLE
±2,010 RSF



**Rent Available
Upon Request**





**Available
Immediately**

SUITE 140 AVAILABILITY

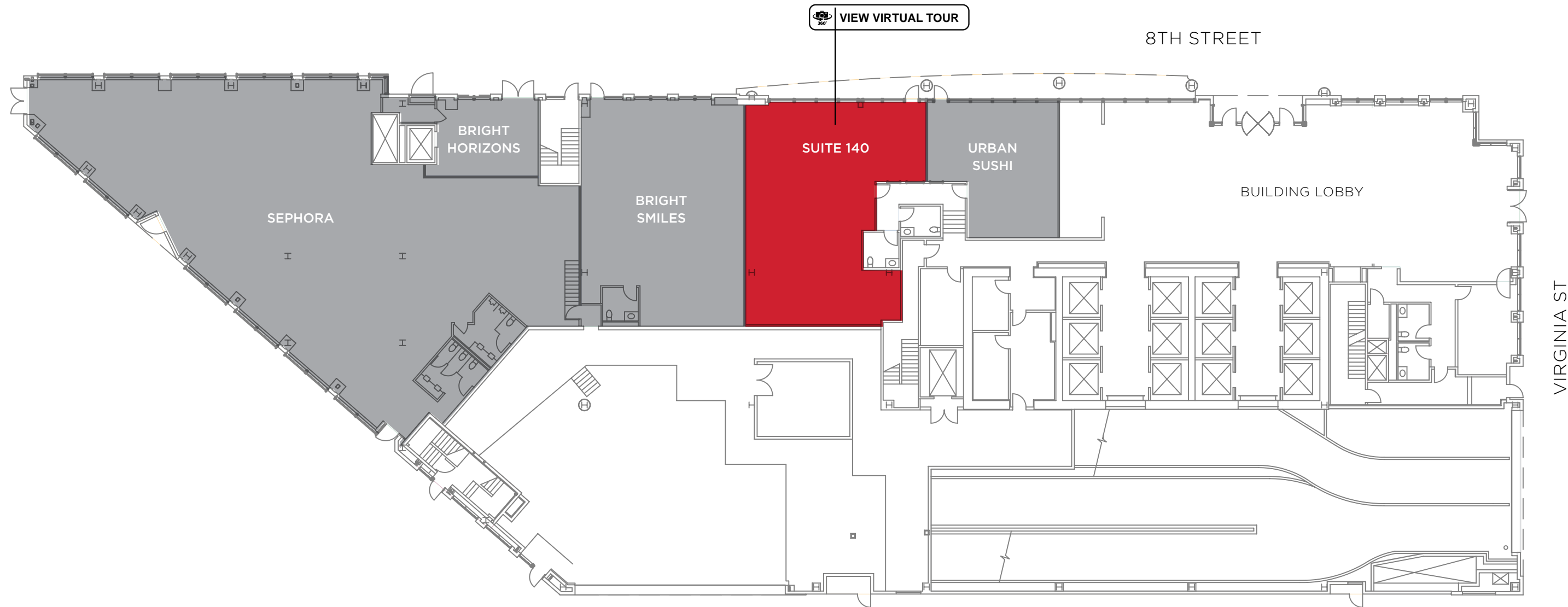
±2,010 RSF



AREA AMENITIES

-  Shops
-  Food + Beverage
-  Light Rail System

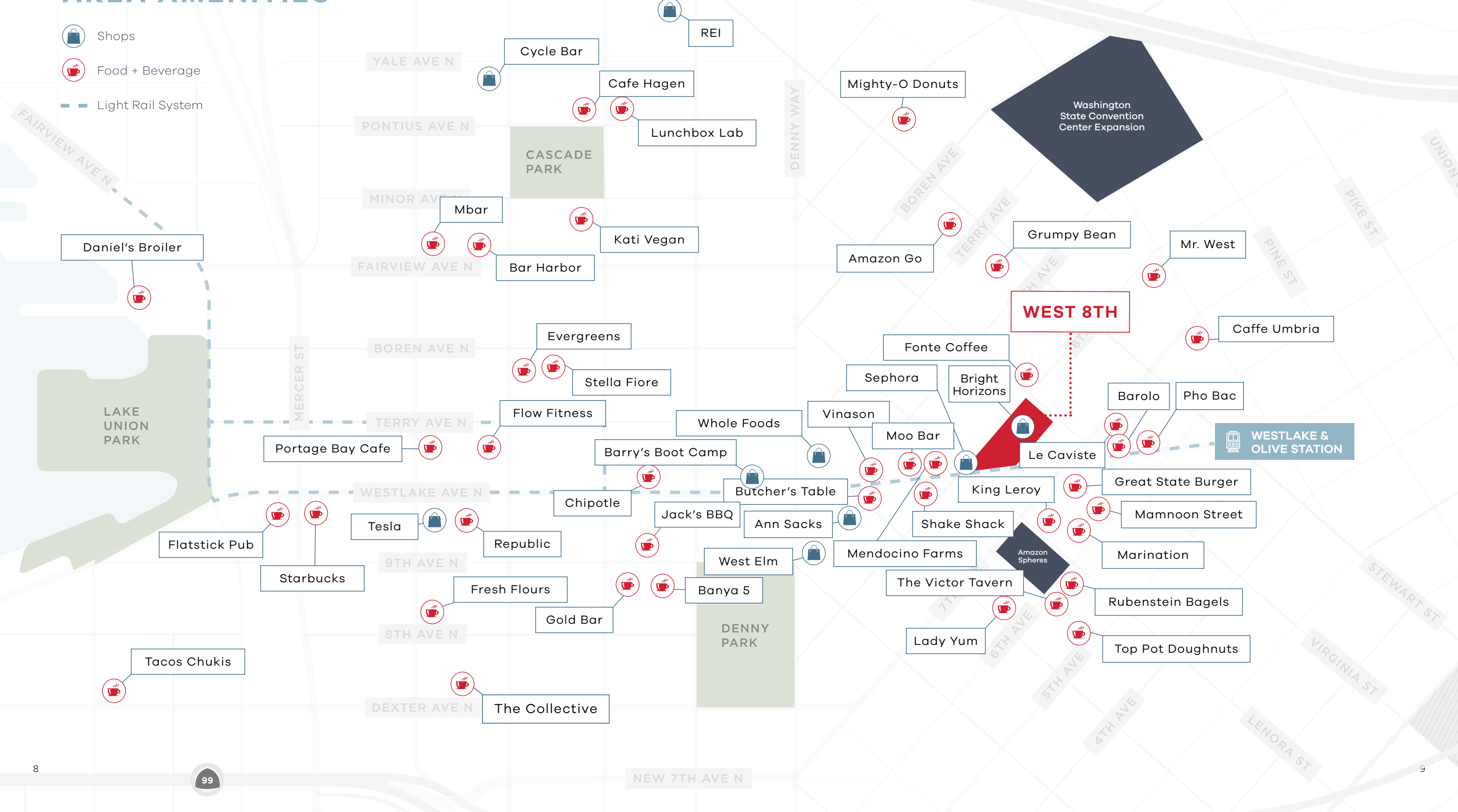



NEIGHBORHOOD NUMBERS

Demographics within a 1-mile radius.

85,118

Residential
Population

181,932

Daytime Population

36.6

Median Age

\$138,157

Median Household Income

Demographic Source: Newmark - The number of employees and businesses is based on a 1-mile radius

ANNE MARIE KOEHLER

lic. 100251

+1 206 487 5167

AnneMarie.Koehler@nrmk.com

ERIKA KOEHLER

lic. 102342

+1 206 487 5168

Erika.Koehler@nrmk.com

NEWMARK

