



WOODINVILLE LANDING, BLDG A

FOR LEASE

2,752 - 6,429 SF
available in a high-image
flex building in the heart
of Woodinville, WA

Kidder
Mathews



FOR LEASE

Woodinville Landing, Bldg A

17270 WOODINVILLE-REDMOND RD, WOODINVILLE, WA



High-image space on Woodinville-Redmond Rd

21,121 SF flex building

OFFICE & FLEX space available immediately

SUITE 702: 2,752 SF (all office)

SUITE 747: 3,677 SF total
(2,552 SF office / 1,125 SF warehouse)

SUITES 702 + 747: 6,429 SF total
(5,304 SF office / 1,125 SF warehouse)

ABUNDANT parking

AIR-CONDITIONED offices with high-end finishes

CLOSE PROXIMITY to I-405, SR-522 and downtown Woodinville

VIEWS of Sammamish River

For more info, contact

JASON BLOOM
425.450.1102
jason.bloom@kidder.com

TODD GAUTHIER
425.450.1118
todd.gauthier@kidder.com

KIDDER.COM

This information supplied herein is from sources we deem reliable. It is provided without any representation, warranty, or guarantee, expressed or implied as to its accuracy. Prospective Buyer or Tenant should conduct an independent investigation and verification of all matters deemed to be material, including, but not limited to, statements of income and expenses. Consult your attorney, accountant, or other professional advisor.

km Kidder Mathews

FOR LEASE

Woodinville Landing, Bldg A

17270 WOODINVILLE-REDMOND RD, WOODINVILLE, WA

Floor Plan

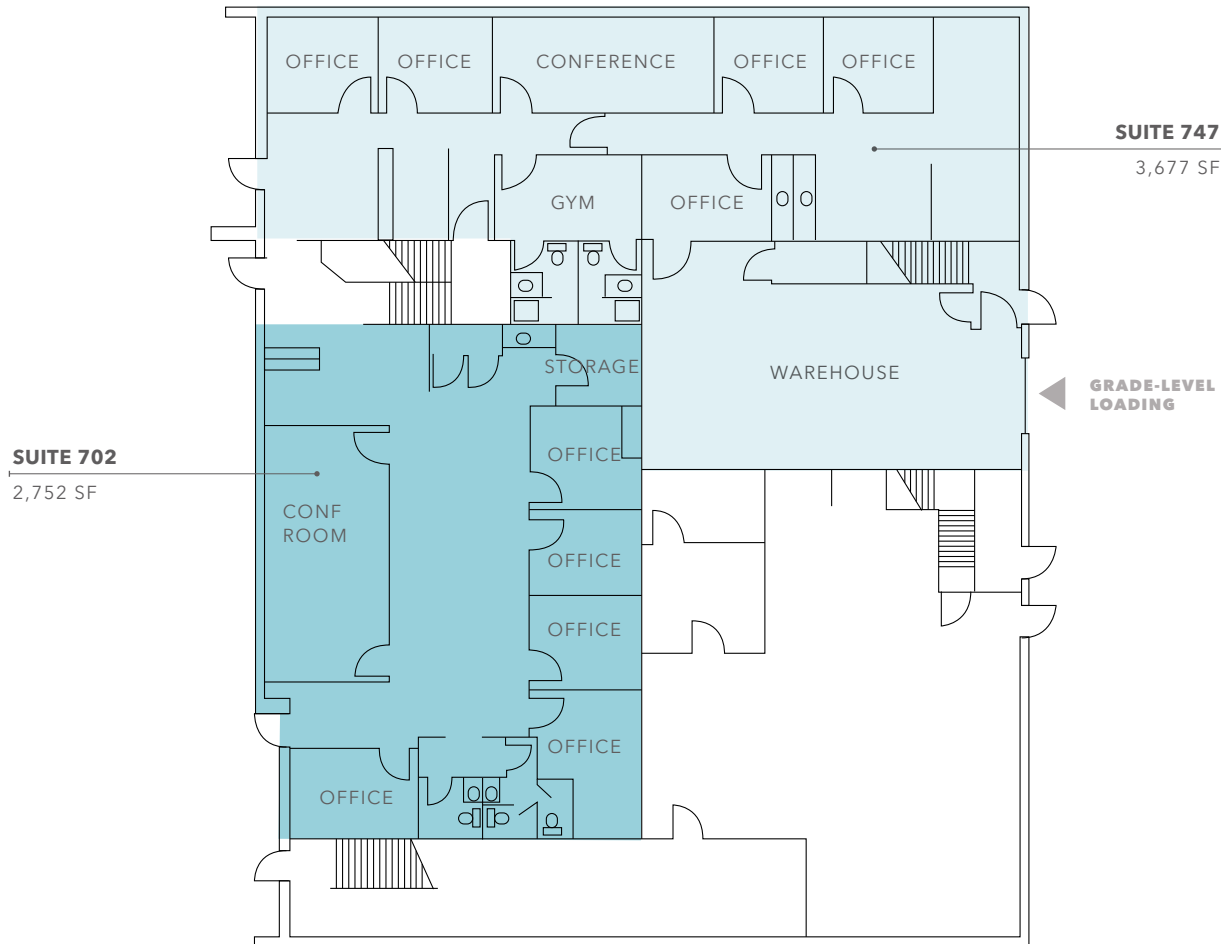

First-floor office spaces available

SUITE 702: 2,752 SF (all office)

SUITE 747: 3,677 SF total
(2,552 SF office / 1,125 SF warehouse)

SUITES 702 + 747: Can be combined for 6,429 SF total
(5,304 SF office / 1,125 SF warehouse)

FURNITURE available

PART of two building business park, providing opportunity for easy expansion of office and office/warehouse space

JASON BLOOM

425.450.1102

jason.bloom@kidder.com

TODD GAUTHIER

425.450.1118

todd.gauthier@kidder.com

KIDDER.COM

This information supplied herein is from sources we deem reliable. It is provided without any representation, warranty, or guarantee, expressed or implied as to its accuracy. Prospective Buyer or Tenant should conduct an independent investigation and verification of all matters deemed to be material, including, but not limited to, statements of income and expenses. Consult your attorney, accountant, or other professional advisor.

km Kidder Mathews

Woodinville Amenities

EAT + DRINK

- 1 Horseshoe Saloon
- 2 Twisted Cuban Cafe & Bar
- 3 Woodinville Cut Shop Restaurant and Lounge
- 4 Jack in the Box
- 5 Irene Thai Cuisine
- 6 Walla Walla Steak Co
- 7 Taco Bell
- 8 The Pizza Coop & Ale House
- 9 Pho 175
- 10 Panera Bread
- 11 Chipotle Mexican Grill
- 12 Red Robin
- 13 Teddy's Bigger Burgers
- 14 Woodinville Cafe
- 15 Topsy Cow
- 16 Jersey Mike's Subs
- 17 McDonald's
- 18 Pasta Novo Italiano
- 19 Chan's Place

RETAIL & SERVICES

- 1 Home Depot
- 2 24 Hour Fitness
- 3 Target
- 4 World Market
- 5 Barnes & Noble
- 6 Party City
- 7 TJ Maxx
- 8 Rite Aid

WINERIES & BREWERIES

- 1 Black Raven Brewery
- 2 Woodinville Wine Cellars
- 3 Two Vintners
- 4 20 Corners Brewing
- 5 Hopheads Taproom
- 6 Martedi Winery
- 7 Stomani Cellars
- 8 Matthews Winery
- 9 The Woodhouse Wine Estates
- 10 Sumerian Brewing Company

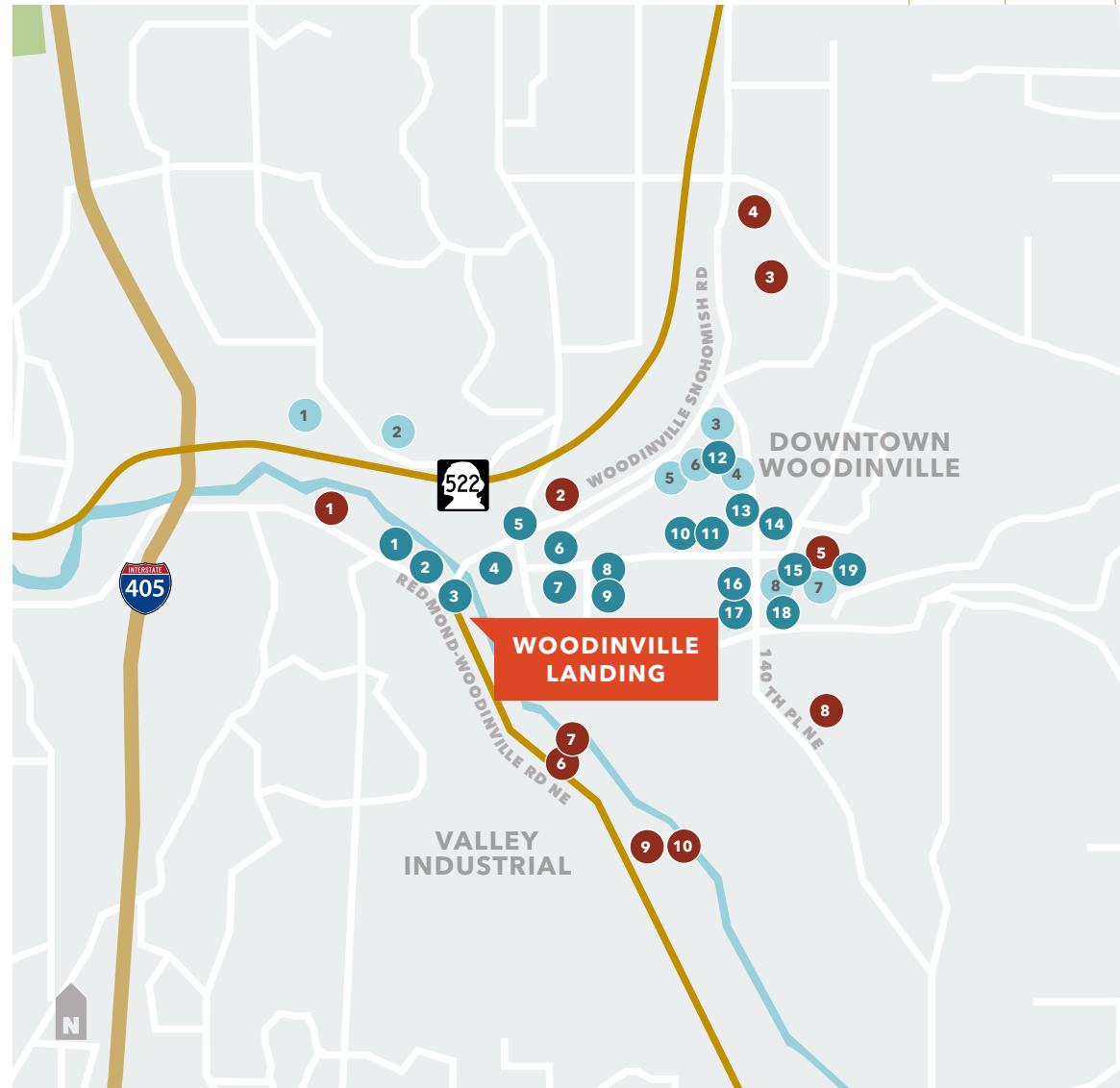

KIDDER.COM

This information supplied herein is from sources we deem reliable. It is provided without any representation, warranty, or guarantee, expressed or implied as to its accuracy. Prospective Buyer or Tenant should conduct an independent investigation and verification of all matters deemed to be material, including, but not limited to, statements of income and expenses. Consult your attorney, accountant, or other professional advisor.

