



**FOR  
SUBLEASE**

# Open House November 15th 11:30am-1:30 PM

THEO CHOCOLATE MIXED-USE BUILDING 3400 PHINNEY AVE, SEATTLE, WA



**HIGH QUALITY** Landlord + Sublandlord

**16** parking stalls on site

**SUBLEASE** through 12/31/25 -Longer Lease Term available

**GOOD POWER** and distribution  
277/480 volt, 3 phase, 1200 amps

**PARTIAL** building HVAC and security system service

**22'** clear height

**2 GRADE** level loading doors

**EXTERIOR** signage negotiable

**SPACE INCLUDES:** warehouse, commercial kitchen, retail, office

**ADJACENT** to Burke Gilman trail

**THICK** concrete slab supports heavy floor loads

## 29,282 SF

**FULL BUILDING (DIVISIBLE)**

\* Available 30 days notice, divisible



**99 BIKE  
SCORE**



**92 WALK  
SCORE**

**TODD BATTISON**

206.296.9621

[todd.battison@kidder.com](mailto:todd.battison@kidder.com)

**DAN MATHEWS**

206.406.3003

[dan.mathews@kidder.com](mailto:dan.mathews@kidder.com)

[KIDDER.COM](http://KIDDER.COM)

# Kidder Mathews

This information supplied herein is from sources we deem reliable. It is provided without any representation, warranty, or guarantee, expressed or implied as to its accuracy. Prospective Buyer or Tenant should conduct an independent investigation and verification of all matters deemed to be material, including, but not limited to, statements of income and expenses. Consult your attorney, accountant, or other professional advisor.

**FOR SUBLEASE**

# Theo Chocolate Mixed Use Building

3400 PHINNEY AVE, SEATTLE, WA

## Full Building

29,282 SF

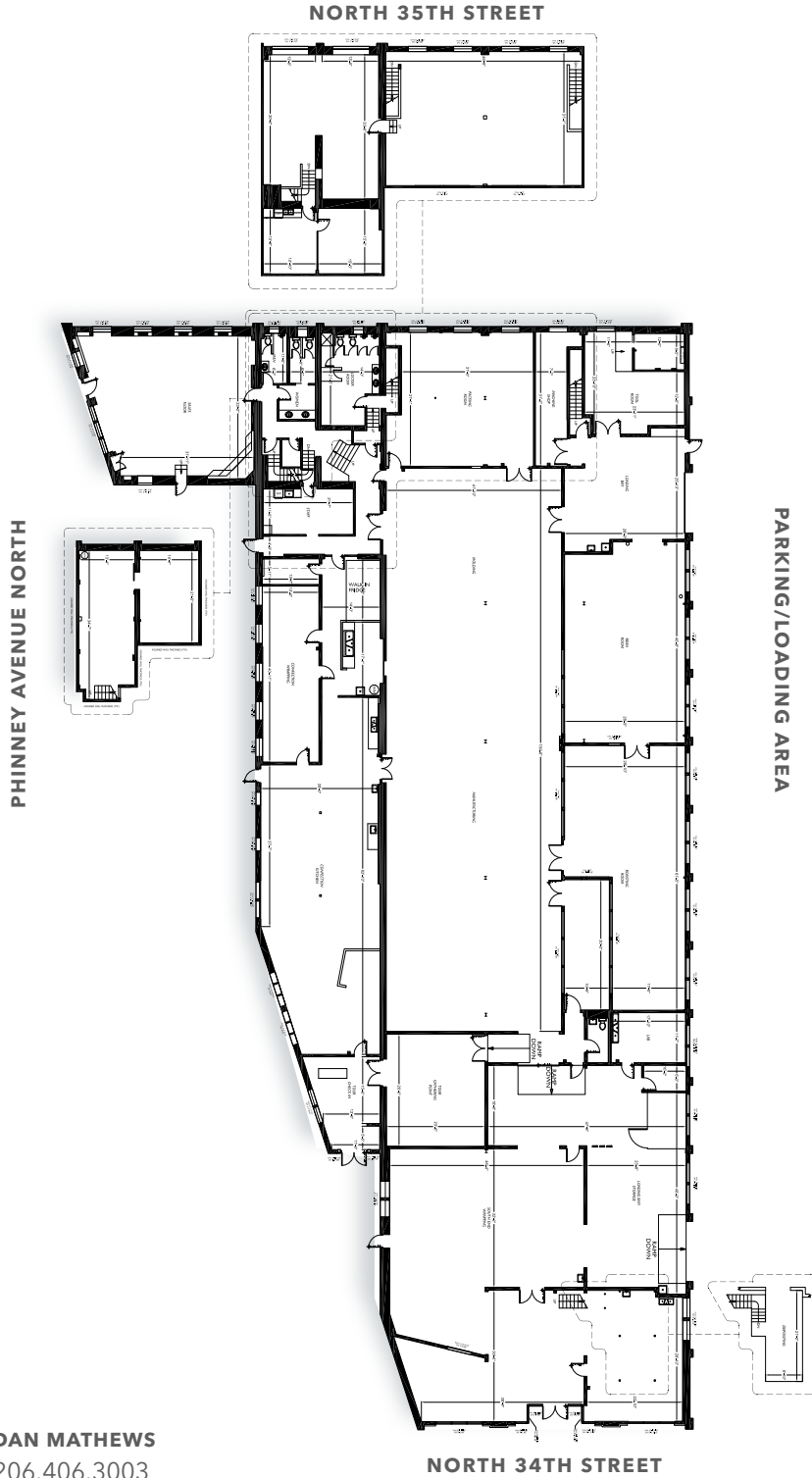

**TODD BATTISON**  
206.296.9621  
[todd.battison@kidder.com](mailto:todd.battison@kidder.com)

**DAN MATHEWS**  
206.406.3003  
[dan.mathews@kidder.com](mailto:dan.mathews@kidder.com)

**KIDDER.COM**

This information supplied herein is from sources we deem reliable. It is provided without any representation, warranty, or guarantee, expressed or implied as to its accuracy. Prospective Buyer or Tenant should conduct an independent investigation and verification of all matters deemed to be material, including, but not limited to, statements of income and expenses. Consult your attorney, accountant, or other professional advisor.



FOR SUBLEASE

# Theo Chocolate Mixed Use Building

3400 PHINNEY AVE, SEATTLE, WA



**TODD BATTISON**  
206.296.9621  
[todd.battison@kidders.com](mailto:todd.battison@kidders.com)

**DAN MATHEWS**  
206.406.3003  
[dan.mathews@kidders.com](mailto:dan.mathews@kidders.com)

**KIDDER.COM**

This information supplied herein is from sources we deem reliable. It is provided without any representation, warranty, or guarantee, expressed or implied as to its accuracy. Prospective Buyer or Tenant should conduct an independent investigation and verification of all matters deemed to be material, including, but not limited to, statements of income and expenses. Consult your attorney, accountant, or other professional advisor.

