



# Washington Machine Building

5201 1ST AVENUE SOUTH, SUITE C, SEATTLE, WA

## FOR LEASE



**Kidder  
Mathews**

**JIM KIDDER, SIOR**  
206.248.7328  
[jim.kidder@kidder.com](mailto:jim.kidder@kidder.com)

**NICK RAMIREZ**  
206.248.6521  
[nick.ramirez@kidder.com](mailto:nick.ramirez@kidder.com)

This information supplied herein is from sources we deem reliable. It is provided without any representation, warranty, or guarantee, expressed or implied as to its accuracy. Prospective Buyer or Tenant should conduct an independent investigation and verification of all matters deemed to be material, including, but not limited to, statements of income and expenses. Consult your attorney, accountant, or other professional advisor.

**FOR LEASE**

# Washington Machine Building

5201 1ST AVENUE SOUTH, SUITE B, SEATTLE, WA



[KIDDER.COM](https://www.kidder.com)

This information supplied herein is from sources we deem reliable. It is provided without any representation, warranty, or guarantee, expressed or implied as to its accuracy. Prospective Buyer or Tenant should conduct an independent investigation and verification of all matters deemed to be material, including, but not limited to, statements of income and expenses. Consult your attorney, accountant, or other professional advisor.

 **Kidder  
Mathews**

**FOR LEASE**

# Washington Machine Building

5201 1ST AVENUE SOUTH, SUITE C, SEATTLE, WA

## Suite C: Floor Plan

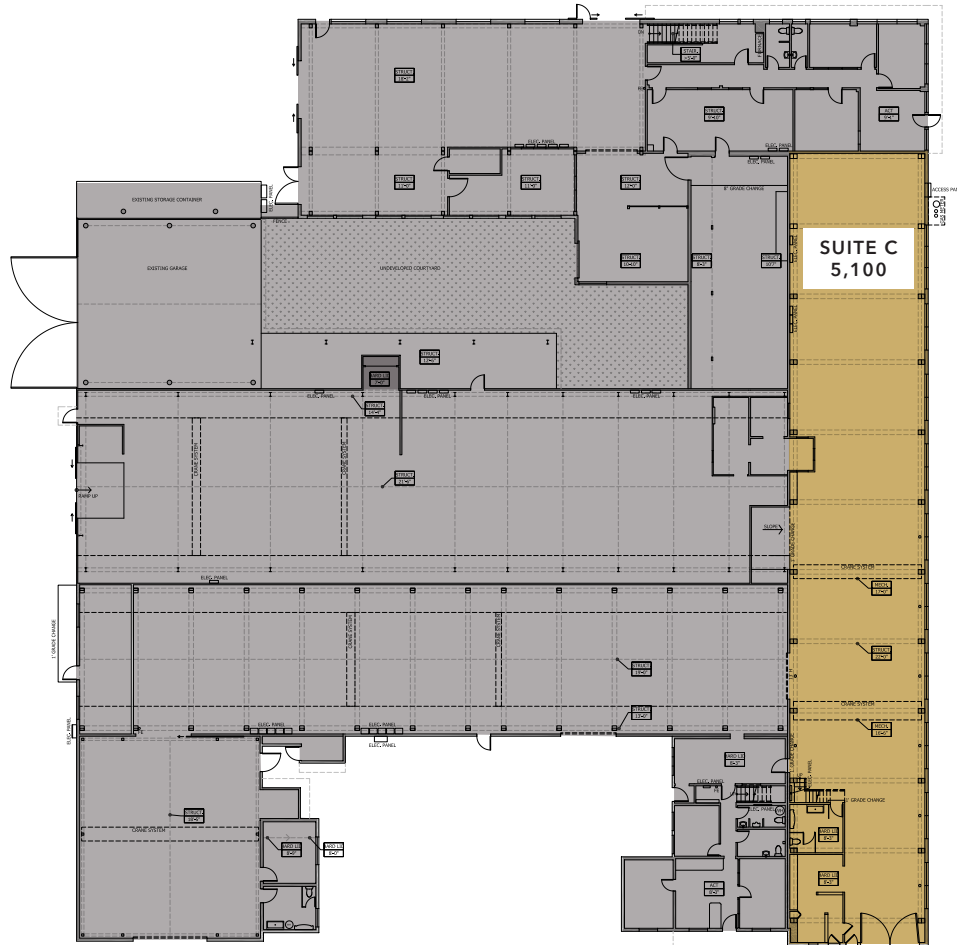

## SUITE C

SHOP/SHOWROOM

# 5,100

SQUARE FEET

# NOW

AVAILABLE

# ABUNDANT

NATURAL LIGHT

**JIM KIDDER, SIOR**

206.248.7328

[jim.kidder@kidder.com](mailto:jim.kidder@kidder.com)

**NICK RAMIREZ**

206.248.6521

[nick.ramirez@kidder.com](mailto:nick.ramirez@kidder.com)

[KIDDER.COM](http://KIDDER.COM)

This information supplied herein is from sources we deem reliable. It is provided without any representation, warranty, or guarantee, expressed or implied as to its accuracy. Prospective Buyer or Tenant should conduct an independent investigation and verification of all matters deemed to be material, including, but not limited to, statements of income and expenses. Consult your attorney, accountant, or other professional advisor.



FOR LEASE

# Washington Machine Building

5201 1ST AVENUE SOUTH, SUITE C, SEATTLE, WA



KIDDER.COM

This information supplied herein is from sources we deem reliable. It is provided without any representation, warranty, or guarantee, expressed or implied as to its accuracy. Prospective Buyer or Tenant should conduct an independent investigation and verification of all matters deemed to be material, including, but not limited to, statements of income and expenses. Consult your attorney, accountant, or other professional advisor.

**km** Kidder Mathews