

FOR SUBLEASE

# 212TH SUBLEASE

12,500 SF + 1.74 Acres | 5801 S 212th St, Kent, WA



**NEWMARK**

**TAYLOR HOFF, SIOR**  
taylor.hoff@nmrk.com  
425-362-1388

**MORGAN RICHEY**  
morgan.richey@nmrk.com  
425-362-1409

# FOR SUBLEASE

## 212TH SUBLEASE

12,500 SF + 1.74 Acres | 5801 S 212th St, Kent, WA

### FLOOR PLAN

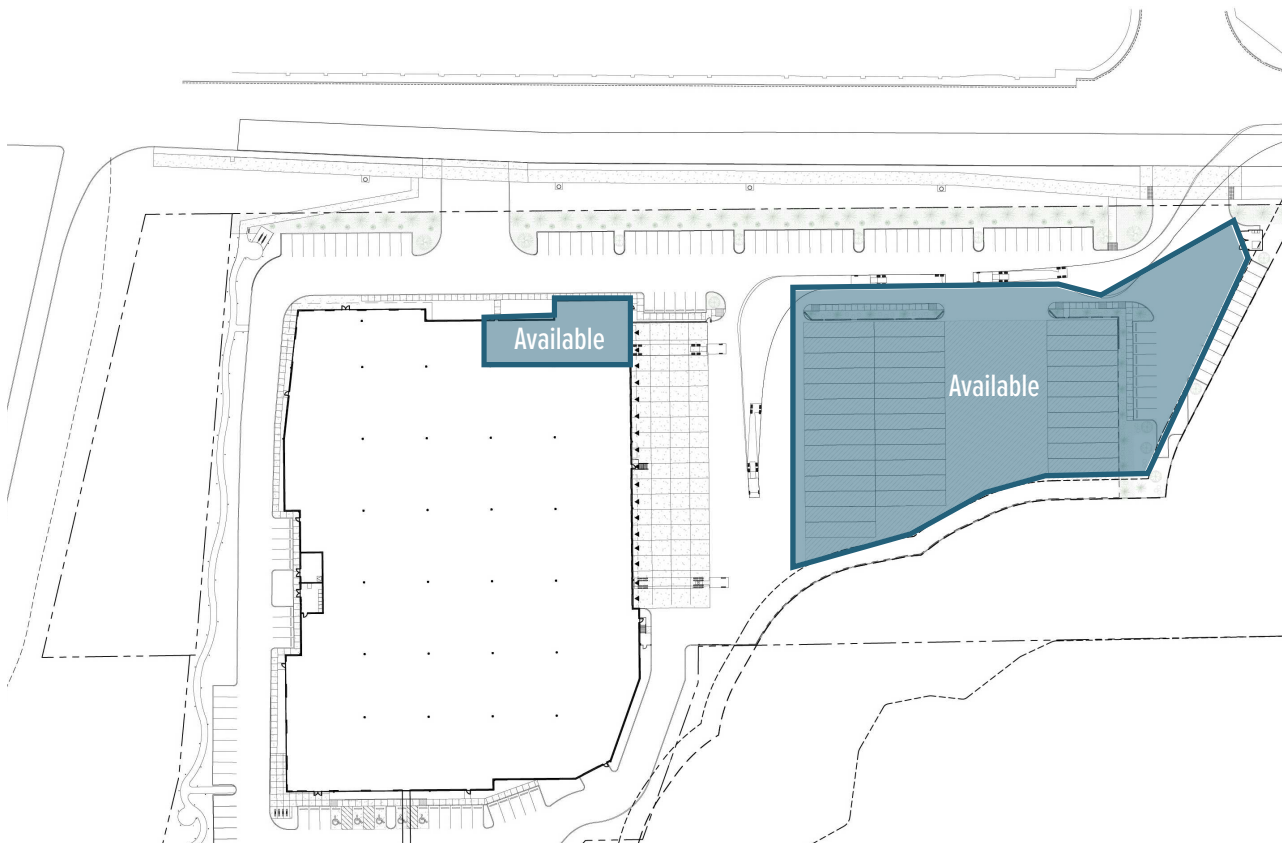

### BUILDING DETAILS

**TOTAL SF**

12,500 SF (warehouse only)

**TOTAL LAND AC**

1.74 Acres

**CLEAR HEIGHT**

40'

**LOADING**

3 Dock High Doors

1 Grade Level Door (oversized)

### PROPERTY HIGHLIGHTS

- Available Now
- Building and Land can be leased together or separate
- Paved, Fenced and Lights
- Fully Secured Site
- ESFR Sprinklers System
- LED Lights in Warehouse
- Racking Available
- Flexible Term Options

FOR SUBLEASE

# 212TH SUBLEASE

12,500 SF + 1.74 Acres | 5801 S 212th St, Kent, WA

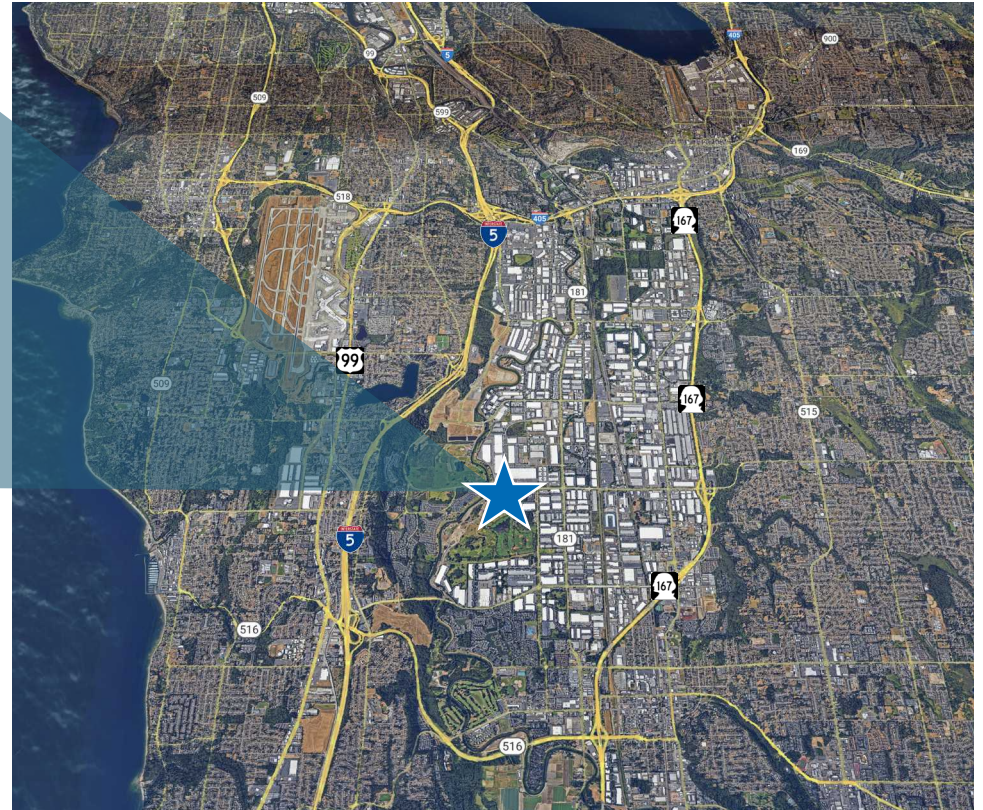

The information contained herein has been obtained from sources deemed reliable but has not been verified and no guarantee, warranty or representation, either express or implied, is made with respect to such information. Terms of sale or lease and availability are subject to change or withdrawal without notice.