



31,678 SF industrial SUBLEASE
SUBLEASE term through July 2027



SODO ROW

4786 1st Ave S

Seattle, WA

Chris Spofford
+1 425 890 6961
chris.spofford@jll.com

Clay Nielsen
+1 206 790 3368
clay.nielsen@jll.com

Although information has been obtained from sources deemed reliable, JLL does not make any guarantees, warranties or representations, express or implied, as to the completeness or accuracy as to the information contained herein. Any projections, opinions, assumptions or estimates used are for example only. There may be differences between projected and actual results, and those differences may be material. JLL does not accept any liability for any loss or damage suffered by any party resulting from reliance on this information. If the recipient of this information has signed a confidentiality agreement with JLL regarding this matter, this information is subject to the terms of that agreement. ©2020. Jones Lang LaSalle IP, Inc. All rights reserved.

Floor Plan - Bay 5

31,678 SF industrial SUBLEASE
SUBLEASE term through July 2027

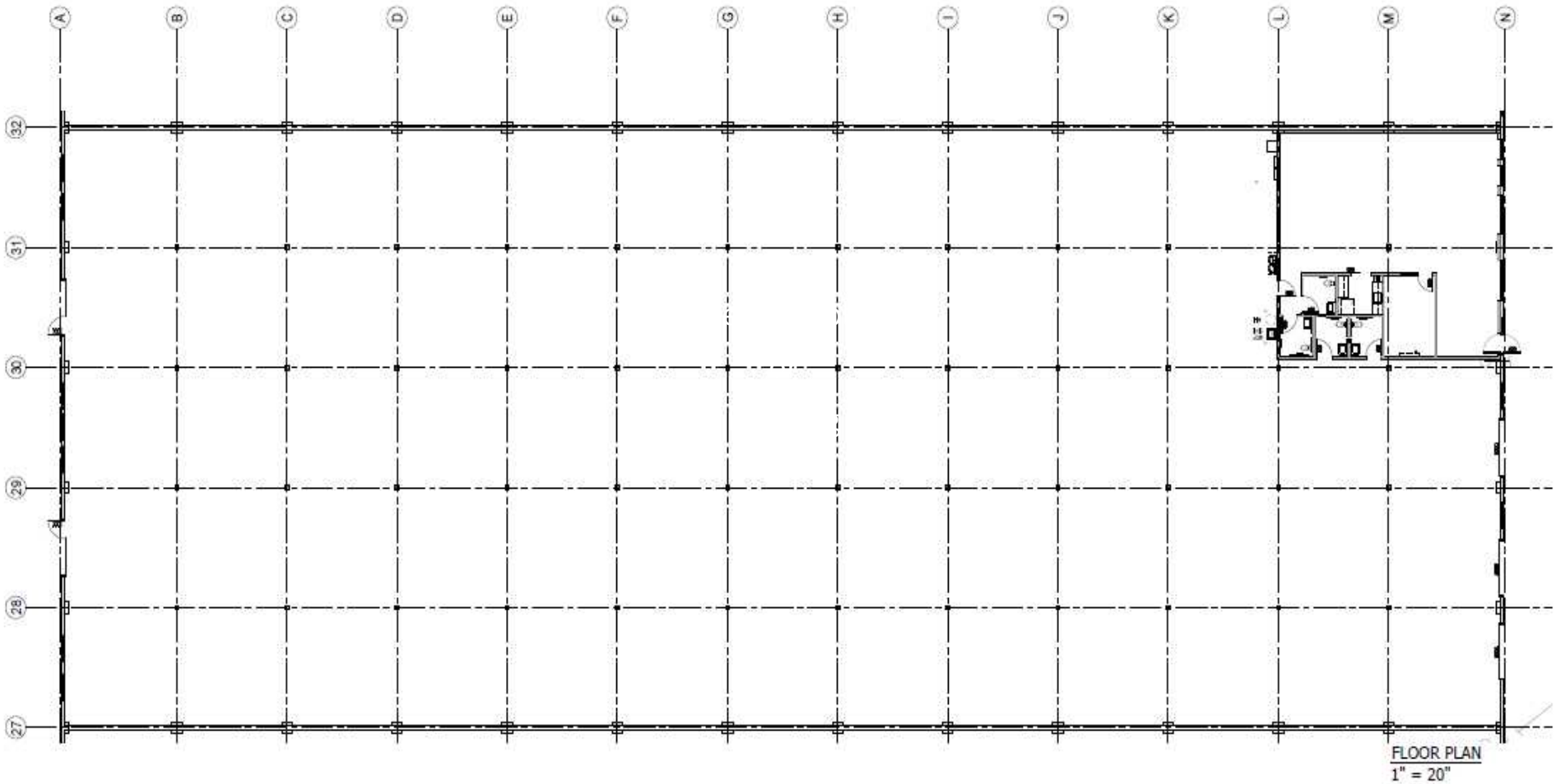

31,678
Space available



1,898
Office available



22' X 22'
Column spacing



15'
Clear Height

Drive times

Easy Access to HWY 99
Easy Access to I-5 and I-5

Drive time to nearby cities

Eastside	15 minutes
Downtown Seattle	7 minutes
Port of Tacoma	35 minutes

Nearby Amenities

- Seattle Cider Company
- Costco
- Starbucks
- Two Beers Brewing Co
- Slims Last Chance
- Subway
- Marco Polo Bar & Grill
- Dog House Bar & Grill

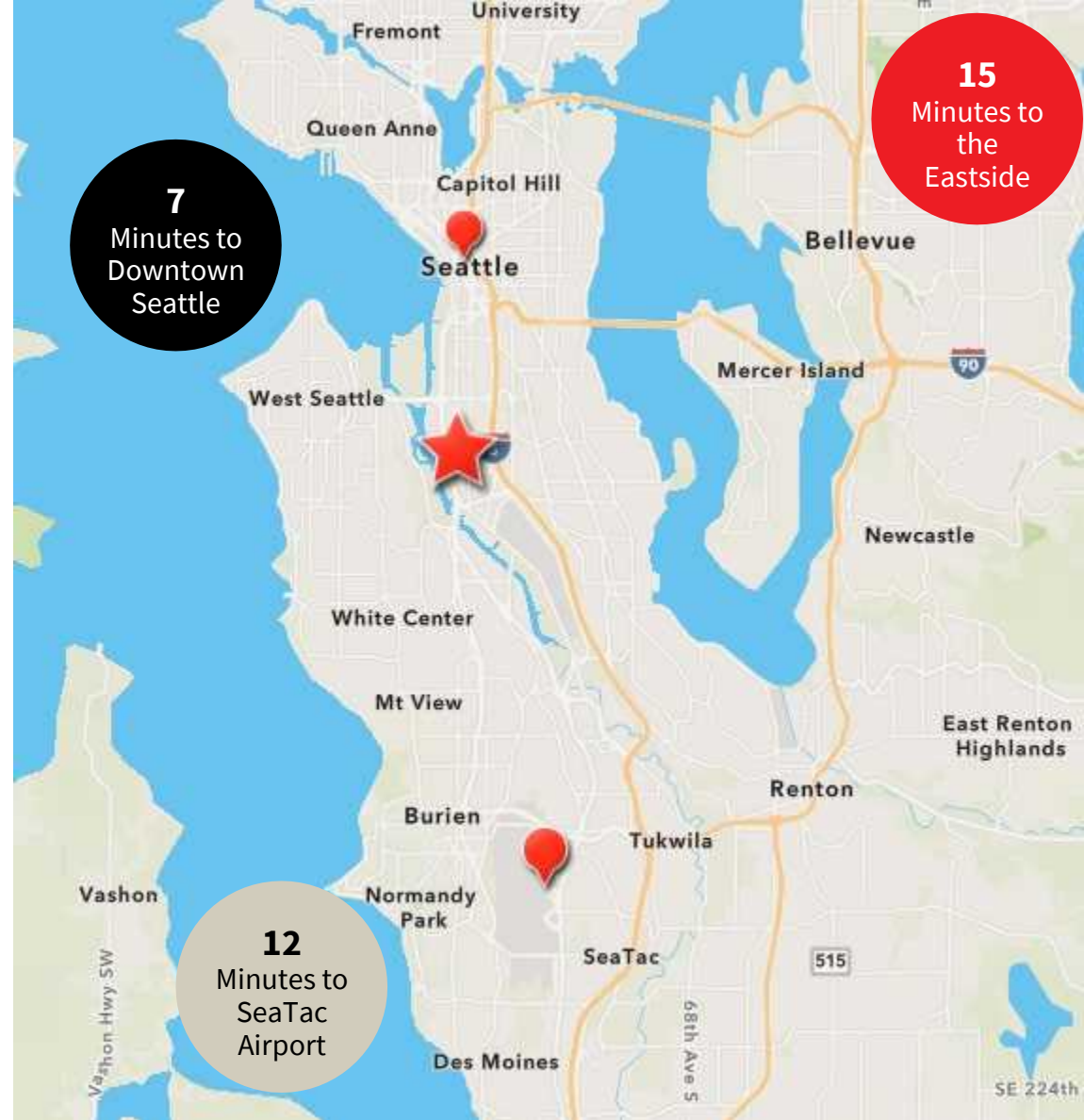

12 Minutes

to
SeaTac Airport



35 Minutes

to
Port of Tacoma



7 Minutes

to
Downtown Seattle