



Met Park West

1100 Olive Way
Seattle, WA 98101

Sublease Available

Floor 16: 20,965 RSF

LED: 12/31/2025

Clay Nielsen

+1 206 790 3368

clay.nielsen@jll.com

Jones Lang LaSalle Brokerage, Inc. © 2023 Jones Lang LaSalle IP, Inc. All rights reserved. All information contained herein is from sources deemed reliable; however, no representation or warranty is made to the accuracy thereof.

Project Highlights

Floor 16: 20,965

Building Highlights

- 01 • Year built: 1980 (Renovated 2000)
- Stories: 18
- Elevators: Seven upgraded Westinghouse elevators
- Met Club: Conference centers and large catering kitchen
- On-Site Wellness Program
- On-Site Dining
- 24 Hour Fitness across the street
- Showers on-site
- Secure bike storage with repair station
- Outdoor courtyard
- Excellent transportation via bus, light rail and car
- 97 Walk score
- 100 Transit score
- Convenient access to I-5 North and South
- 1/1,000 SF ratio
- \$336.00/Stall/Month



Floor 16

20,965 RSF

LED: 12/31/2025

Click to
virtual tour

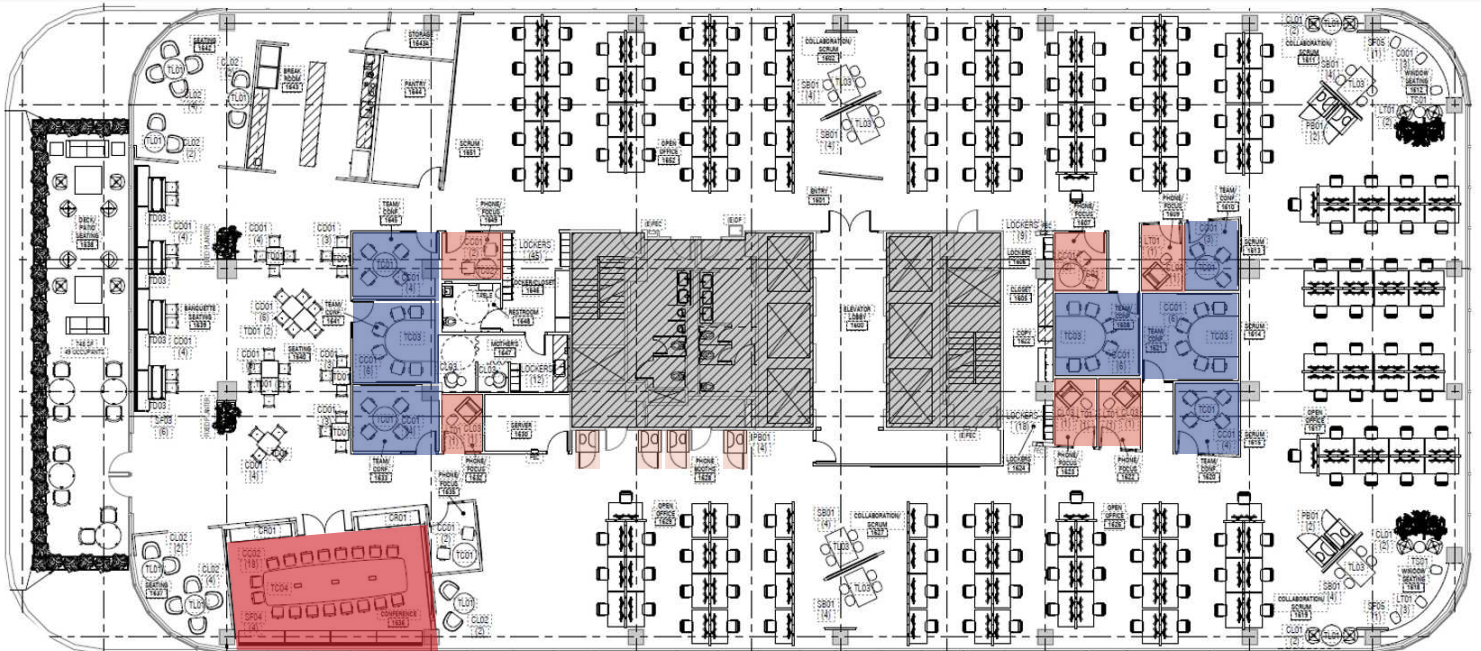

As Built



(1) Large Conference Room
(6) Collaboration Spaces



(7) Meeting Rooms
(6) Phone Rooms
(4) Phone Booths



Open Seating Plan (162 Seats)