



TRAILSIDE II

@ University Village

4907 25th Avenue NE
Seattle, WA 98105





Trailside Community

@ University Village

Approximate Seattle's Only Outdoor Lifestyle Shopping Center

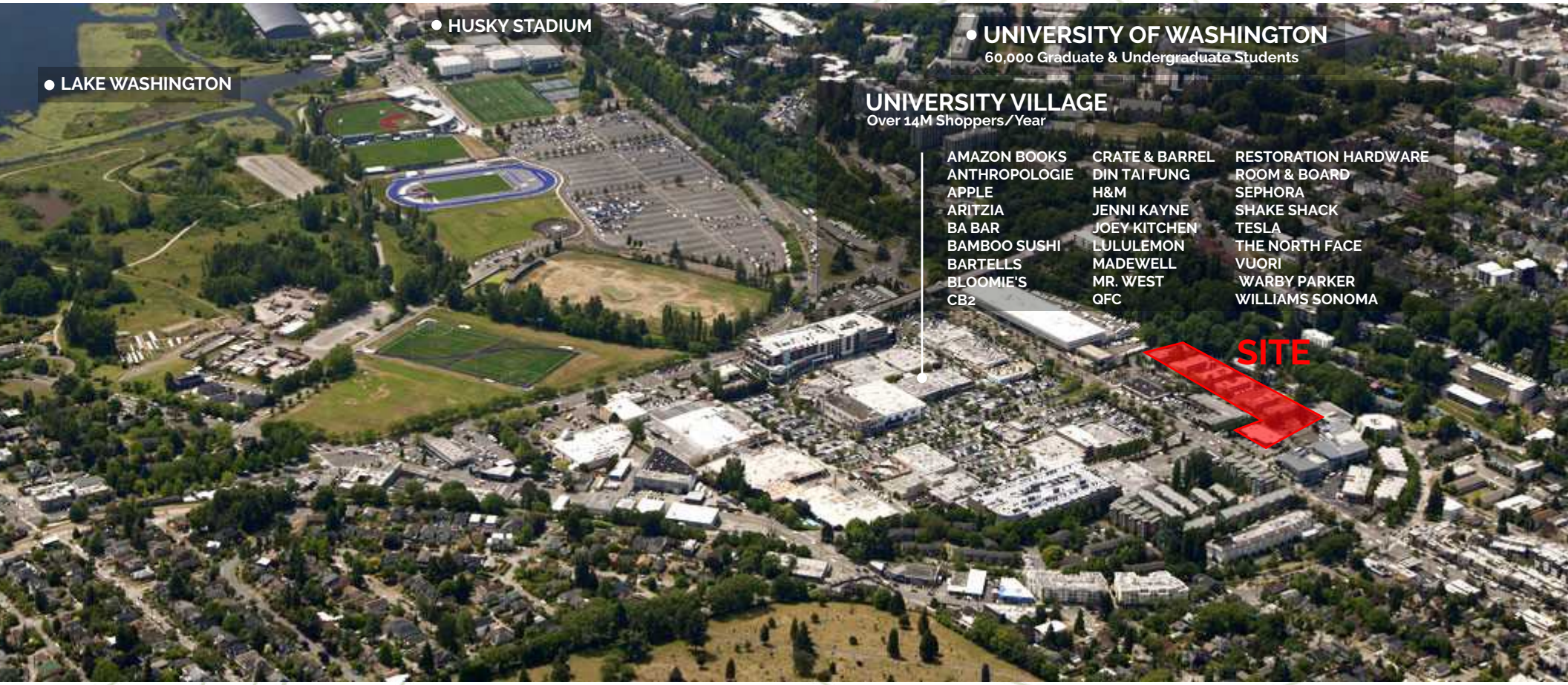

● HUSKY STADIUM

● LAKE WASHINGTON

● UNIVERSITY OF WASHINGTON

60,000 Graduate & Undergraduate Students

UNIVERSITY VILLAGE

Over 14M Shoppers/Year

AMAZON BOOKS
ANTHROPOLOGIE
APPLE
ARITZIA
BA BAR
BAMBOO SUSHI
BARTELLS
BLOOMIE'S
CB2

CRATE & BARREL
DIN TAI FUNG
H&M
JENNI KAYNE
JOEY KITCHEN
LULULEMON
MADEWELL
MR. WEST
QFC

RESTORATION HARDWARE
ROOM & BOARD
SEPHORA
SHAKE SHACK
TESLA
THE NORTH FACE
VUORI
WARBY PARKER
WILLIAMS SONOMA

SITE



Mr. West Café



Apple



Ba Bar



Restoration Hardware Gallery

TS Project Details

Trailside II at University Village is located on the Burke Gilman Trail across the street from University Village and just east of the University of Washington. This dynamic location offers retailers and food and beverage operators a rare opportunity to locate in an exceptional-demographic neighborhood and one of the tightest retail markets in Seattle. Join more than 120 nationally and locally recognized retailers at University Village including Apple, Crate & Barrel, Din Tai Fung, Joey Kitchen, Restoration Hardware Gallery, Room & Board, Sephora and many more in the neighborhood.

Size.....4,129 SF (Divisible)

RentCall For Rates

NNN's\$15.00 PSF

Availability Q4 2025

Total Site Population 435 Units/1,366 Beds

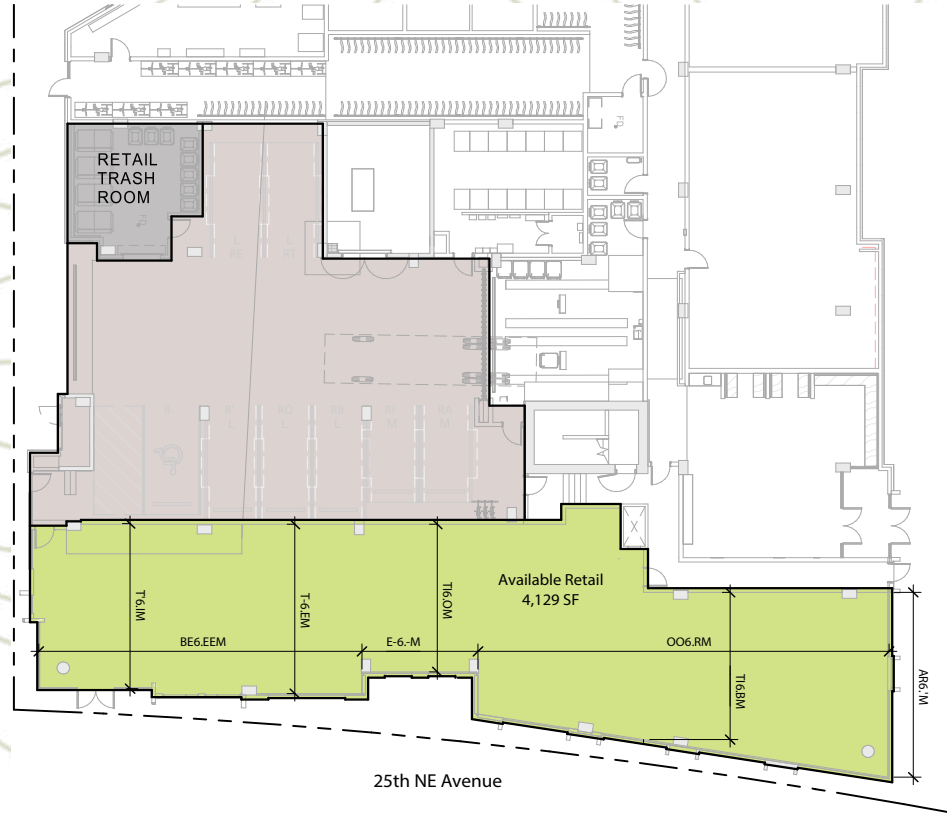

Total on-site population will be 1,366 students once complete.





University Village

DEMOGRAPHIC SUMMARY

10 MINUTE DRIVE DEMOS

RESIDENTS 119,822
 AVG HH INCOME \$190,423
 EMPLOYEES 38,305

BURKE GILMAN TRAIL

Provides direct connection from the Burke-Gilman Trail to University Village's new pedestrian and bike entrance.

REAL RETAIL

ANDREW MILLER
 206.818.3629
 amiller@real-retail.net

KATIE PARSONS WATERS
 425.736.5262
 katie@real-retail.net

This information supplied herein has been secured from sources believed to be reliable; however, no representations are made to its accuracy. Prospective tenants or buyers should consult their professional advisors and conduct their own independent investigation. Properties are subject to change in price and/or availability without notice.



TS Site Plan

Unique Location on the Burke-Gilman Trail

Spanning nearly 19 miles between Seattle and Bothell, the Burke-Gilman Trail is as much a thoroughfare for commuting to work and commuting to the University of Washington as it is a staple for social recreation and fitness. The Trail Connector will provide direct connection from the Burke-Gilman Trail to University Village's new pedestrian and bike entrance next to Restoration Hardware Gallery.

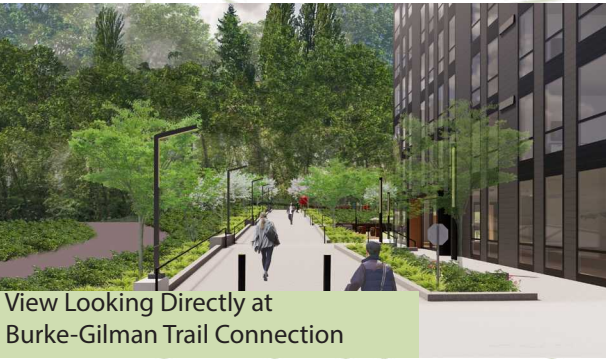

View Looking Directly at Burke-Gilman Trail Connection



Provides direct connection from the Burke-Gilman Trail to University Village's new pedestrian and bike entrance.



REAL RETAIL

ANDREW MILLER
206.818.3629
amiller@real-retail.net

KATIE PARSONS WATERS
425.736.5262
katie@real-retail.net

This information supplied herein has been secured from sources believed to be reliable; however, no representations are made to its accuracy. Prospective tenants or buyers should consult their professional advisors and conduct their own independent investigation. Properties are subject to change in price and/or availability without notice.