

For Lease

7214 26TH ST E, SUITE 101

*±8,453 SF Warehouse
with Office Space
Available for Lease in Fife*

FIFE, WA



7214 26TH ST E, SUITE 101



YEAR BUILT	2010
TOTAL BUILDING SF	8,453
OFFICE SF	700
LOADING	2 DH, 1 GL
CLEAR HEIGHT	18'
POWER	200 amps of 277/480 volt power
ZONING	I (Industrial)
AVAILABILITY	Now
RATES	\$1.15 shell / \$1.35 office add-on, NNN

8,453 SF
AVAILABLE

18'
CLEAR HEIGHT

SUITE 101 FLOOR PLAN

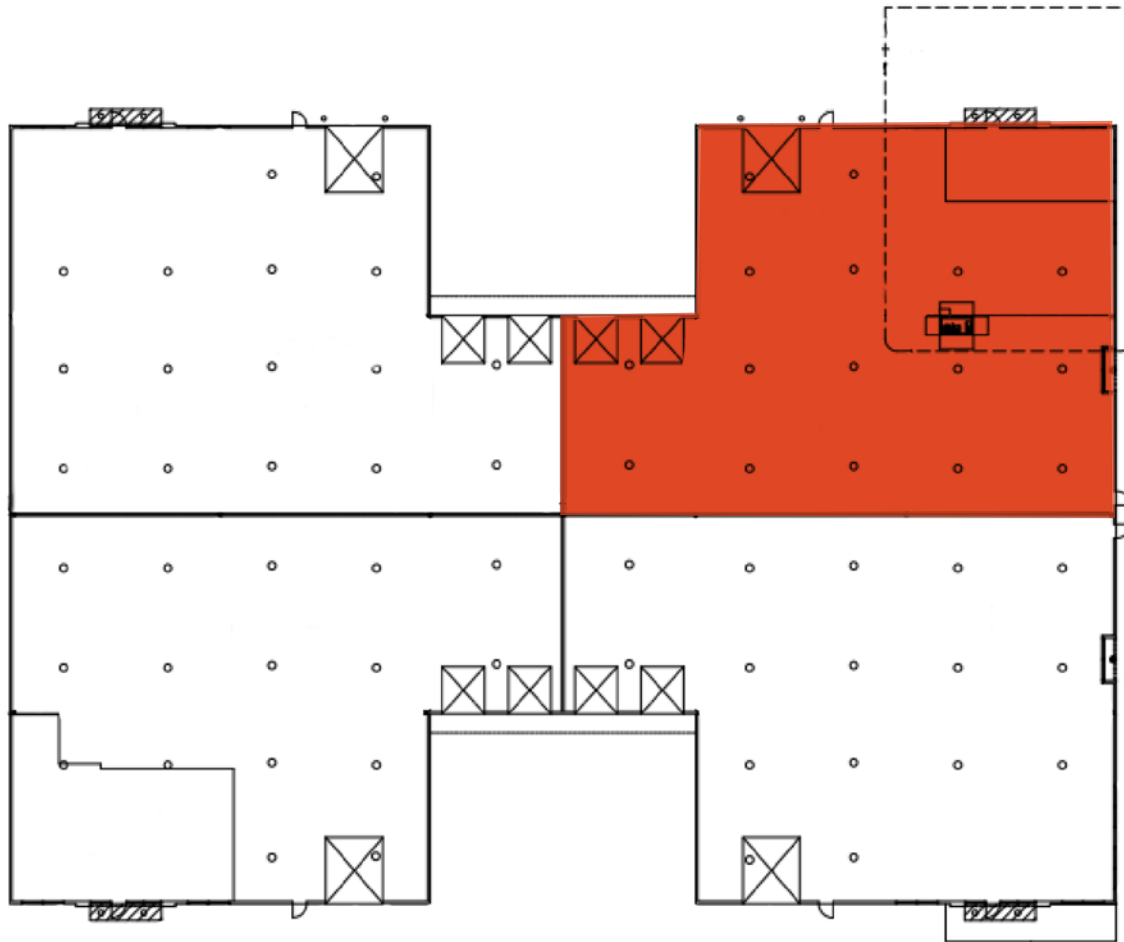

8,453 SF

AVAILABLE

700 SF

OFFICE AVAILABLE

JAN 2024

AVAILABLE



HIGHLY- ACCESSIBLE LOCATION

Close to Port of Tacoma, downtown CBD

Located near major confluences Interstate 5
and Highway 99

Easy for visitors to locate

13 MIN
PORT OF TACOMA

14 MIN
TACOMA CBD



7214 26TH ST E

Exclusively leased by

PETER WOODING

206.248.7301

peter.wooding@kidder.com

KIDDER.COM

This information supplied herein is from sources we deem reliable. It is provided without any representation, warranty, or guarantee, expressed or implied as to its accuracy. Prospective Buyer or Tenant should conduct an independent investigation and verification of all matters deemed to be material, including, but not limited to, statements of income and expenses. Consult your attorney, accountant, or other professional advisor.

