



LABCORP BUILDING

110 W. Cliff Drive
Spokane, Washington 99204

ERIK NELSON, MANAGING BROKER
509.755.7514
erik.nelson@kiemlehagood.com

**KIEMLE
HAGOOD**

OVERVIEW & LOCATION

LabCorp Building

OFFICE
FOR LEASE



VIEW
LOCATION



\$13.00 PSF

PROPERTY OVERVIEW

Parcel Number	35194.2129
Total Building Size	±70,274 SF
Total Site	±134,329 SF (±3.08 ac)
Year Built	1970 / 2001

LEASE DETAILS

Total Space Available	±19,878 RSF (Suites 410, 420, 430)
Lease Rate	\$13.00 PSF, NNN
NNN Expenses	\$TBD



AVAILABLE SPACE

LabCorp Building

OFFICE
FOR LEASE
4TH FLOOR

SUITE #410

Rate | \$13.00 PSF, NNN

RSF | ±5,754 SF

CAN BE COMBINED FOR ±19,878 SF

SUITE #420

Rate | \$13.00 PSF, NNN

RSF | ±4,578 SF

SUITE #430

Rate | \$13.00 PSF, NNN

RSF | ±9,546 SF

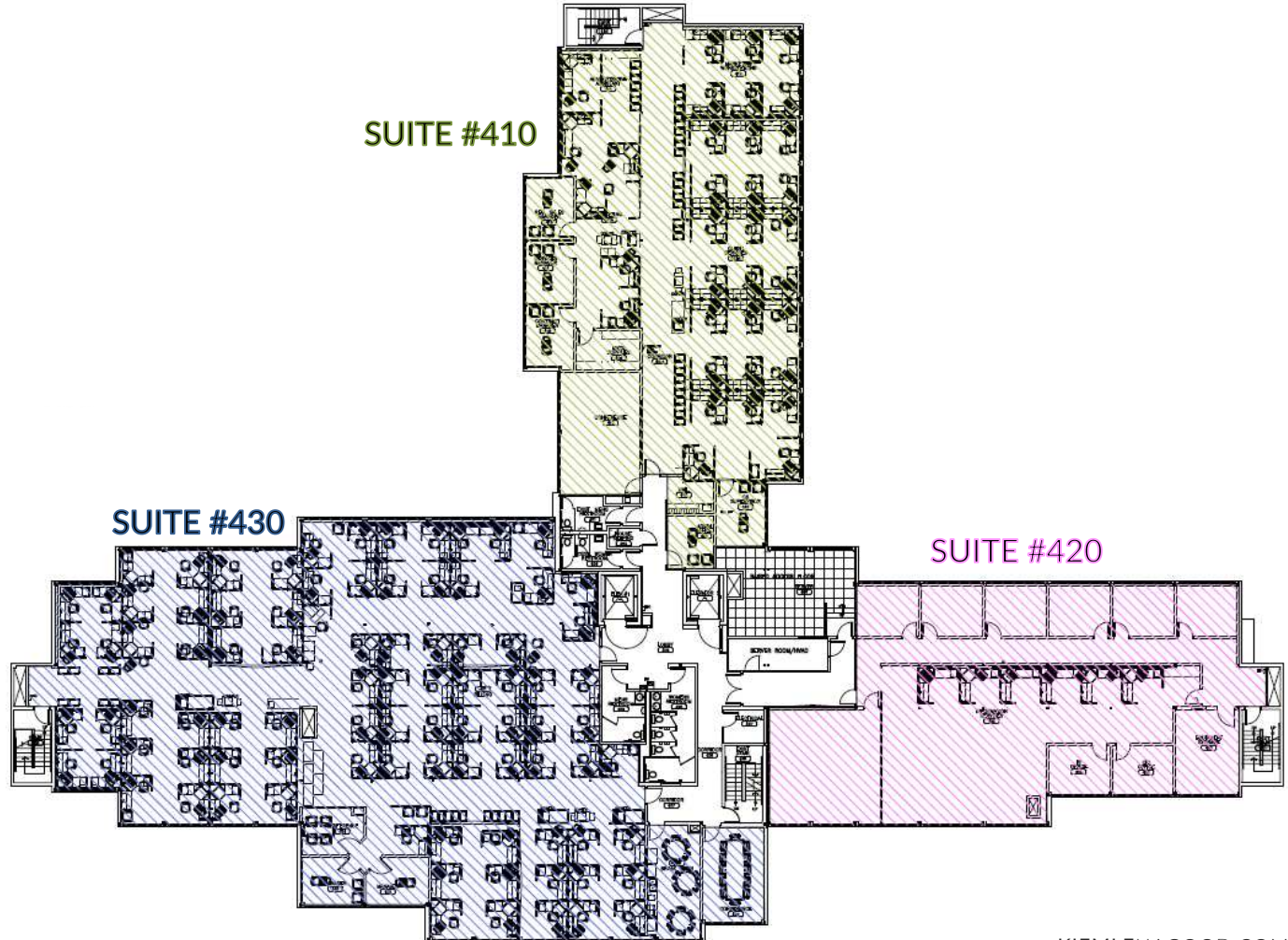

THE AREA

LabCorp Building

OFFICE
FOR LEASE

110 W. Cliff Dr has convenient access to Hwy 395 and I-90 and ample parking for clients and patients. The property is located across the street from Providence Sacred Heart Medical Center and Children's Hospital, the largest advanced care medical facility between Seattle and Minneapolis.



LABCORP MEDICAL BUILDING

110 W. Cliff Drive
Spokane, Washington 99204

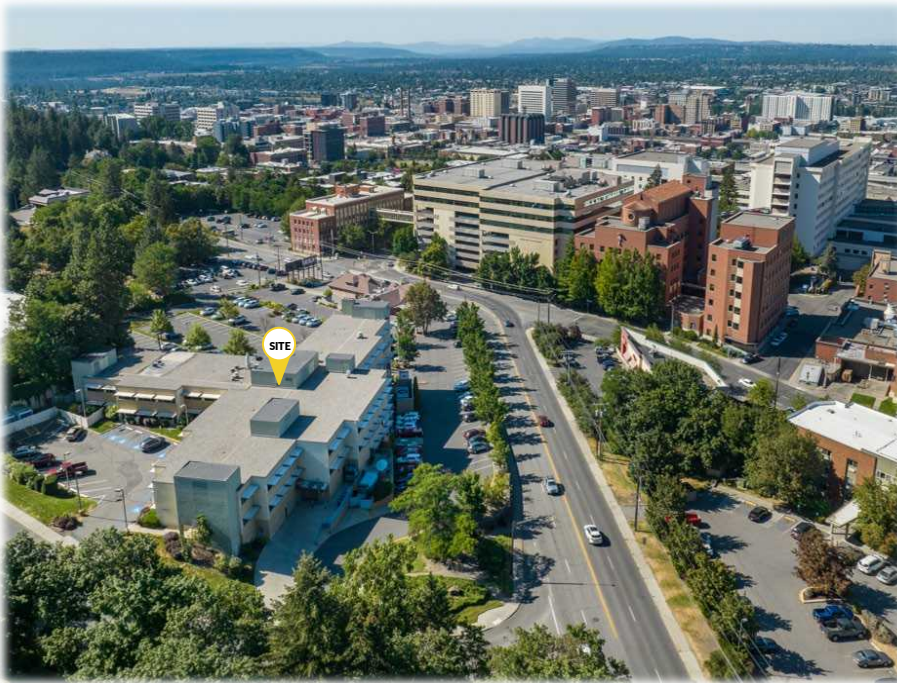

601 WEST MAIN AVENUE, SUITE 400 | SPOKANE, WA 99201

No warranty or representation, expressed or implied, is made by Kiemle Hagood, its agents or its employees as to the accuracy of the information contained herein. All information furnished is from sources deemed reliable and submitted subject to errors, omissions, change of terms and conditions, prior sale, lease or financing, or withdrawal without notice. No one should rely solely on the above information, but instead should conduct their own investigation to independently satisfy themselves.

Kiemle Hagood respects the intellectual property of others:

If you believe the copyright in your work has been violated through this Website, please contact our office for notice of claims of copyright infringement. For your complaint to be valid under the Digital Millennium Copyright Act of 1998 (DMCA), you must provide the following information when providing notice of the claimed copyright infringement: Identify the material on the Website that you believe infringes your work, with enough detail so that we may locate it on the Website; provide your address, telephone number and email address; provide a statement that you have a good faith belief that the disputed use is not authorized by the copyright owner, its agent, or the law; provide a statement that the information in the notification is accurate, and under penalty of perjury, that the complaining party is authorized to act on behalf of owner of an exclusive right that is allegedly infringed; provide your physical or electronic signature. Upon receiving your complaint, Kiemle Hagood will, upon review, remove content that you believe infringes your copyright if the complaint is found valid.

For more information on this opportunity:



ERIK NELSON, SIOR
MANAGING BROKER

D | 509.755.7514

erik.nelson@kiemle HAGOOD.com

**KIEMLE
HAGOOD**
CREATING REAL ESTATE SOLUTIONS 