

INDUSTRIAL LAND/BUILT TO SUIT FOR LEASE OR SALE  
**±12.1 AC GROSS/ ±9.2 AC USABLE (ESTIMATED) SITE**



- Site Development Plans Completed
- Zoning Allows for A Wide Variety of Industrial and Commercial Uses
- Property Can Support Up to 121,000 SF of Industrial Development

# BELFAIR INDUSTRIAL

**BELFAIR, WA 98528**

# PROPERTY HIGHLIGHTS



## SITE PLAN

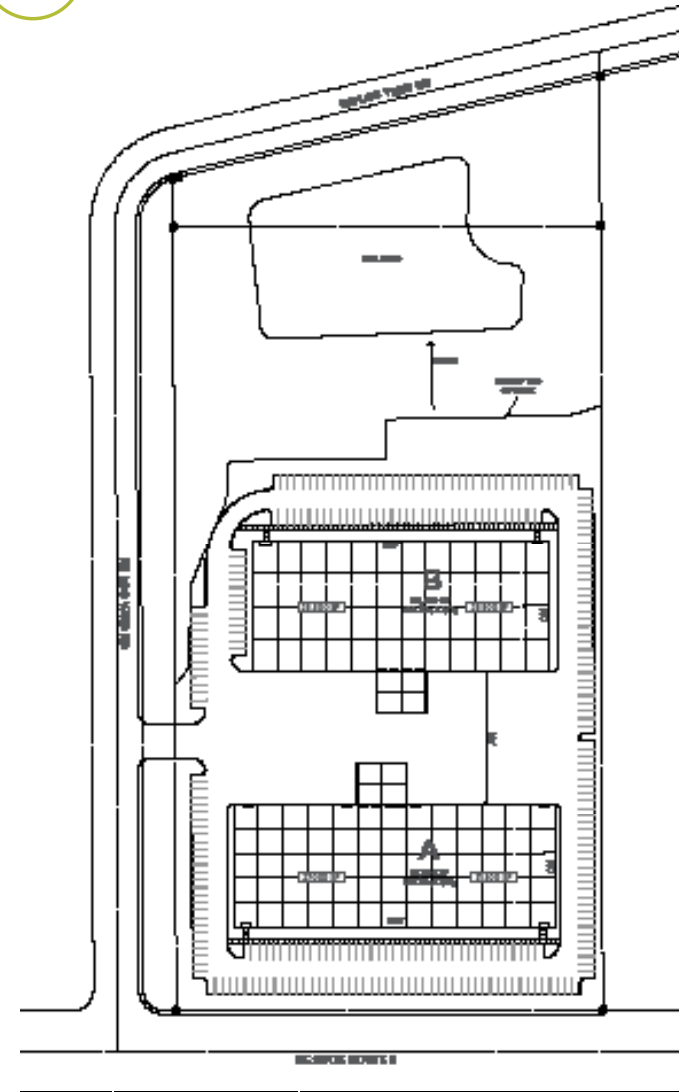

Building Size: 120,900 SF/2 Building Site Plan

Truck Court: 160'

Construction: Engineered Steel

## Building A

Building Size: 58,000 SF

Space Available: Two to Four Tenant Configuration

Loading: Covered Dock and Grade Loading

Type: Office Built to Suit

## Building B

Building Size: 62,400 SF

Space Available: Two to Four Tenant Configuration

Loading: Covered Dock and Grade Loading

Type: Office Built to Suit

### Greg Millerd

Senior Director  
+1 206 779 1692  
greg.millerd@cushwake.com

### Nicolas Alfieri

Associate  
+1 425 985 5764  
nicolas.alfieri@cushwake.com