

FOR LEASE

Owned and Operated by



227th Distribution Center

22640 West Valley Hwy, Kent, WA 98032



16,000 SF



LEASING INFO
& CONTACT

Arie Salomon	(425) 586-5636 / asalomon@nai-psp.com
Jeff Forsberg	(425) 586-5610 / jforsberg@nai-psp.com
Will Schmidt	(425) 586-5614 / wschmidt@nai-psp.com



This is not an offer or acceptance of an offer to lease space. A lease will only be offered or made in a written agreement signed by landlord. No representation or warranty of any kind is made by landlord unless set forth in a written definitive lease executed by the landlord.

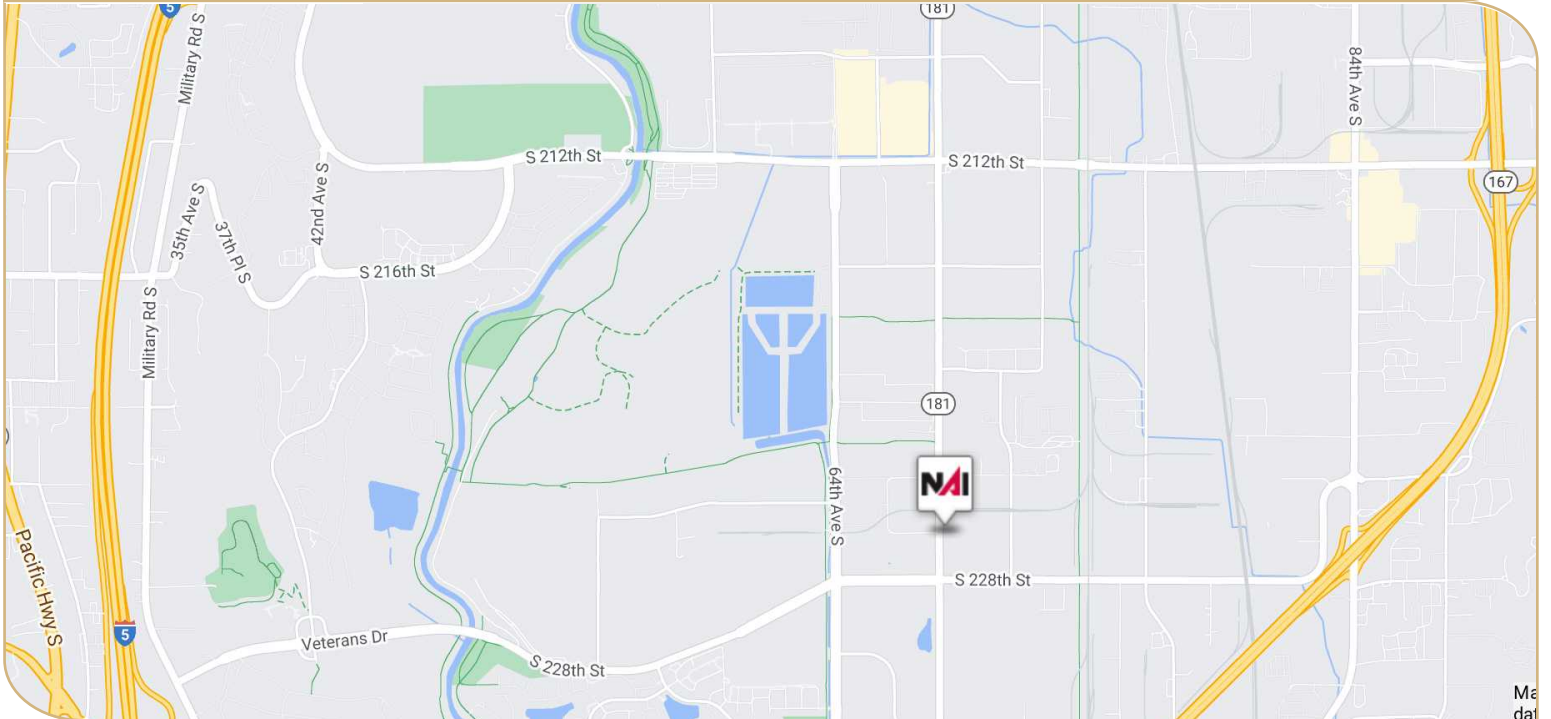
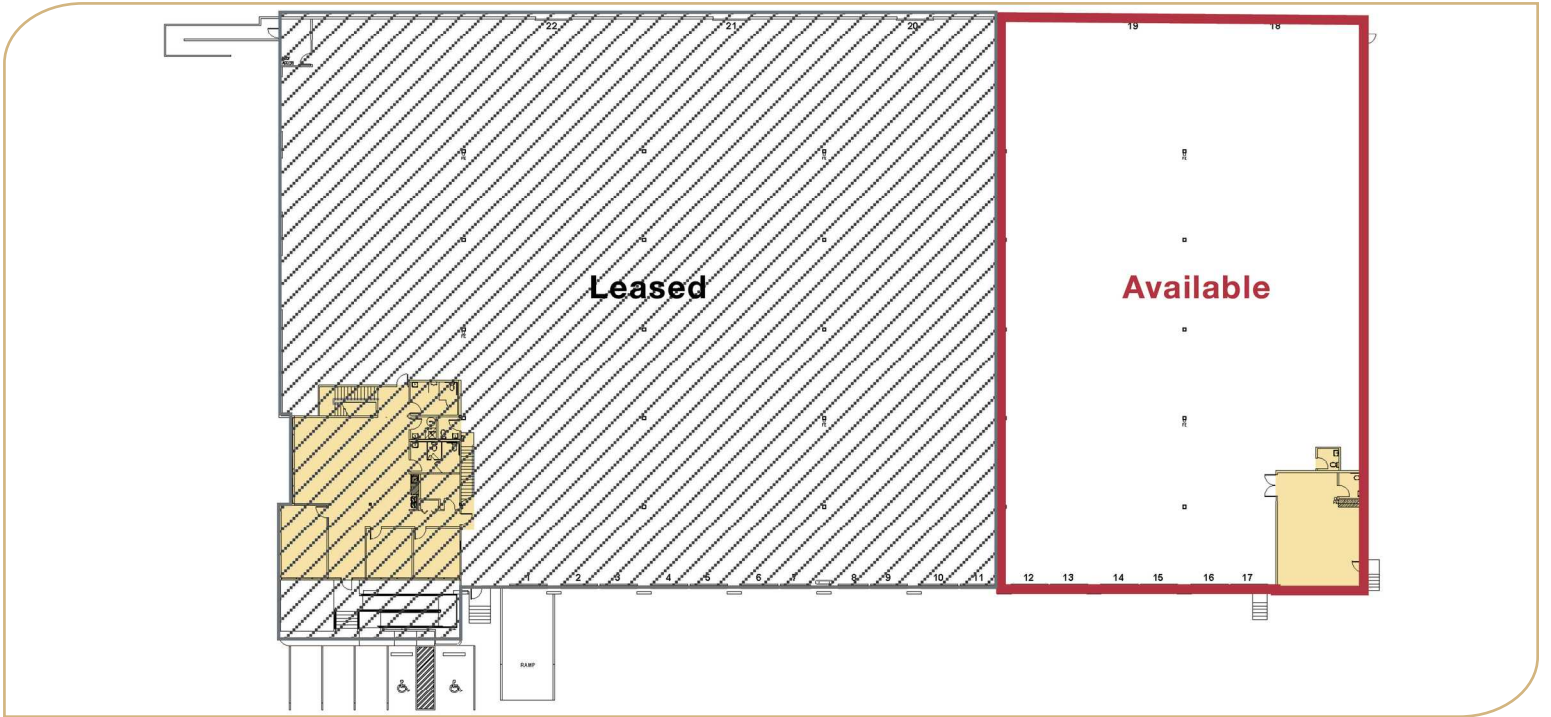

OVERVIEW

- 16,000 SF with 892 SF office
- 24' clearance
- 6 DH
- Rail Served
- West Valley Hwy exposure