

FOR LEASE

2012 Moore Street, Bellingham WA 98229

\$12.00 / Square Foot + NNN
(\$1/SqFt Industrial)



1,000 square feet office +
4,000 square feet of warehouse

- Zoned Light Impact Industrial
- 1,000 sqft office area ideal for businesses needing offices, showroom or retail presence
- 4,000 sqft warehouse includes two 12' high roll up doors accessible via partially fenced secure yard in back of property
- \$10K Tenant Improvement Allowance offered to 5-year leasing Tenants
- Fantastic location, next to I5 freeway, Stemma Brewery, Hardware Sales, and Iowa Street commercial corridor
- High visibility location just off Iowa Street
- Includes parking for approx. 10 vehicles

Across the street from Stemma Brewery,
and steps away from I-5 on/off ramp

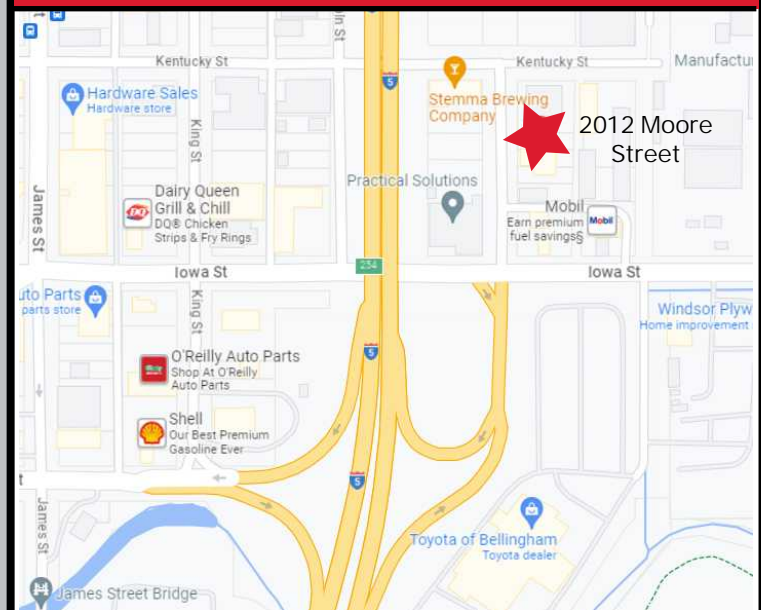

RE/MAX
COMMERCIAL®



Rebecca Heathcock

Managing Broker / Investment Advisor
RE/MAX Whatcom County, Inc.
913 Lakeway Drive, Bellingham WA 98229
Cell: 360-306-0786

2012 Moore Street, Bellingham, WA 98226

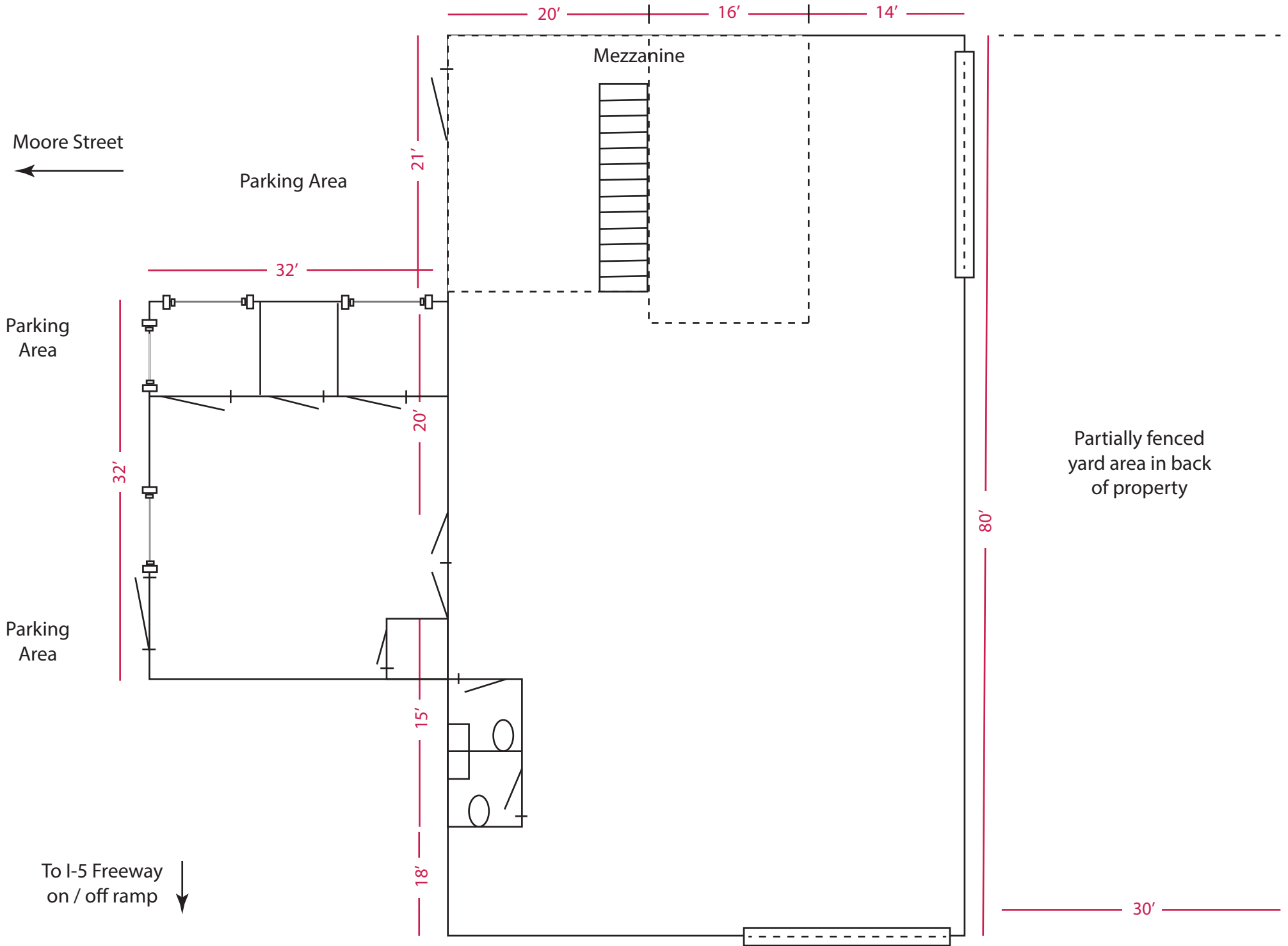



Moore St

Moore St

