

THE SOMM.

HOTEL & SPA

WOODINVILLE, WASHINGTON



*9,045 Square Feet of Retail Space Available at
Woodinville's newest Luxury Hotel, The Somm.*

CBRE

the place to **Stay & Play**

Welcome to The Somm. Hotel & Spa, a Marriott Autograph Collection, coming to Woodinville, Washington with retail space available FOR LEASE.

Relax

Rejuvenate

- 164 fully amenitized luxury hotel rooms
- 4,200 square-foot spa, a destination in itself
- 15,000 square-feet of event area for music performances, outdoor markets, and festivities of all kinds
- 3,000 square feet rooftop bar and outdoor plaza will provide incredible views of Mount Rainier and the stunning Chateau St. Michelle winery and hillside
- World Class facilities designed for 80+ destination weddings annually, average 350 - 400 guests per event



Wine & Dine



the Opportunity

- 9,045 square feet of street level retail space available for lease, from 1,500 to 7,000 SF combined
- Direct connection to The Somm. Hotel lobby and event space
- Underground parking
- Seeking hair styling salons, nail spas, wine tasting rooms and retail users
- Delivery to tenants Q2 of 2025



9,045 SF of Retail Space

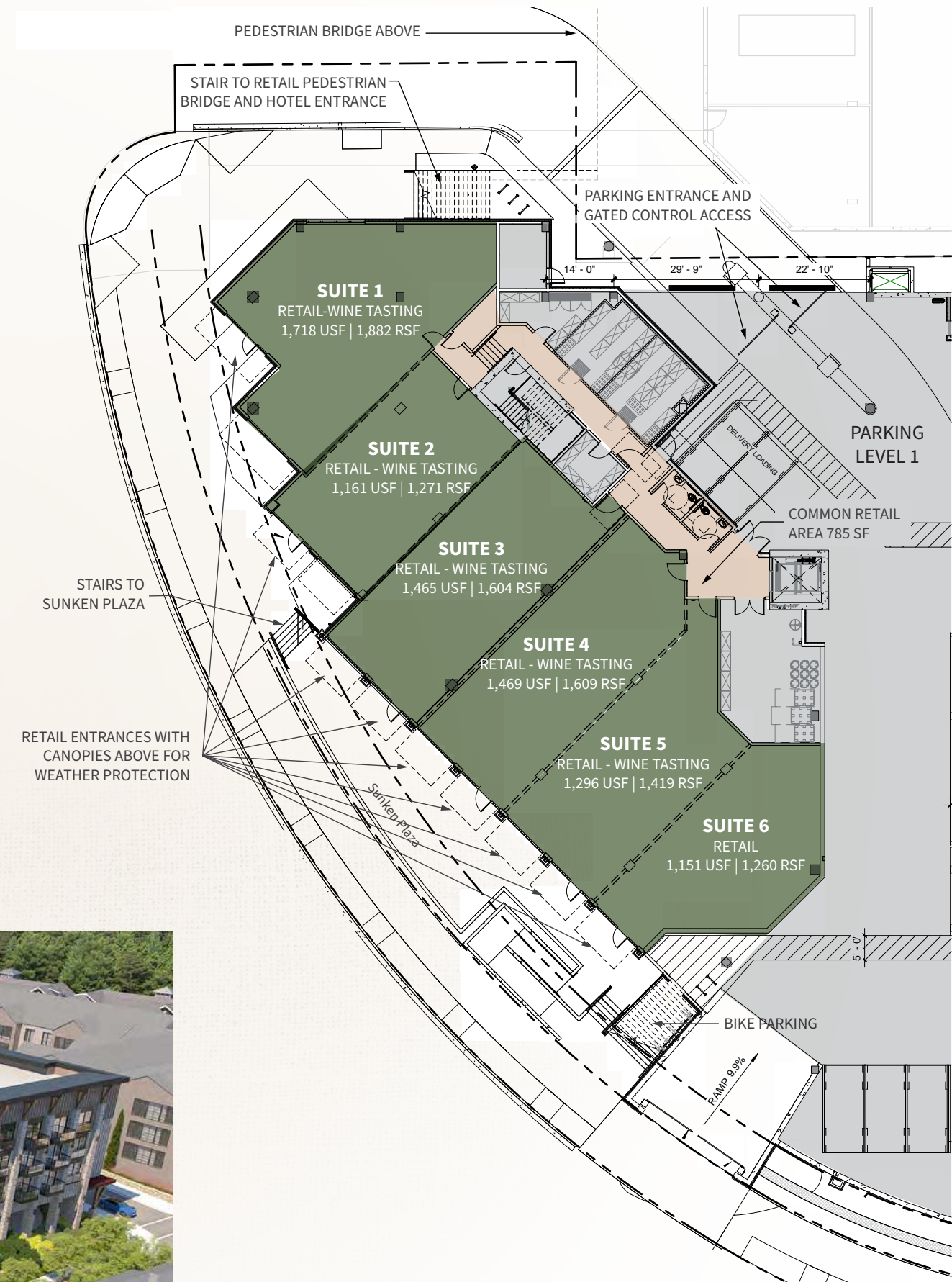

the Location



The Somm. Hotel & Spa, a Marriott Autograph Collection will be the centerpiece of the 20+ acre Harvest- Woodinville development including:

- 200,000+ square feet of retail, restaurant and wine tasting room space
- 450+ residential units, including 250 luxury apartments, over 70 townhomes, and 130 condominium units
- 13,500 square feet co-working office space by Regus



Demographics

	1 MILE	3 MILE	5 MILE
Residential Population (2021)	6,602	86,147	233,387
Residential Population (2026 Projected)	7,101	95,311	254,879
Daytime population (2021)	8,025	94,187	246,402
Average Household Income (2021)	\$160,495	\$154,900	\$162,195
Average Household Income (2026 Projected)	\$182,165	\$173,097	\$181,733

the Area Amenities

WINERY

- 1 Chateau St Michelle
- 2 Von's 1000 Spirits
Cascade Cliffs Vineyard
and Winery
- 3 Januik Novelty Hill
- 4 Hollywood Schoolhouse
Maryhill Winery
- 5 DeLille Cellars & Lounge
Sparkman Winery
Mark Ryan Winery
Long Shadows
- 6 Apple Farm Village

RESTAURANT

- 7 The Hollywood Tavern
- 8 Barking Frog
- 9 The Herbfarm

HOTEL/SPA

- 10 Willows Lodge

RECREATION

- 11 Sammamish River Trail
- 12 Northshore Ballfields

COFFEE

- 13 Grounds Coffee Co.

DISTANCE (Miles)

City Hall	↖	2.5
Woodin Creek Park	↗	2.4
Target	↖	2.4
Molbak's	↗	2.2
Redmond	↘	4.5

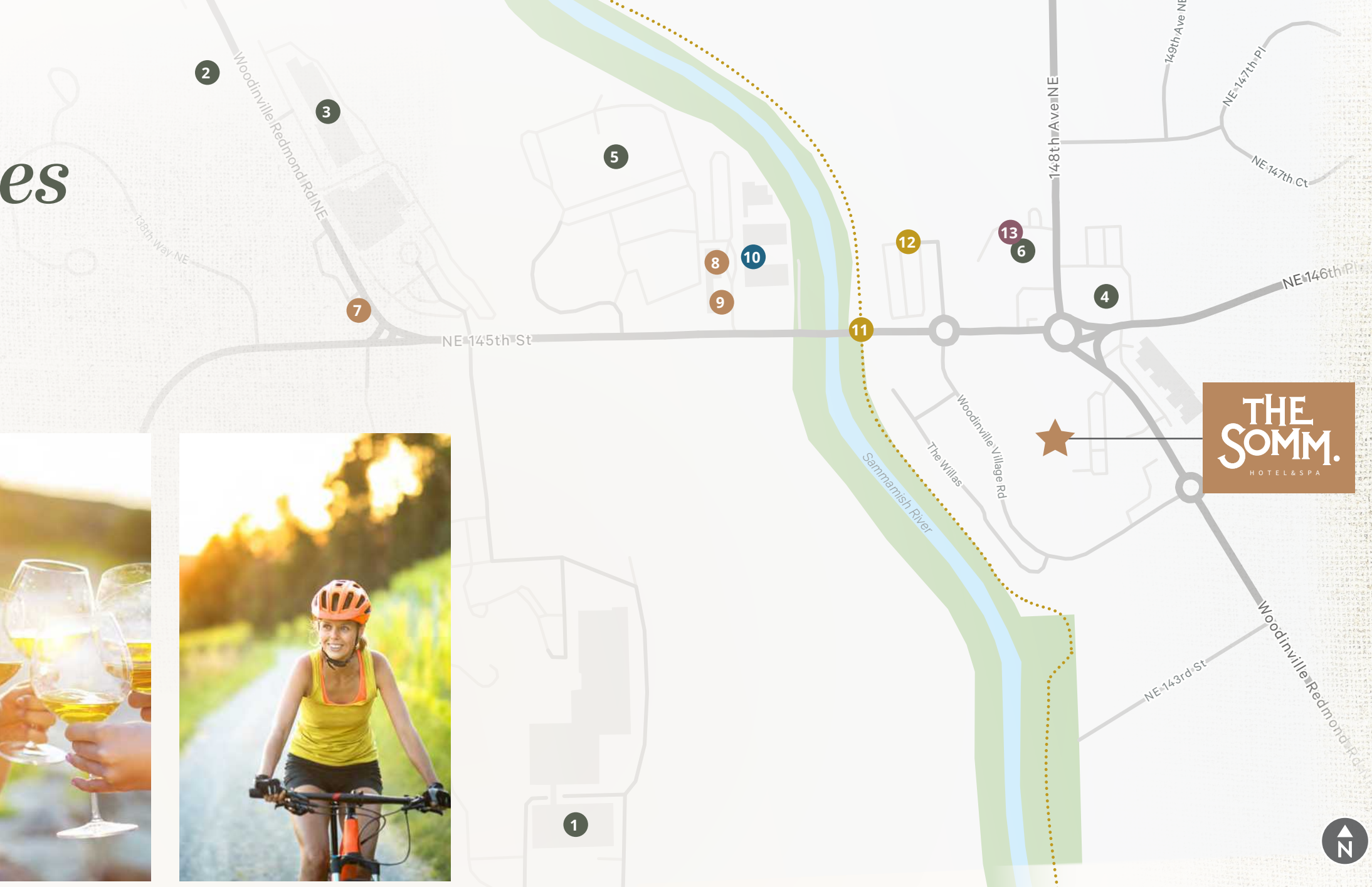

THE SOMM.

H O T E L & S P A

JENNIFER SEVERSEN

Vice President

T +1 206 390 1498

jennifer.seversen@cbre.com

© 2023 CBRE, Inc. All rights reserved. This information has been obtained from sources believed reliable, but has not been verified for accuracy or completeness. You should conduct a careful, independent investigation of the property and verify all information. Any reliance on this information is solely at your own risk. CBRE and the CBRE logo are service marks of CBRE, Inc. All other marks displayed on this document are the property of their respective owners, and the use of such logos does not imply any affiliation with or endorsement of CBRE. Photos herein are the property of their respective owners. Use of these images without the express written consent of the owner is prohibited. PMStudio_February2024

CBRE