

FOR LEASE

20825 Highway 410
Bonney Lake, WA 98390



TALL FIRS SHOPPING CENTER

Blake Weber | Ned Whalen | Tim Weber | Don Whittles

First Western Properties—Tacoma Inc. | 253.472.0404
6402 Tacoma Mall Blvd, Tacoma, WA 98409 | fwp-inc.com

20825 HIGHWAY 410:

1,520 SF \$30.00 PSF PLUS NNN

- Previously occupied by 9Round Fitness
- Excellent retail synergy in the immediate area



TENANTS



Regis - 2023	Population	Average HH Income	Daytime Population
Mile 1	6,072	\$125,562	4,142
Mile 3	48,788	\$117,812	18,691
Mile 5	87,968	\$124,441	36,913

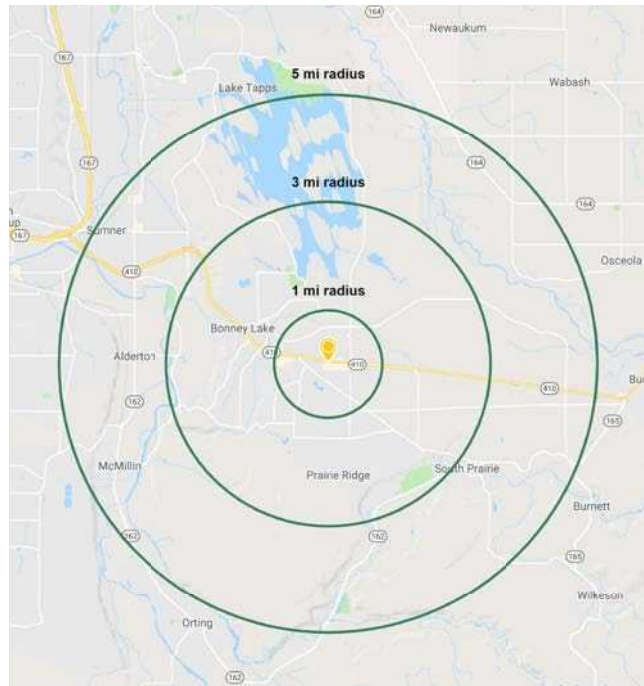

LOCATION DETAILS

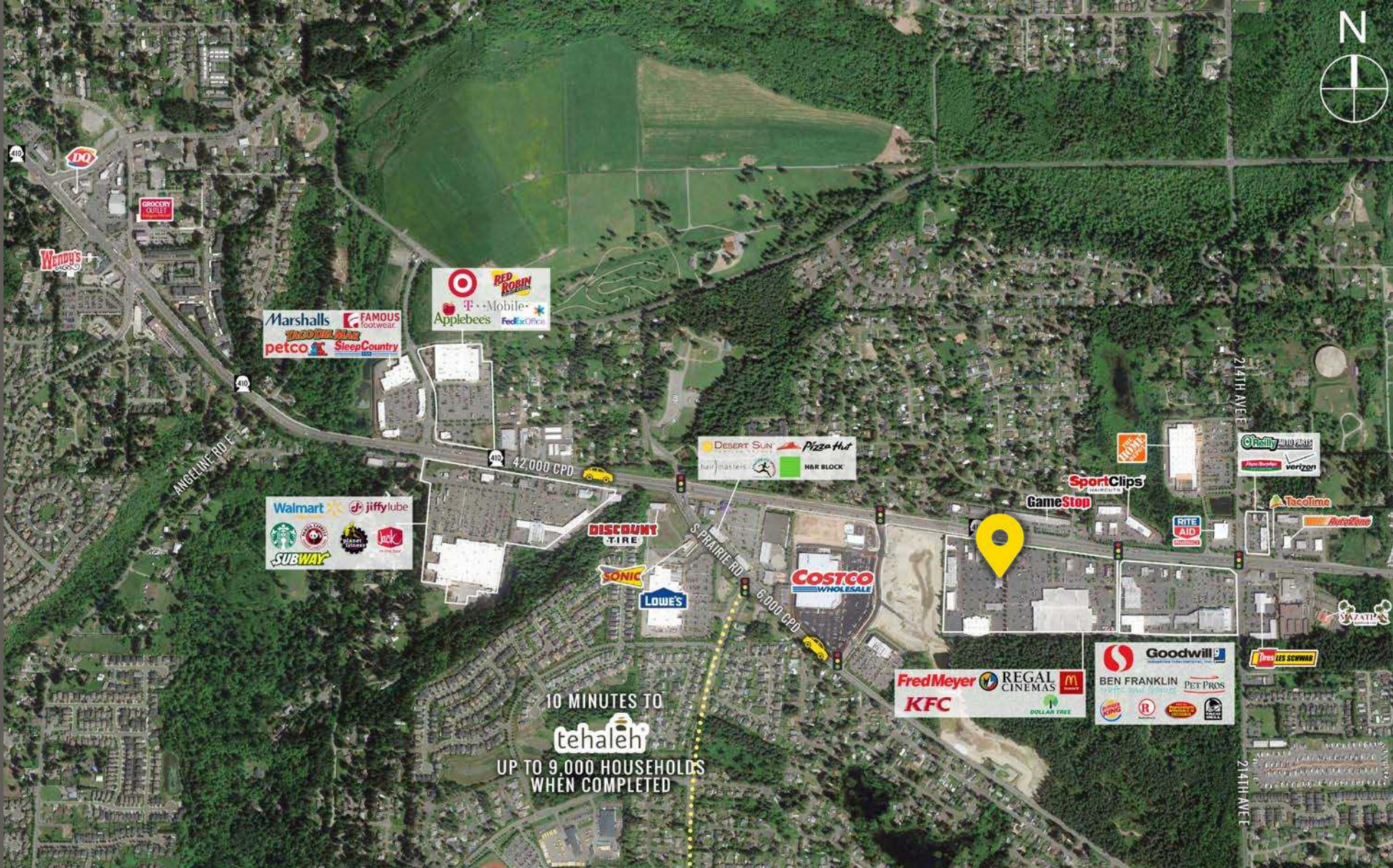

High residential population with Tehaleh Community underway



Moments away from a new Costco development



42,000 CPD Highway 410

FLOOR PLAN

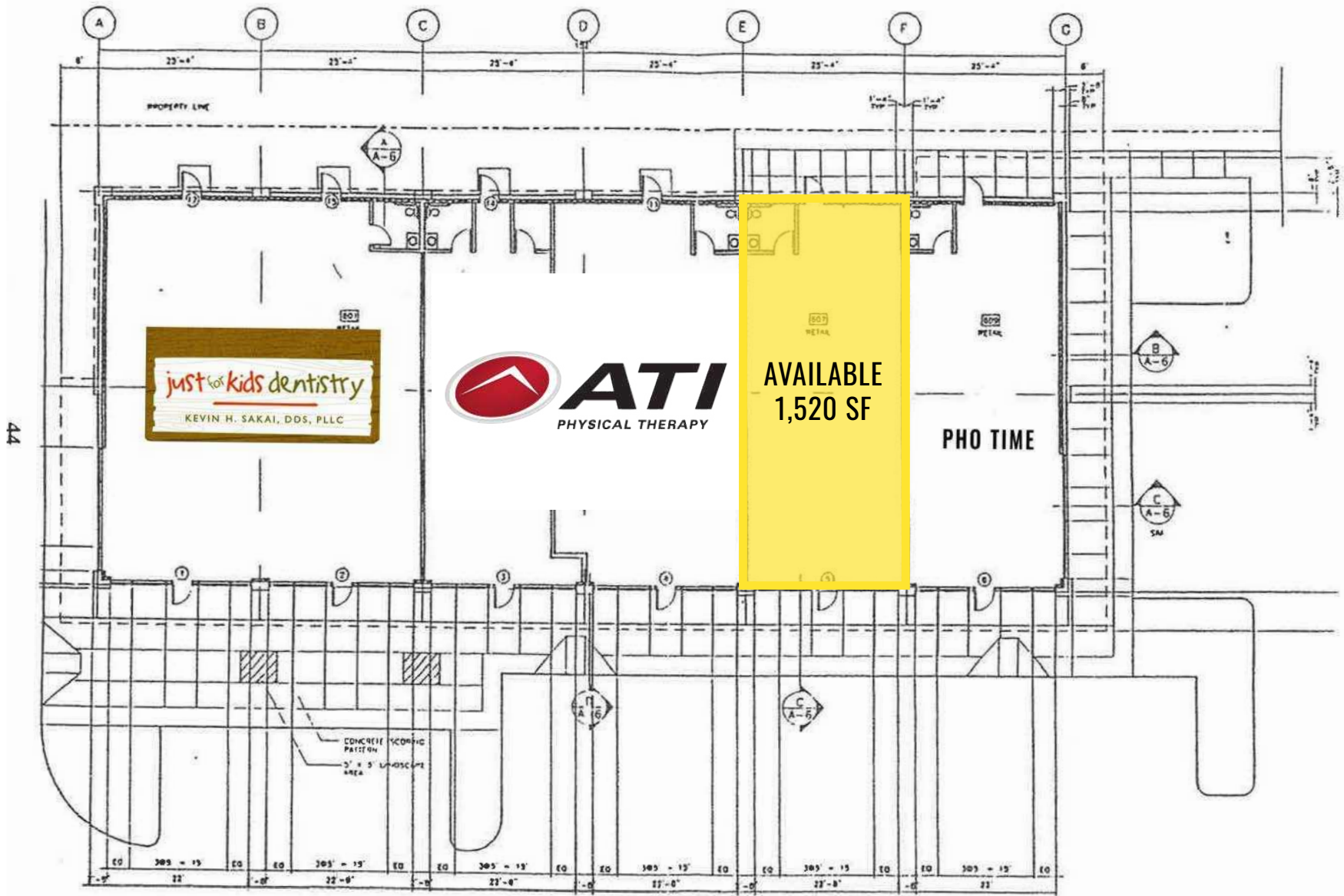



BONNEY LAKE, WA is a residential suburban community located near the shores of 4.5-square-mile Lake Tapps. The city of slightly more than 17,000 residents also encompasses Lake Bonney and Lake Debra. Excellent schools, a local library, desirable residential neighborhoods, exceptional local government services and excellent recreational opportunities make Bonney Lake a prime location for residents and businesses alike.

TACOMA | KIRKLAND | PORTLAND



RELATIONSHIP FOCUSED. RESULTS DRIVEN.

BLAKE WEBER

206.898.1231
bweber@firstwesternproperties.com

NED WHALEN

206.491.5998
nwhalen@firstwesternproperties.com

TIM WEBER

253.471.5502
tweber@firstwesternproperties.com

DON WHITTLES

253.471.5509
dwhittles@firstwesternproperties.com



First Western Properties—Tacoma Inc. | 253.472.0404
6402 Tacoma Mall Blvd, Tacoma, WA 98409 | fwp-inc.com

© First Western Properties, Inc. DISCLAIMER: The above information has been secured from sources believed to be reliable, however, no representations are made to its accuracy. Prospective tenants or buyers should consult their professional advisors and conduct their own independent investigation. Properties are subject to change in price and/or availability without notice.