

DAVIS COMMERCE CENTER

22717 72nd Ave S, Suite B-102 Kent, WA 98032

Available Immediately

Warehouse/Flex Space



Property Specifications

- 2,500 SF Shell
- 414 SF Office
- 1 Grade Level Door
- 100 Amps 120/208 Volt 3-Phase Power
- Make-ready tenant improvements in office areas

Property Features

- West Valley Highway Visibility
- Excellent freeway access to Highway 167 & I-5
- Monitored Video Surveillance & Security



Owned & Operated by:



Leasing by:



dpillc.com

DAVIS COMMERCE CENTER

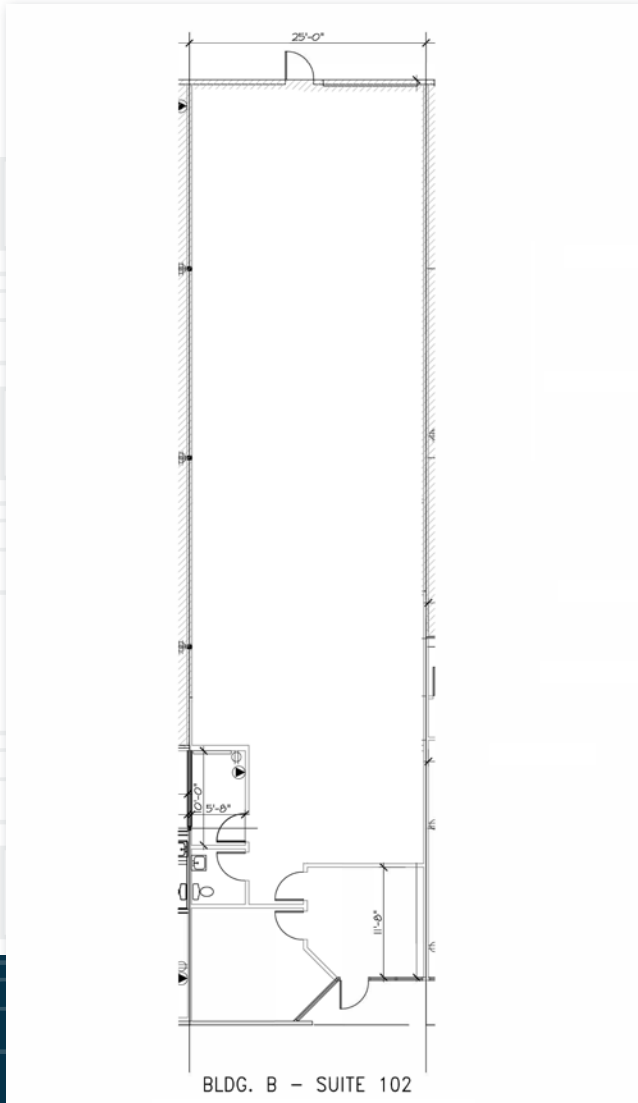

Contact Kidder Mathews for more info:

Travis Stanaway
206-248-6526
travis.stanaway@kidder.com

Dane Dahline
206-248-6519
dane.dahline@kidder.com

Lisa Rowe
206-777-5122
lisar@davispropertiesllc.com

The information provided in this document should be independently verified on any material matter represented herein.

Owned & Operated by:

Leasing by:

dpillc.com