

WAREHOUSE
LEASE

Available



AIRPORT COMMERCE CENTER, Building B

11630 Airport Road | Everett, WA

Caleb Farnworth, CCIM

425.289.2235

calebf@rosenharbottle.com

Grant Rubenstein

425.289.2220

grant@rosenharbottle.com

425.454.3030
rosenharbottle.com

PO Box 5003
Bellevue, WA 98009 - 5003



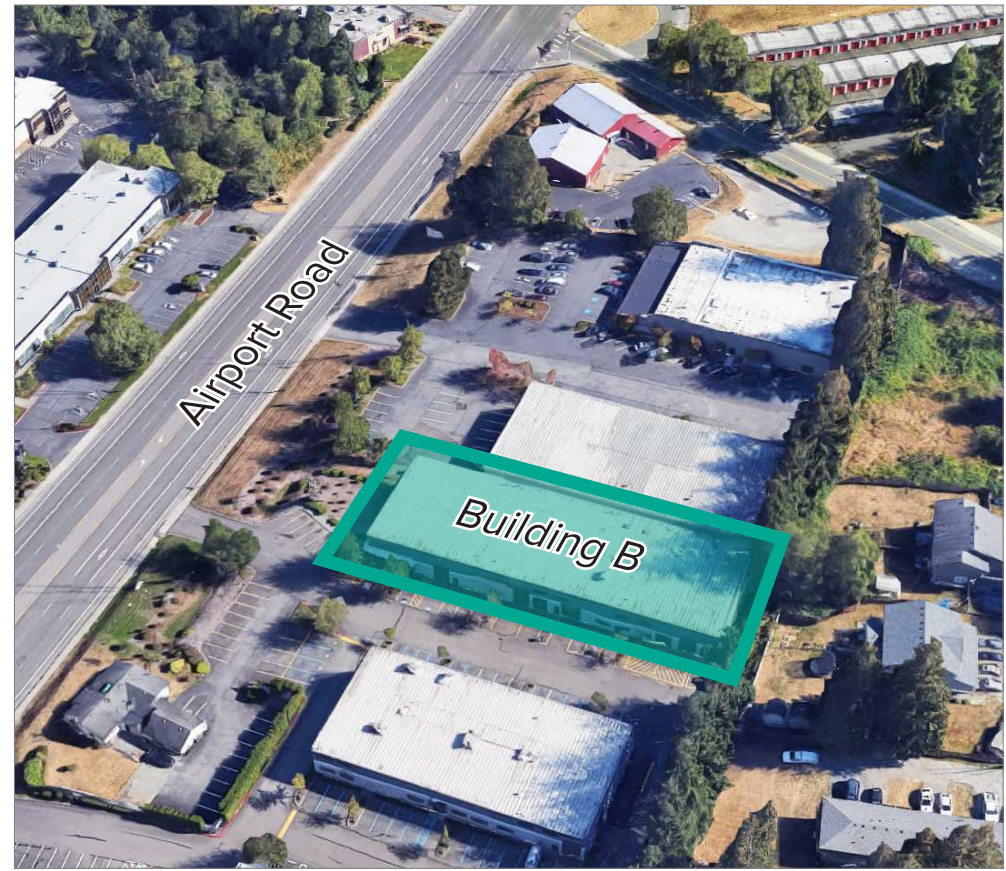

OFFICE/WAREHOUSE SPACE ON AIRPORT ROAD

4,900 SF (2,288 SF ofc) Available

\$1.40/SF, NNN Blended

PROPERTY DETAILS:

- Sprinkled building
- 22' Clear height
- Prominent signage on Airport Road
- Quick access to Paine Field, Highway 99, and I-5
- Abundant parking

The information provided herein has been obtained from sources believed to be reliable, but no representation or warranty, express or implied, is made with respect to the accuracy or completeness of any such information. Each prospective buyer or tenant should independently investigate, evaluate and verify all information provided herein and any other matters deemed material. Please consult your attorney, tax advisor or other professional advisor. The terms of sale or lease set forth herein are subject to change or withdrawal at any time and without notice.

SUITE B-300 FLOOR PLAN

SUITE FEATURES

- Available 2/1/2025
- 4,900 SF (2,288 SF ofc)
- Rate: \$1.40/SF, NNN Blended
- Office/Warehouse space
 - First floor includes private offices, 2 restrooms, kitchenette, and open warehouse
 - Second floor mezzanine includes office area and storage
- 1 Grade-level roll-up loading door

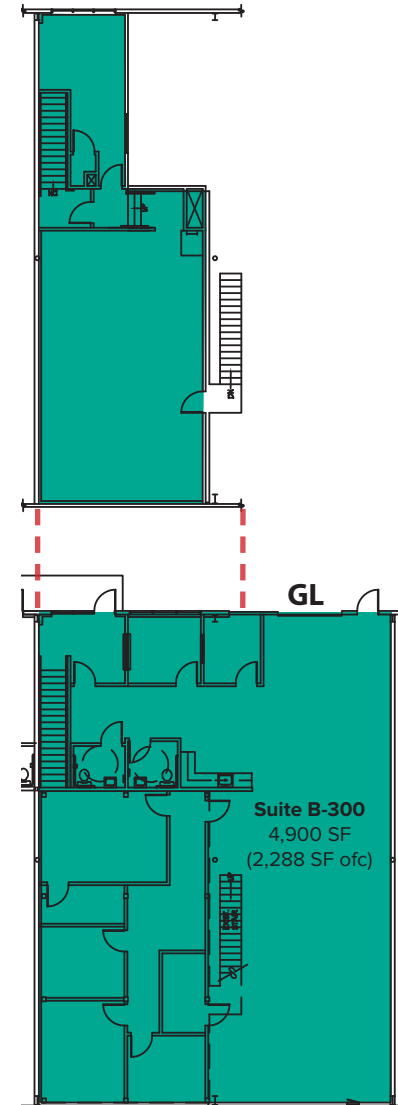

LOCATION MAP

