



**600 E RIVERPARK LN, SUITE 105, BOISE, IDAHO
OFFICE SPACE AVAILABLE FOR SUBLEASE**

PROPERTY OVERVIEW

- 600 E Riverpark Ln, Suite 105, Boise, Idaho
- 4,076 SF
- \$19 Full Service Less Janitorial
- Beautiful Business Park Environment
- New Finishes throughout
- 4/1,000 Parking ratio

**AVAILABLE IMMEDIATELY
CONTACT AGENT FOR SHOWING INSTRUCTIONS**

Greg Gaddis | Principal | CCIM | SIOR
Tenant Realty Advisors
950 W. Bannock St, Ste 400, Boise, ID 83702
Cell: 208-869-9294

TRA
Tenant Realty Advisors

FLOOR PLAN

TRA

Tenant Realty Advisors

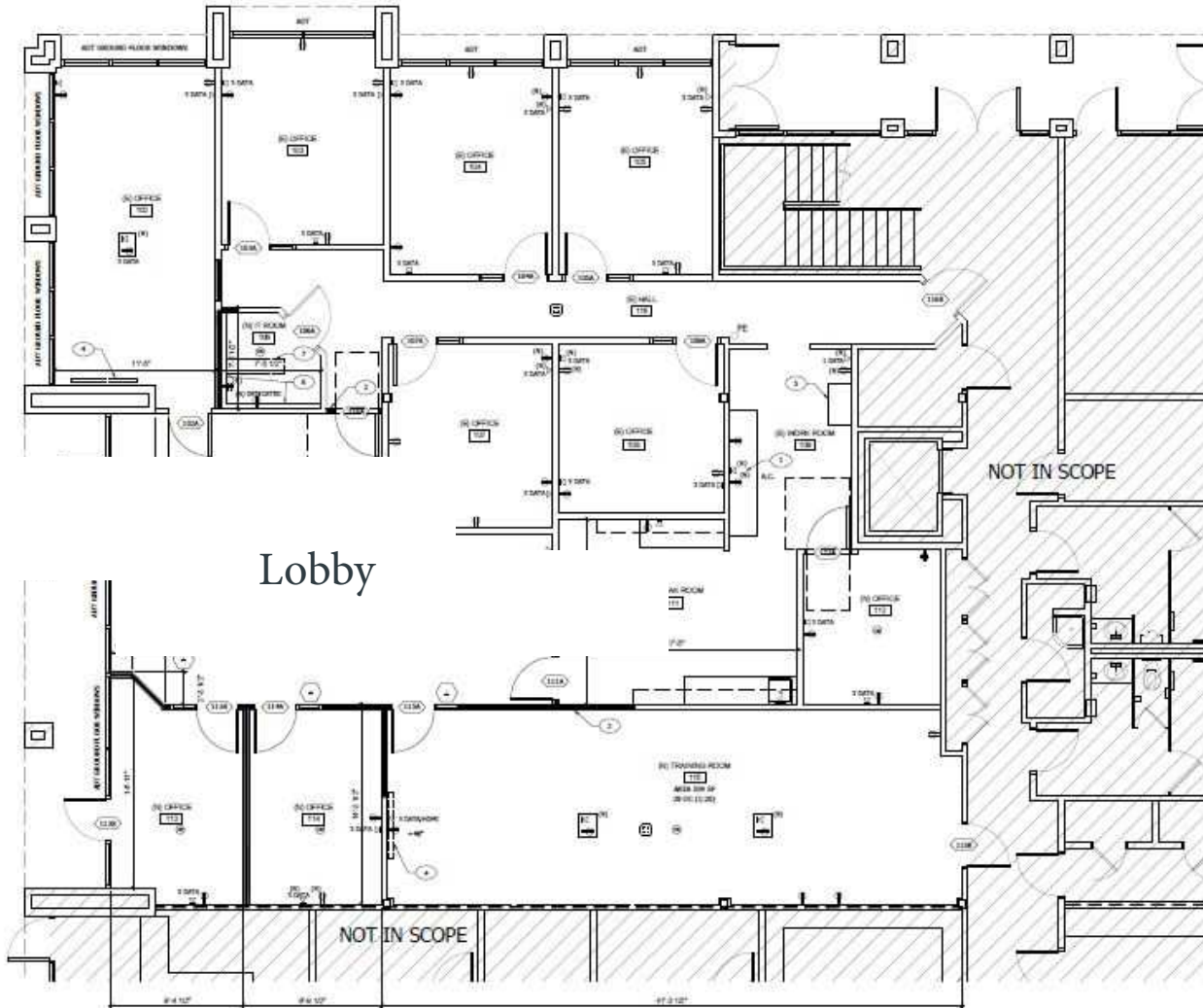

Greg Gaddis | Principal | CCIM | SIOR
Tenant Realty Advisors
950 W. Bannock St, Ste 400, Boise, ID 83702
Cell: 208-869-9294