

For Lease

Office Warehouse Space



715 E Sprague Avenue

Spokane, Washington 99202

Property Description

Available Space:

Suite 90:

Warehouse -15,586 USF ± \$10,131/m NNN

Centrally Located with Good Access to I-90
& the U-District

Dock High Loading

Zoned GC-150

Excellent Parking On-Site

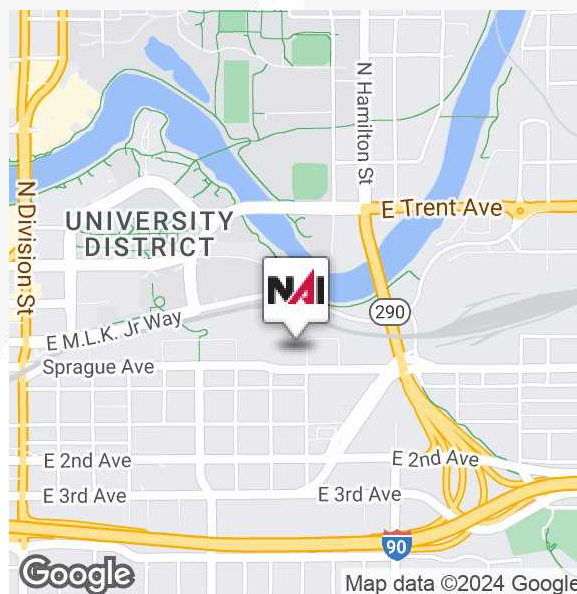

For more information

Jon Jeffreys, SIOR

O: 509 622 3566

jjeffreys@naiblack.com

Darren Slackman, SIOR

O: 509 622 3595

dslackman@naiblack.com

No warranty or representation, expression or implied, is made as to the accuracy of the information contained herein, and the same is submitted subject to errors, omissions, change or price, rental or other conditions, prior to sale, lease, financing, or withdrawal without notice, and of special listing conditions imposed by our principals no warranties or representations are made as to the condition of the property or any hazards contained therein or any to be implied.

801 W. Riverside Avenue, Suite 300
Spokane, WA 99201
509 623 1000 tel
naiblack.com

For Lease
Office Warehouse Space

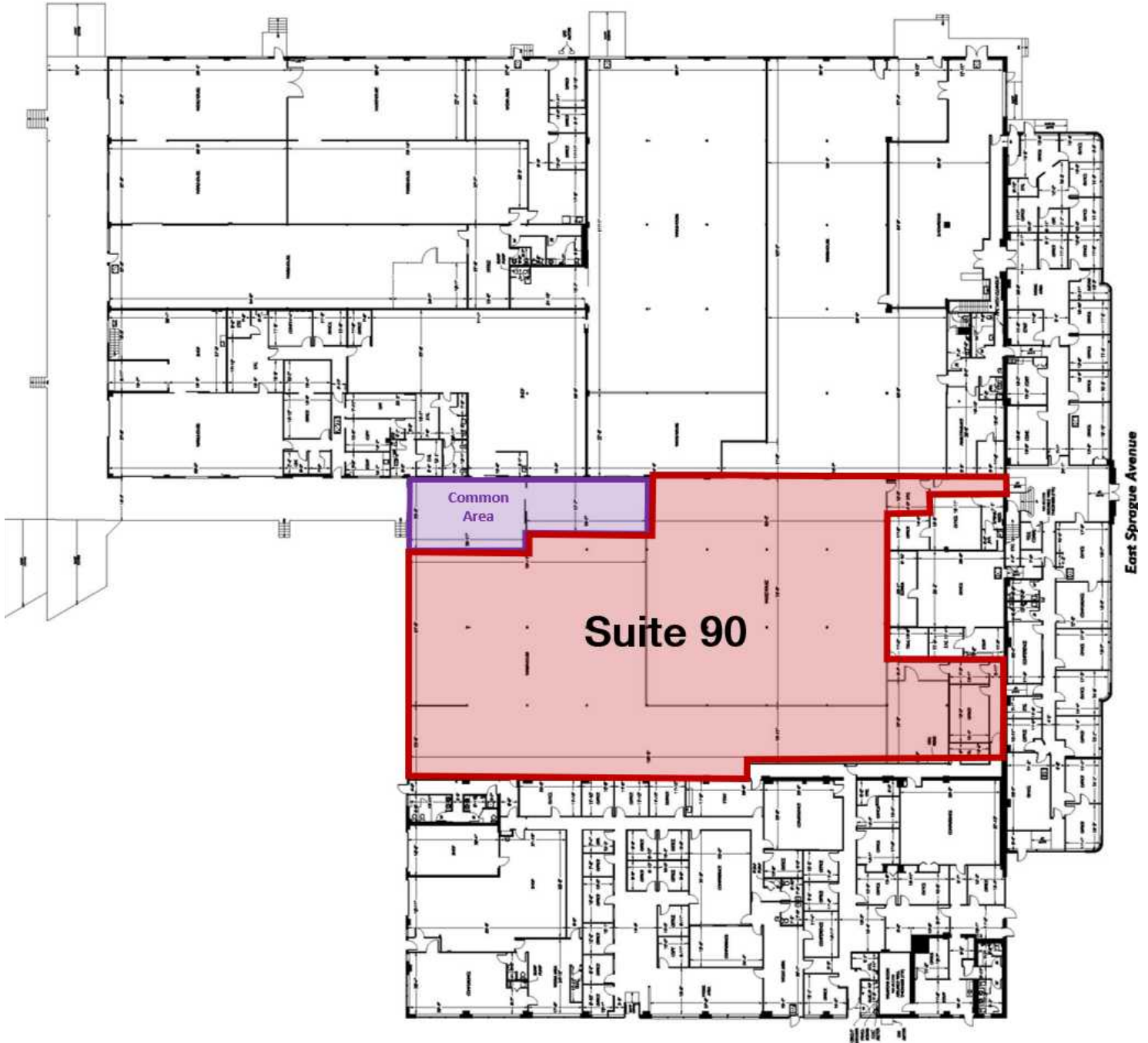

NAI Black respects the intellectual property rights of others. If you believe that your intellectual property rights have been violated by NAI Black or by a third party who has uploaded Content on our Site, please provide the following information to the NAI Black designated copyright agent as addressed below: a. A description of the copyrighted work or other intellectual property that you claim has been infringed; b. A specific description of where the material that you claim is infringing is located on the Site so the agent is able to locate it; c. An address, telephone number, and e-mail address where NAI Black can contact you and, if different, an e-mail address where the alleged infringing party, if not NAI Black, can contact you; d. A signed statement that you have a good-faith belief that the material use is not authorized by the copyright owner or other intellectual property rights owner, by its agent, or by law. E. A signed statement by you under penalty of perjury that the information in your notice is accurate and that you are the copyright or intellectual property owner or are authorized to act on the owner's behalf. After reviewing the complaint and determining if the complaint is valid, NAI Black will work to quickly remove the infringing material or disable access to it. Note: There are substantial penalties for false claims. NAI Black may request additional information before removing any infringing material. NAI Black may provide the alleged infringing party with your e-mail address so that that person can respond to your allegations. NAI Black has registered a designated agent with the Copyright Office pursuant to 17 U.S.C. 512(c). If you believe your copyright material is being used on this Site without permission, please notify the designated agent as follows:
By e-mail: mary@commercialmls.com | Subject Line: Copyright Concern
By mail: Commercial Brokers Association Attn: DMCA Designated Agent | 12131 113th Ave NE Suite 101 | Kirkland, WA 98034

If e-mailing your copyright infringement notice, then NAI Black must receive the signed statement(s) mentioned above by mail, or attached to the e-mail, before we are required to take action.

For Lease
Office Warehouse Space



Map data © 2021 Google Imagery © 2021, Maxar Technologies, U.S. Geological Survey, USDA Farm Service Agency

NAI Black respects the intellectual property rights of others. If you believe that your intellectual property rights have been violated by NAI Black or by a third party who has uploaded Content on our Site, please provide the following information to the NAI Black designated copyright agent as addressed below: a. A description of the copyrighted work or other intellectual property that you claim has been infringed; b. A specific description of where the material that you claim is infringing is located on the Site so the agent is able to locate it; c. An address, telephone number, and e-mail address where NAI Black can contact you and, if different, an e-mail address where the alleged infringing party, if not NAI Black, can contact you; d. A signed statement that you have a good-faith belief that the material use is not authorized by the copyright owner or other intellectual property rights owner, by its agent, or by law. E. A signed statement by you under penalty of perjury that the information in your notice is accurate and that you are the copyright or intellectual property owner or are authorized to act on the owner's behalf. After reviewing the complaint and determining if the complaint is valid, NAI Black will work to quickly remove the infringing material or disable access to it. Note: There are substantial penalties for false claims. NAI Black may request additional information before removing any infringing material. NAI Black may provide the alleged infringing party with your e-mail address so that that person can respond to your allegations. NAI Black has registered a designated agent with the Copyright Office pursuant to 17 U.S.C. 512(c). If you believe your copyright material is being used on this Site without permission, please notify the designated agent as follows:
By e-mail: mary@commercialnais.com | Subject Line: Copyright Concern
By mail: Commercial Brokers Association Attn: DMCA Designated Agent | 12131 113th Ave NE Suite 101 | Kirkland, WA 98034

If e-mailing your copyright infringement notice, then NAI Black must receive the signed statement(s) mentioned above by mail, or attached to the e-mail, before we are required to take action.