



FOR LEASE

5105 - 5109 Capitol Blvd S
Tumwater, WA 98501



SOUTHGATE "NORTH" RETAIL

Patric Grissom

First Western Properties—Tacoma Inc. | 253.472.0404
6402 Tacoma Mall Blvd, Tacoma, WA 98409 | fwp-inc.com

AVAILABLE SUITES

- ▶▶ 5109 SUITE B: 716 SF
 - ▶▶ 5109 SUITES D/E: 2,599 SF (CAN BE DEMISED)
 - ▶▶ 5109 SUITE F: 2,434 SF
- \$21.00 PSF Rent
 - \$8.50 PSF + NNN
 - Close proximity to I-5
 - Limited retail space available
 - High traffic corridor



TENANTS



DEMOGRAPHICS

POPULATION

Mile 1	Mile 3	Mile 5
8,262	54,658	129,980

AVERAGE HH INCOME

Mile 1	Mile 3	Mile 5
\$100,836	\$115,210	\$112,533

DAYTIME POPULATION

Mile 1	Mile 3	Mile 5
5,972	55,848	108,277

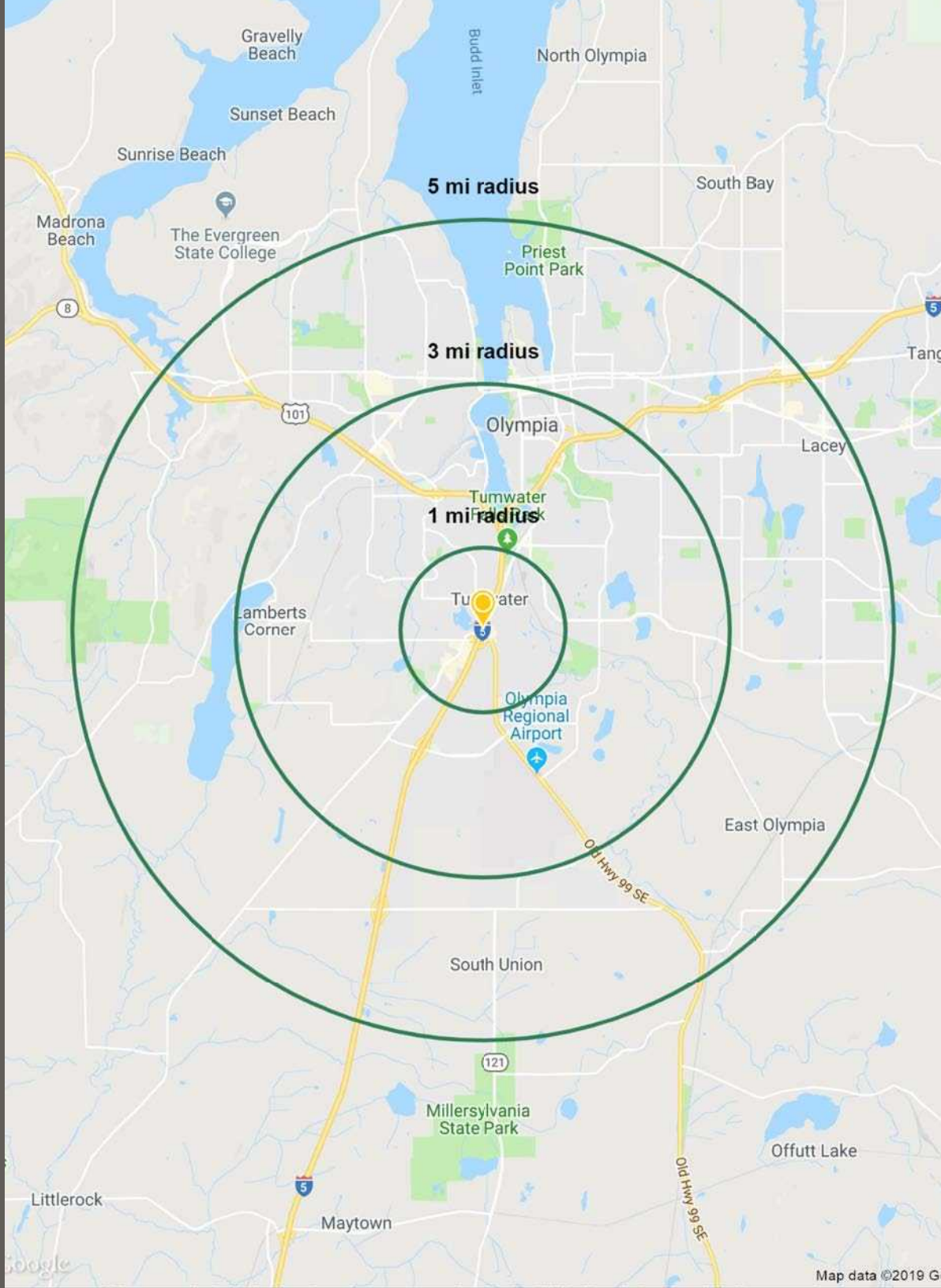

SUMMARY

LOCATION AERIAL

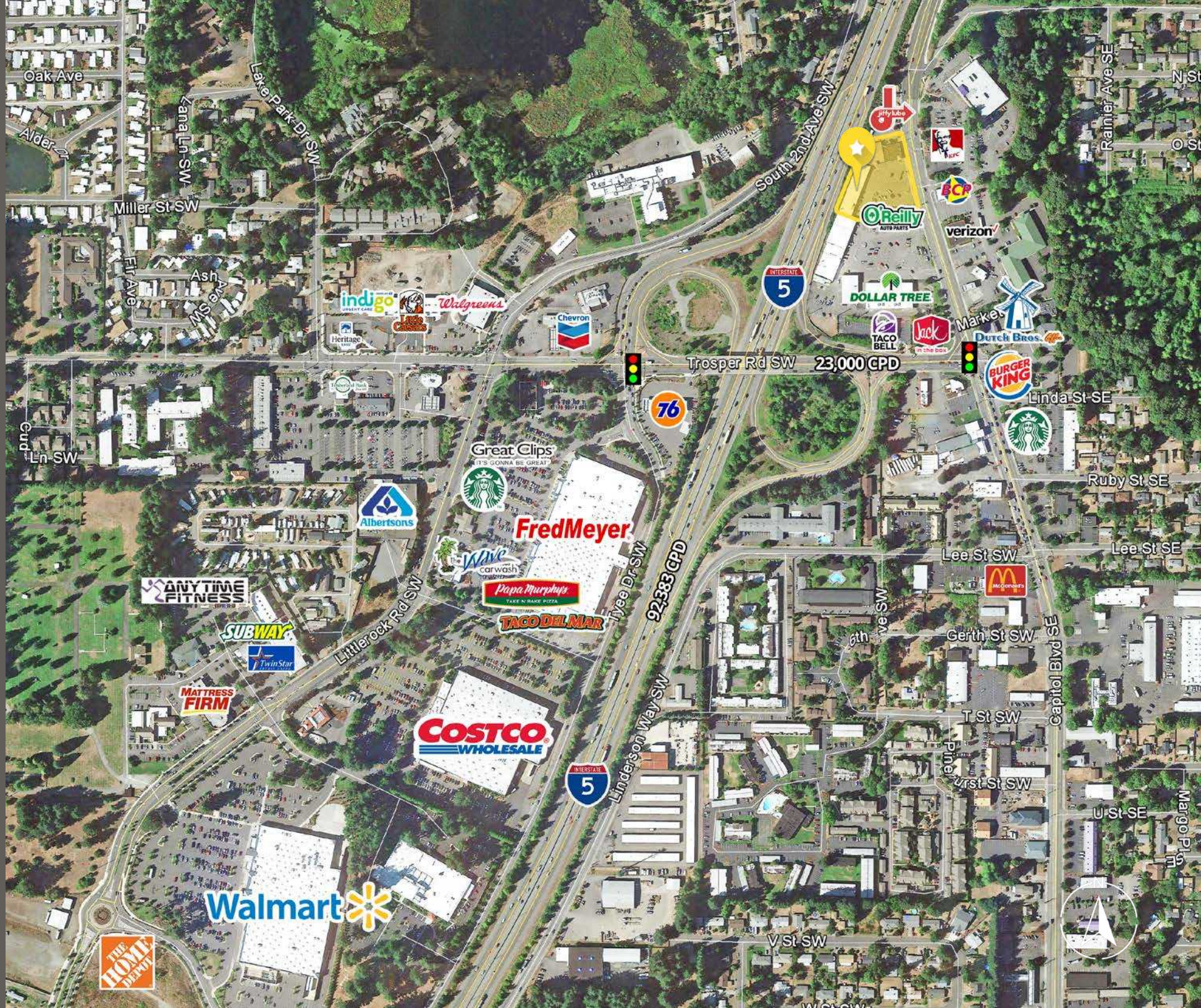

SITE PLAN

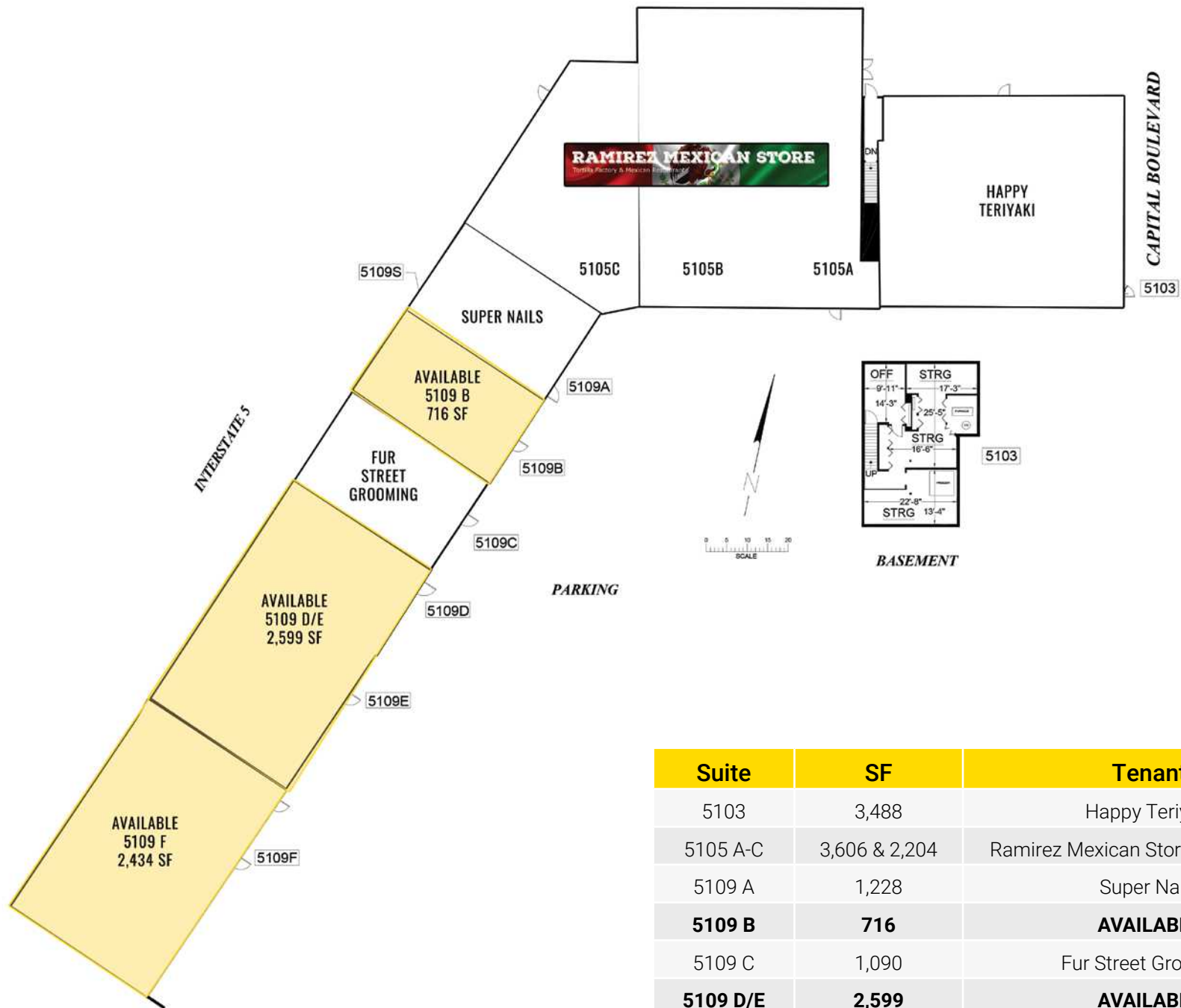

Suite	SF	Tenant
5103	3,488	Happy Teriyaki
5105 A-C	3,606 & 2,204	Ramirez Mexican Store & Restaurant
5109 A	1,228	Super Nails
5109 B	716	AVAILABLE
5109 C	1,090	Fur Street Grooming
5109 D/E	2,599	AVAILABLE
5109 F	2,434	AVAILABLE



TUMWATER, WA is a small town with a rich history. Located at the junction of Interstate 5 and Highway 101, where you find the base of the Deschutes River, and where Mount Rainier seems close enough to touch. Together, Tumwater and the neighboring cities of Lacey and Olympia, form a community of just over 100,000 in population. Tumwater is a great place to work, live, shop, play, and do business.

TACOMA | KIRKLAND | PORTLAND | SEATTLE



RELATIONSHIP FOCUSED. RESULTS DRIVEN.

PATRIC GRISSOM

 253.284.3635

 pgrissom@firstwesternproperties.com



First Western Properties—Tacoma Inc. | 253.472.0404
6402 Tacoma Mall Blvd, Tacoma, WA 98409 | fwp-inc.com

© First Western Properties, Inc. DISCLAIMER: The above information has been secured from sources believed to be reliable, however, no representations are made to its accuracy. Prospective tenants or buyers should consult their professional advisors and conduct their own independent investigation. Properties are subject to change in price and/or availability without notice.