



FOR LEASE

BMR Port Commercial Center

1400 PORT OF TACOMA RD, TACOMA, WA 98402



28,530 SF Available December 2024
Site Work Underway!

TODD CLARKE
253.722.1422
todd.clarke@kidder.com

TY CLARKE
253.722.1419
ty.clarke@kidder.com

HUNTER CLARKE
253.722.1454
hunter.clarke@kidder.com

**Kidder
Mathews**

This information supplied herein is from sources we deem reliable. It is provided without any representation, warranty, or guarantee, expressed or implied as to its accuracy. Prospective Buyer or Tenant should conduct an independent investigation and verification of all matters deemed to be material, including, but not limited to, statements of income and expenses. Consult your attorney, accountant, or other professional advisor.

KIDDER.COM

FOR LEASE

BMR Port Commercial Center

1400 PORT OF TACOMA RD, TACOMA, WA 98402

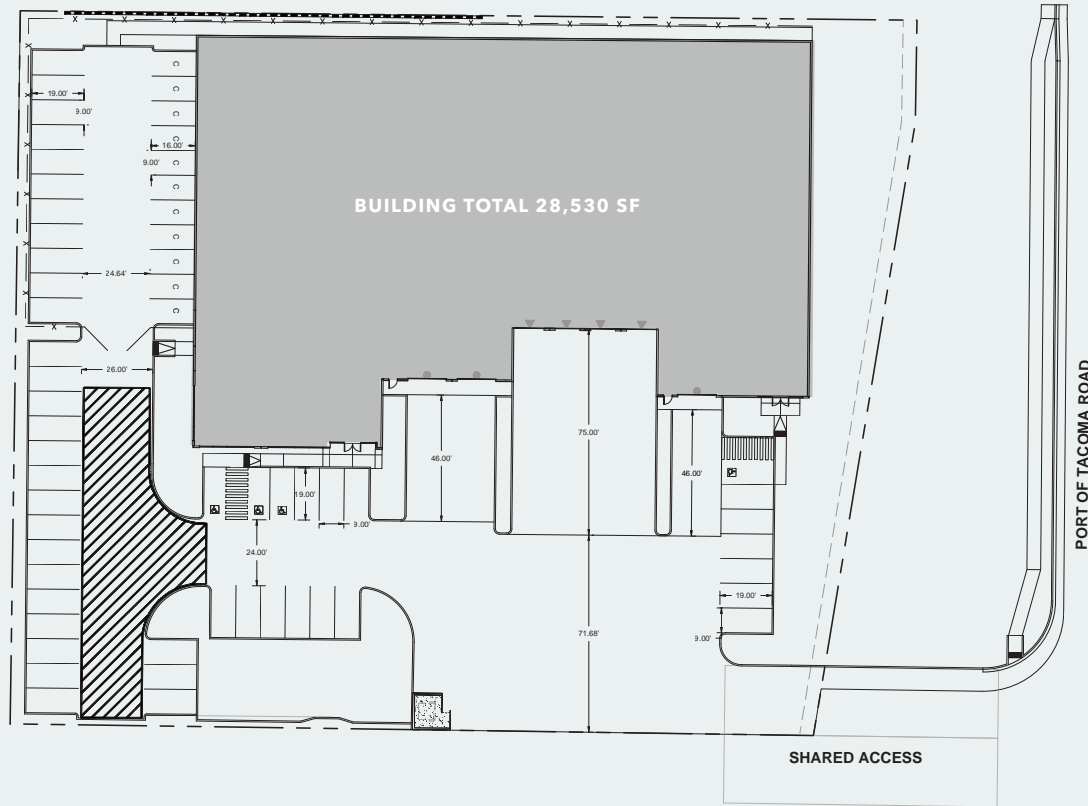

BUILDING INFORMATION

28,530 SF building

±1.77 acre site

Divisible to:

20,100 SF / 8,430 SF or

18,730 SF / 9,800 SF

Build-to-suit office

Concrete tilt construction

24' clear-height

53 auto stalls

4 dock-high doors

3 grade-level doors

Ability for fenced & secured yard

Immediate access to I-5, SR 509, and Port of Tacoma

Zoning: Regional Commercial (City of Fife)

TODD CLARKE

253.722.1422

todd.clarke@kidder.com

TY CLARKE

253.722.1419

ty.clarke@kidder.com

HUNTER CLARKE

253.722.1454

hunter.clarke@kidder.com

KIDDER.COM

This information supplied herein is from sources we deem reliable. It is provided without any representation, warranty, or guarantee, expressed or implied as to its accuracy. Prospective Buyer or Tenant should conduct an independent investigation and verification of all matters deemed to be material, including, but not limited to, statements of income and expenses. Consult your attorney, accountant, or other professional advisor.

km Kidder Mathews

FOR LEASE

BMR Port Commercial Center

1400 PORT OF TACOMA RD, TACOMA, WA 98402



KIDDER.COM

This information supplied herein is from sources we deem reliable. It is provided without any representation, warranty, or guarantee, expressed or implied as to its accuracy. Prospective Buyer or Tenant should conduct an independent investigation and verification of all matters deemed to be material, including, but not limited to, statements of income and expenses. Consult your attorney, accountant, or other professional advisor.

km Kidder Mathews

FOR LEASE

BMR Port Commercial Center

1400 PORT OF TACOMA RD, TACOMA, WA 98402

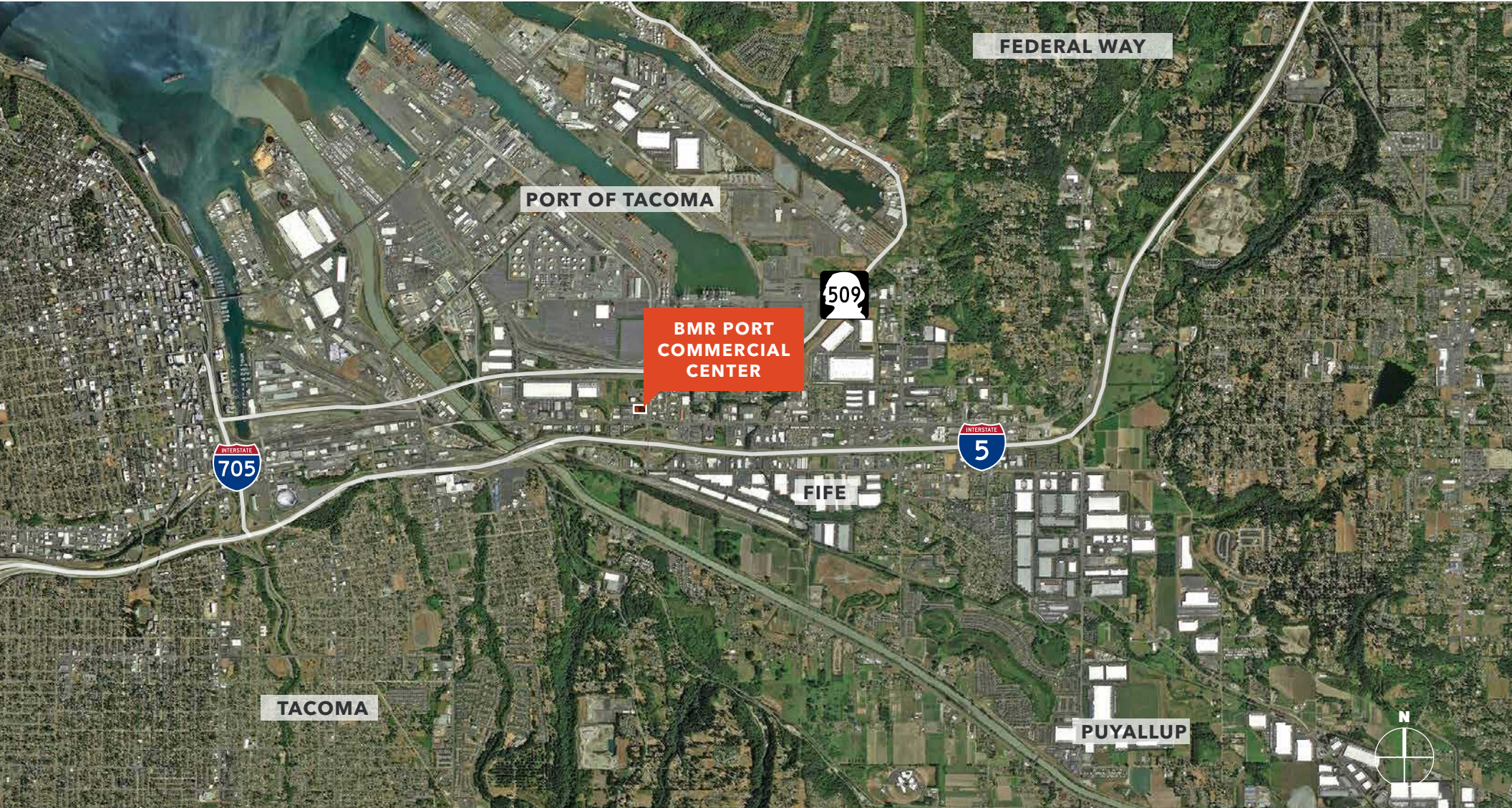

KIDDER.COM

This information supplied herein is from sources we deem reliable. It is provided without any representation, warranty, or guarantee, expressed or implied as to its accuracy. Prospective Buyer or Tenant should conduct an independent investigation and verification of all matters deemed to be material, including, but not limited to, statements of income and expenses. Consult your attorney, accountant, or other professional advisor.

km Kidder Mathews