

# 14340 NE 21ST ST

## DAYCARE FOR LEASE



### LISTING INFORMATION

ADDRESS:	14340 NE 21st Street, Bellevue, WA
AVAILABLE SF:	7,663 SF
LEASE RATE:	Negotiable (NNN)
DATE AVAILABLE:	July 1, 2024
YR BUILT/RENOVATED:	1986 / 1995

### COMMENTS

- » Free standing building with fully built-out daycare space for lease in Bellevue.
- » Property offers convenient access to WA-520, I-405 and abundant amenities along the Bel-Red Corridor.
- » Highly desirable location.

### LOCATION

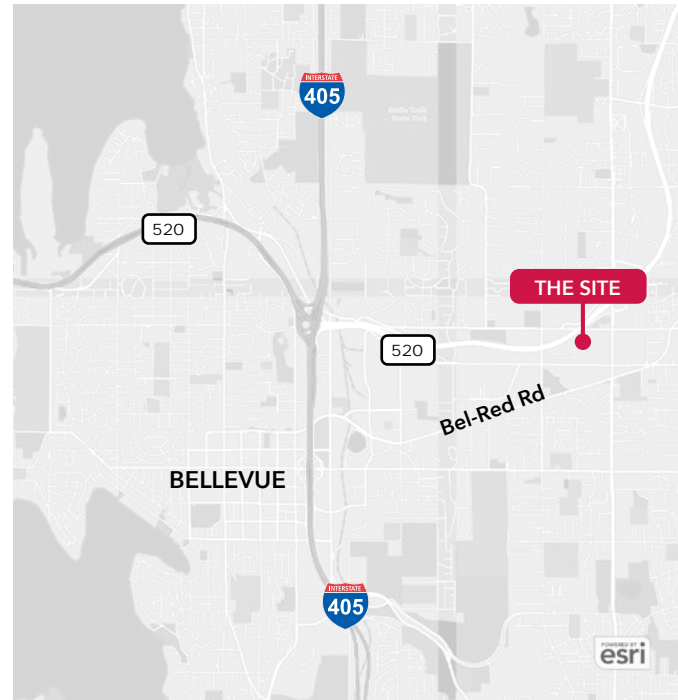

All information furnished regarding property for sale, rental or financing is from sources deemed reliable, but no warranty or representation is made to the accuracy thereof and same is submitted to errors, omissions, change of price, rental or other conditions prior to sale, lease or financing or withdrawal without notice. No liability of any kind is to be imposed on the broker herein.  
Broker Marketing\14340 NE 21 St (21st Day Care)\Lease 2024\14340 NE 21st Street\_Lease Flyer

**Aaron Mathieu**  
amathieu@lee-associates.com  
206.210.5207

**Jim Reed, SIOR**  
jreed@lee-associates.com  
206.210.5202

**Carson Scott**  
cscott@lee-associates.com  
425.818.1538

**14340**  
**NE 21ST ST**  
**7,663 SF Daycare for Lease**

**FLOOR PLAN | AERIAL**

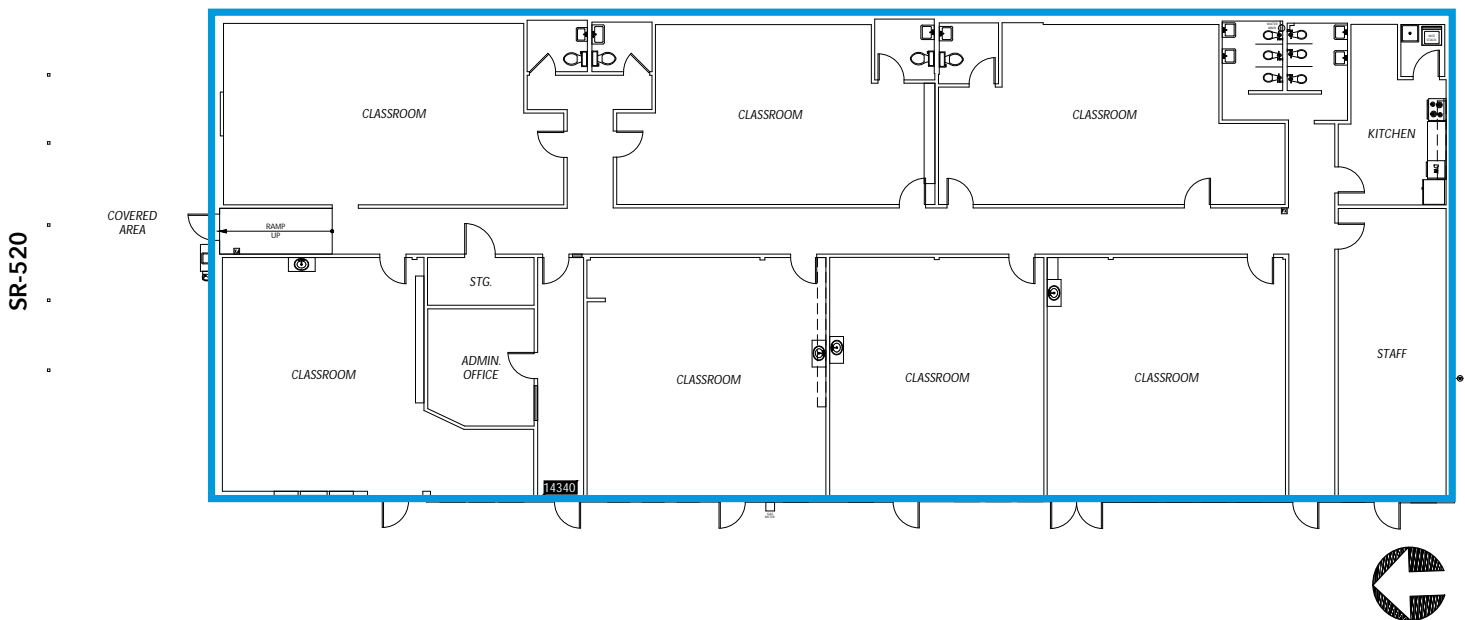

**14340  
NE 21ST ST**

**7,663 SF Daycare for Lease**

**Aaron Mathieu**  
amathieu@lee-associates.com  
206.210.5207

**Jim Reed, SIOR**  
jreed@lee-associates.com  
206.210.5202

**Carson Scott**  
cscott@lee-associates.com  
425.818.1538

**SUITE 14340 INTERIOR PHOTOS**



**14340**  
**NE 21ST ST**

**7,663 SF Daycare for Lease**

**Aaron Mathieu**  
amathieu@lee-associates.com  
206.210.5207

**Jim Reed, SIOR**  
jreed@lee-associates.com  
206.210.5202

**Carson Scott**  
cscott@lee-associates.com  
425.818.1538

**SUITE 14340 INTERIOR PHOTOS**

