



WOODINVILLE LANDING, BLDG A

# FOR LEASE

2,752 - 6,429 SF  
available in a high-image  
flex building in the heart  
of Woodinville, WA

Kidder  
Mathews



FOR LEASE

# Woodinville Landing, Bldg A

17270 WOODINVILLE-REDMOND RD, WOODINVILLE, WA



## High-image space on Woodinville-Redmond Rd

**21,121 SF** flex building

**OFFICE & FLEX** space available immediately

**SUITE 702:** 2,752 SF (all office)

**SUITE 747:** 3,677 SF total  
(2,552 SF office / 1,125 SF warehouse)

**SUITES 702 + 747:** 6,429 SF total  
(5,304 SF office / 1,125 SF warehouse)

**ABUNDANT** parking

**AIR-CONDITIONED** offices with high-end finishes

**CLOSE PROXIMITY** to I-405, SR-522 and downtown Woodinville

**VIEWS** of Sammamish River

**JASON BLOOM**

425.450.1102

[jason.bloom@kidder.com](mailto:jason.bloom@kidder.com)

**TODD GAUTHIER**

425.450.1118

[todd.gauthier@kidder.com](mailto:todd.gauthier@kidder.com)

**CARTER NICHOLSON**

425.450.1145

[carter.nicholson@kidder.com](mailto:carter.nicholson@kidder.com)

[KIDDER.COM](http://KIDDER.COM)

This information supplied herein is from sources we deem reliable. It is provided without any representation, warranty, or guarantee, expressed or implied as to its accuracy. Prospective Buyer or Tenant should conduct an independent investigation and verification of all matters deemed to be material, including, but not limited to, statements of income and expenses. Consult your attorney, accountant, or other professional advisor.



**FOR LEASE**

# Woodinville Landing, Bldg A

17270 WOODINVILLE-REDMOND RD, WOODINVILLE, WA

## Floor Plan

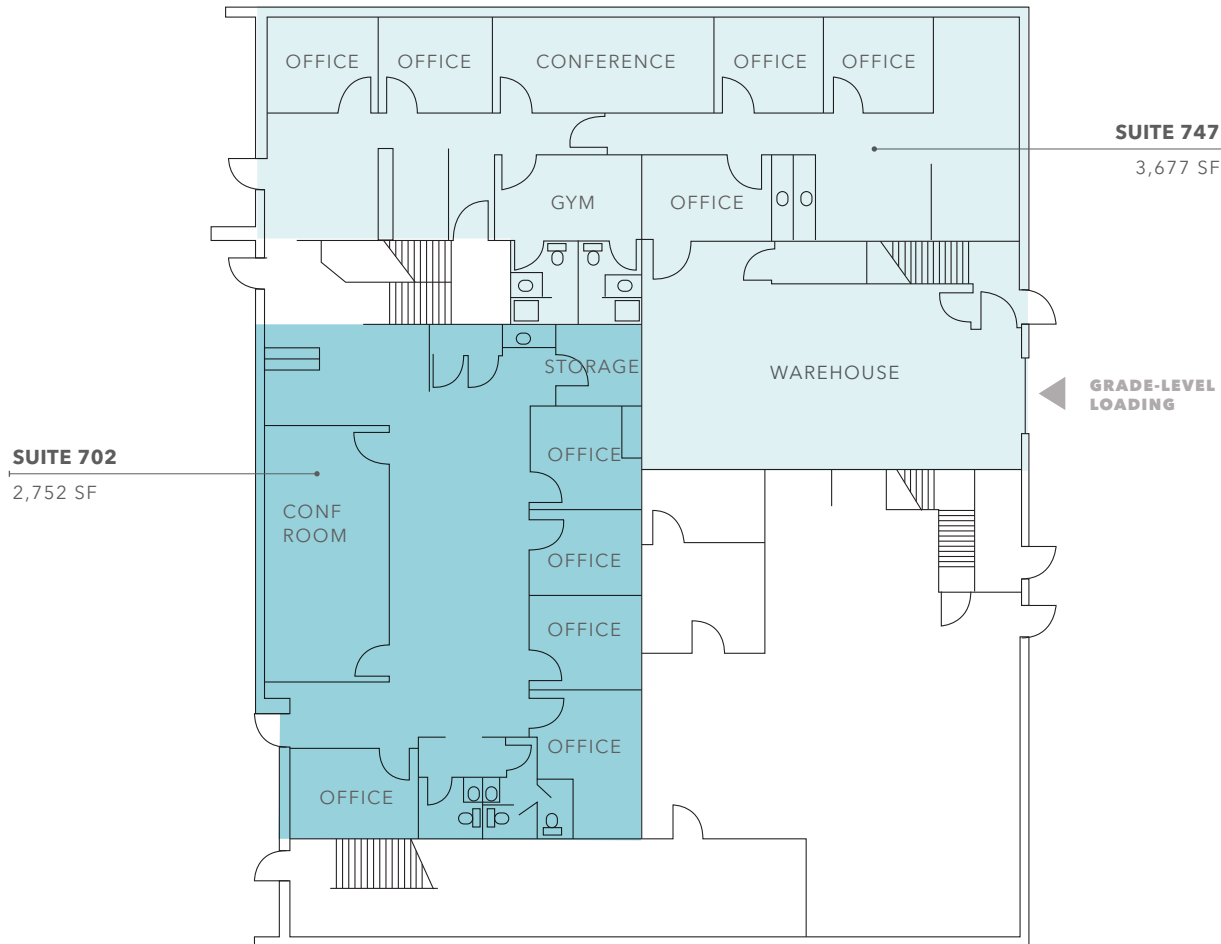

## First-floor office spaces available

**SUITE 702:** 2,752 SF (all office)

**SUITE 747:** 3,677 SF total  
(2,552 SF office / 1,125 SF warehouse)

**SUITES 702 + 747:** Can be combined  
for 6,429 SF total  
(5,304 SF office / 1,125 SF warehouse)

**FURNITURE** available

**PART** of two building business park, providing opportunity for easy expansion of office and office/warehouse space

**JASON BLOOM**  
425.450.1102  
[jason.bloom@kidder.com](mailto:jason.bloom@kidder.com)

**TODD GAUTHIER**  
425.450.1118  
[todd.gauthier@kidder.com](mailto:todd.gauthier@kidder.com)

**CARTER NICHOLSON**  
425.450.1145  
[carter.nicholson@kidder.com](mailto:carter.nicholson@kidder.com)

[KIDDER.COM](http://KIDDER.COM)

This information supplied herein is from sources we deem reliable. It is provided without any representation, warranty, or guarantee, expressed or implied as to its accuracy. Prospective Buyer or Tenant should conduct an independent investigation and verification of all matters deemed to be material, including, but not limited to, statements of income and expenses. Consult your attorney, accountant, or other professional advisor.

 **Kidder Mathews**

# Woodinville Amenities

## EAT + DRINK

- 1 Horseshoe Saloon
- 2 Twisted Cuban Cafe & Bar
- 3 Woodinville Cut Shop Restaurant and Lounge
- 4 Jack in the Box
- 5 Irene Thai Cuisine
- 6 Walla Walla Steak Co
- 7 Taco Bell
- 8 The Pizza Coop & Ale House
- 9 Pho 175
- 10 Panera Bread
- 11 Chipotle Mexican Grill
- 12 Red Robin
- 13 Teddy's Bigger Burgers
- 14 Woodinville Cafe
- 15 Topsy Cow
- 16 Jersey Mike's Subs
- 17 McDonald's
- 18 Pasta Novo Italiano
- 19 Chan's Place

## RETAIL & SERVICES

- 1 Home Depot
- 2 24 Hour Fitness
- 3 Target
- 4 World Market
- 5 Barnes & Noble
- 6 Party City
- 7 TJ Maxx
- 8 Rite Aid

## WINERIES & BREWERIES

- 1 Black Raven Brewery
- 2 Woodinville Wine Cellars
- 3 Two Vintners
- 4 20 Corners Brewing
- 5 Hopheads Taproom
- 6 Martedi Winery
- 7 Stomani Cellars
- 8 Matthews Winery
- 9 The Woodhouse Wine Estates
- 10 Sumerian Brewing Company

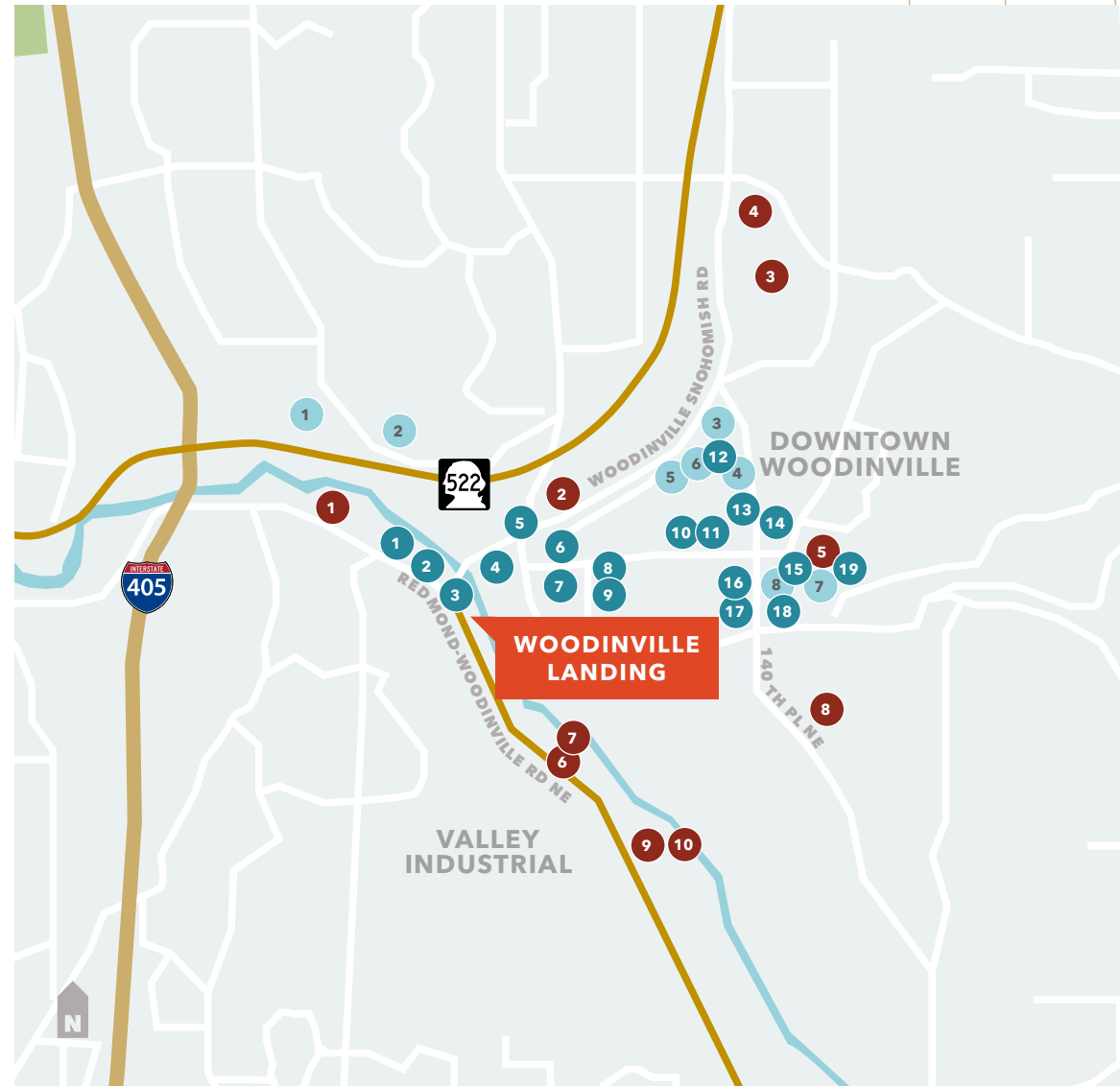

KIDDER.COM

This information supplied herein is from sources we deem reliable. It is provided without any representation, warranty, or guarantee, expressed or implied as to its accuracy. Prospective Buyer or Tenant should conduct an independent investigation and verification of all matters deemed to be material, including, but not limited to, statements of income and expenses. Consult your attorney, accountant, or other professional advisor.

