

SUN LEE BUILDING FOR LEASE - 41,030 SF

3651 200TH ST E | UNINCORPORATED PIERCE COUNTY (FREDERICKSON)

RARE SMALL INDUSTRIAL SPACE - FREDERICKSON MARKET

AVAILABLE FOR LEASE 41,030 SF

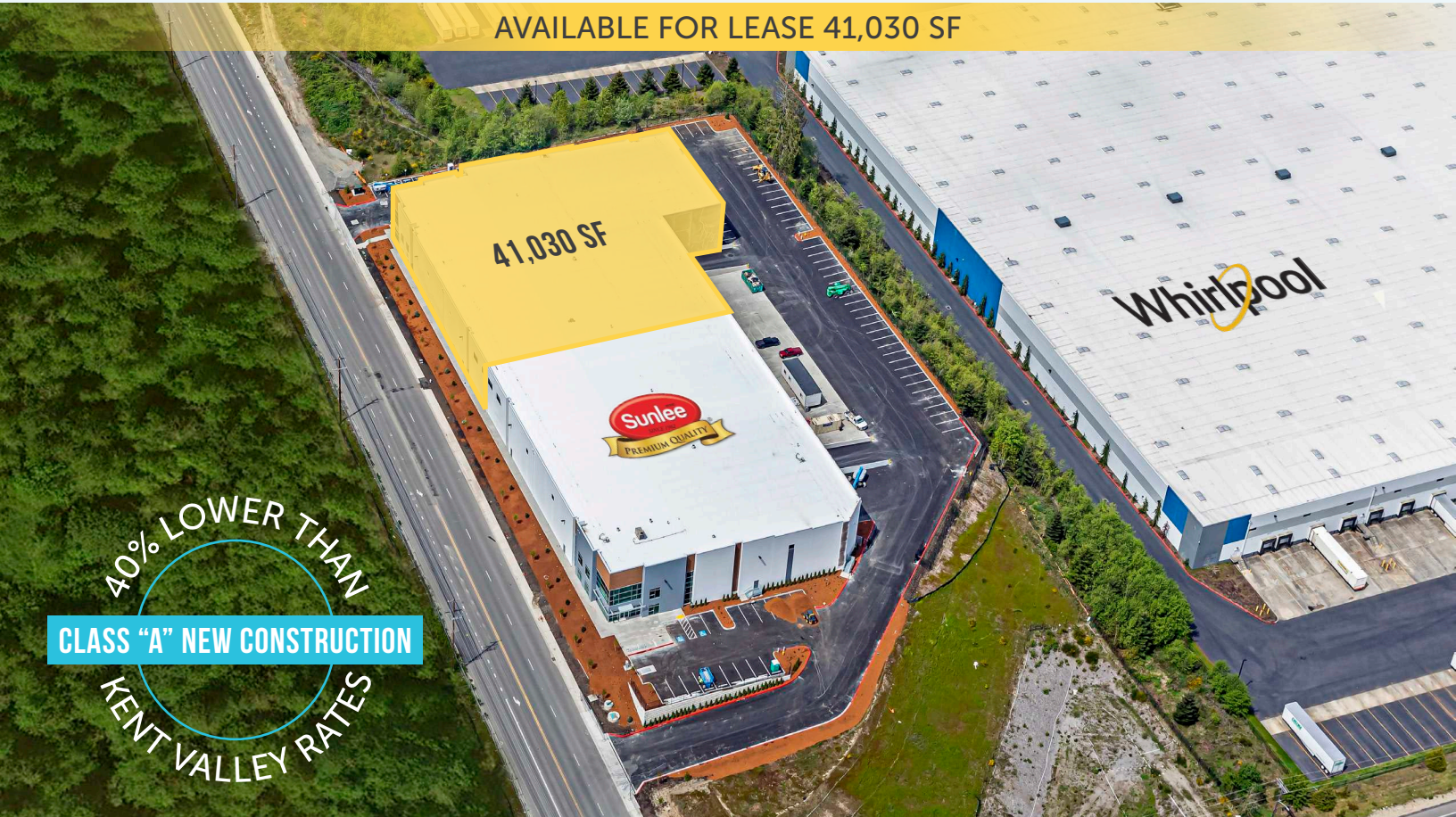

LEASE INFO

Building Size:	82,215 SF
Available Size:	41,030 SF
Office Size:	Built-To-Suit
Parcel Size:	6 Acres
Lease Rate:	\$0.75/SF/Mo (Shell)
Lease Type:	NNN

Short term or dead storage deals considered!

PROPERTY HIGHLIGHTS

1 (12x14) GL Door & 5 (9x10) DH Doors

36' Clear Height

56' x 60' Column Spacing

Sprinkler System - ESFR, K-17 Heads

Dock Equipment - 40k Lb. Hydraulic Dock Levelers, Seals and Lights at Each Position

Power - 277/480, +/- 800 Amps

Truck Court Depth - 128'

Truck Apron - 60' Reinforced



SCOTT PRICE
253.779.2419

sprice@neilwalter.com

KERMIT JORGENSEN
206.787.1475

kjorgensen@neilwalter.com

All information references in this document are approximate. The information contained herein is contained from sources deemed reliable. It is provided without representation, warranty, or guarantee, expressed or implied as to accuracy. Prospective buyer or tenant should conduct its own independent investigation relating to the property, government codes and regulations, allowed uses, and all other matters, regardless of whether they are referred to or contained in this document.

SUN LEE BUILDING

3651 200TH ST E | UNINCORPORATED PIERCE COUNTY (FREDERICKSON)

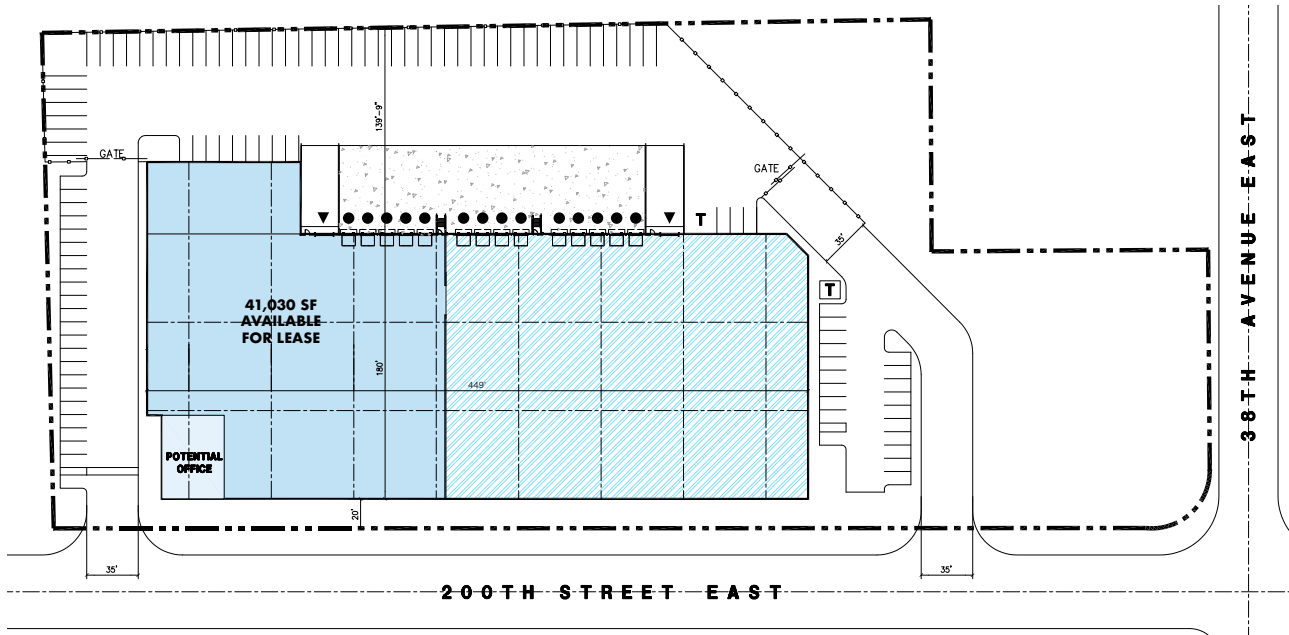

SCOTT PRICE
253.779.2419
sprice@neilwalter.com

KERMIT JORGENSEN
206.787.1475
kjorgensen@neilwalter.com

1940 East D St, #100
Tacoma, WA 98421
253.779.8400
www.neilwalter.com

All information references in this document are approximate. The information contained herein is contained from sources deemed reliable. It is provided without representation, warranty, or guarantee, expressed or implied as to accuracy. Prospective buyer or tenant should conduct its own independent investigation relating to the property, government codes and regulations, allowed uses, and all other matters, regardless of whether they are referred to or contained in this document.

SUN LEE BUILDING

3651 200TH ST E | UNINCORPORATED PIERCE COUNTY (FREDERICKSON)



SCOTT PRICE
253.779.2419
sprice@neilwalter.com

KERMIT JORGENSEN
206.787.1475
kjorgensen@neilwalter.com

1940 East D St, #100
Tacoma, WA 98421
253.779.8400
www.neilwalter.com

All information references in this document are approximate. The information contained herein is contained from sources deemed reliable. It is provided without representation, warranty, or guarantee, expressed or implied as to accuracy. Prospective buyer or tenant should conduct its own independent investigation relating to the property, government codes and regulations, allowed uses, and all other matters, regardless of whether they are referred to or contained in this document.