

FOR GROUND LEASE OR BUILD TO SUIT

SEQUIM RETAIL PADS

190 N PRIEST RD, SEQUIM, WA 98382



Walmart

Marshalls

O'Reilly
AUTO PARTS

AspenDental

T-Mobile

Jack
in the box

MATTRESS FIRM

DISCOUNT
TIRE

SALLY BEAUTY

Ben's
Bikes

First Federal

petco

Michaels

ROSS

COSTCO
WHOLESALE

ULTA
BEAUTY

THE HOME
DEPOT

SPORTSMAN'S
WEAVERS

TacoTime

Quality
INN & SUITES

Applebee's

101



PROPERTY HIGHLIGHTS

ADDRESS

190 N Priest Rd
Sequim, WA 98382

LOCATION

Located in the retail hub of
Sequim, WA

AVAILABLE

Bldg 1: 12,000 SF
Bldg 2: Drive-Thru Pad For
Ground Lease or BTS

PRICING

Call broker for rates

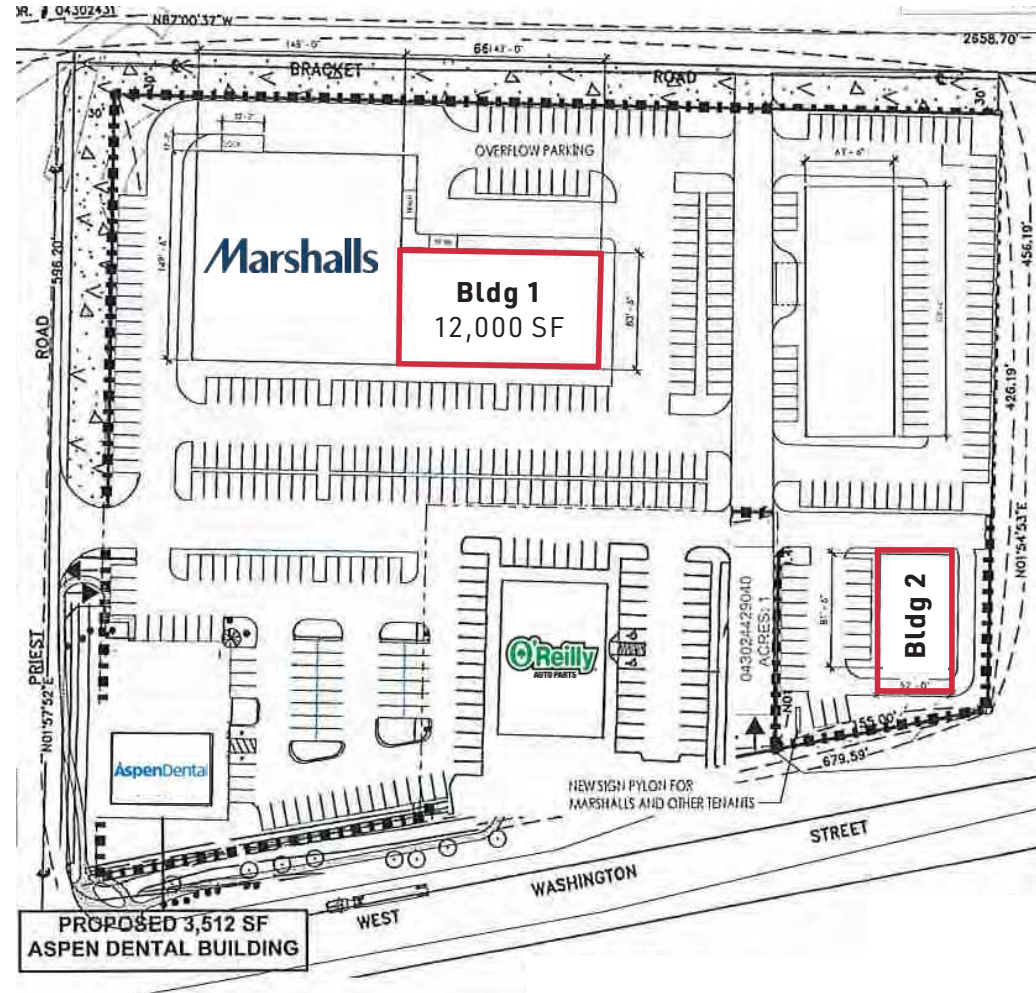

RICK GRAFF

+1 206 332 1493
rgraff@nai-psp.com

BARRY KELLY

+1 425 586 5625
bkelly@nai-psp.com

ANDREW GRAFF

+1 203 336 1486
agruff@nai-psp.com

KYLE GRAFF

+1 203 336 1494
kgraff@nai-psp.com

DEMOGRAPHIC OVERVIEW

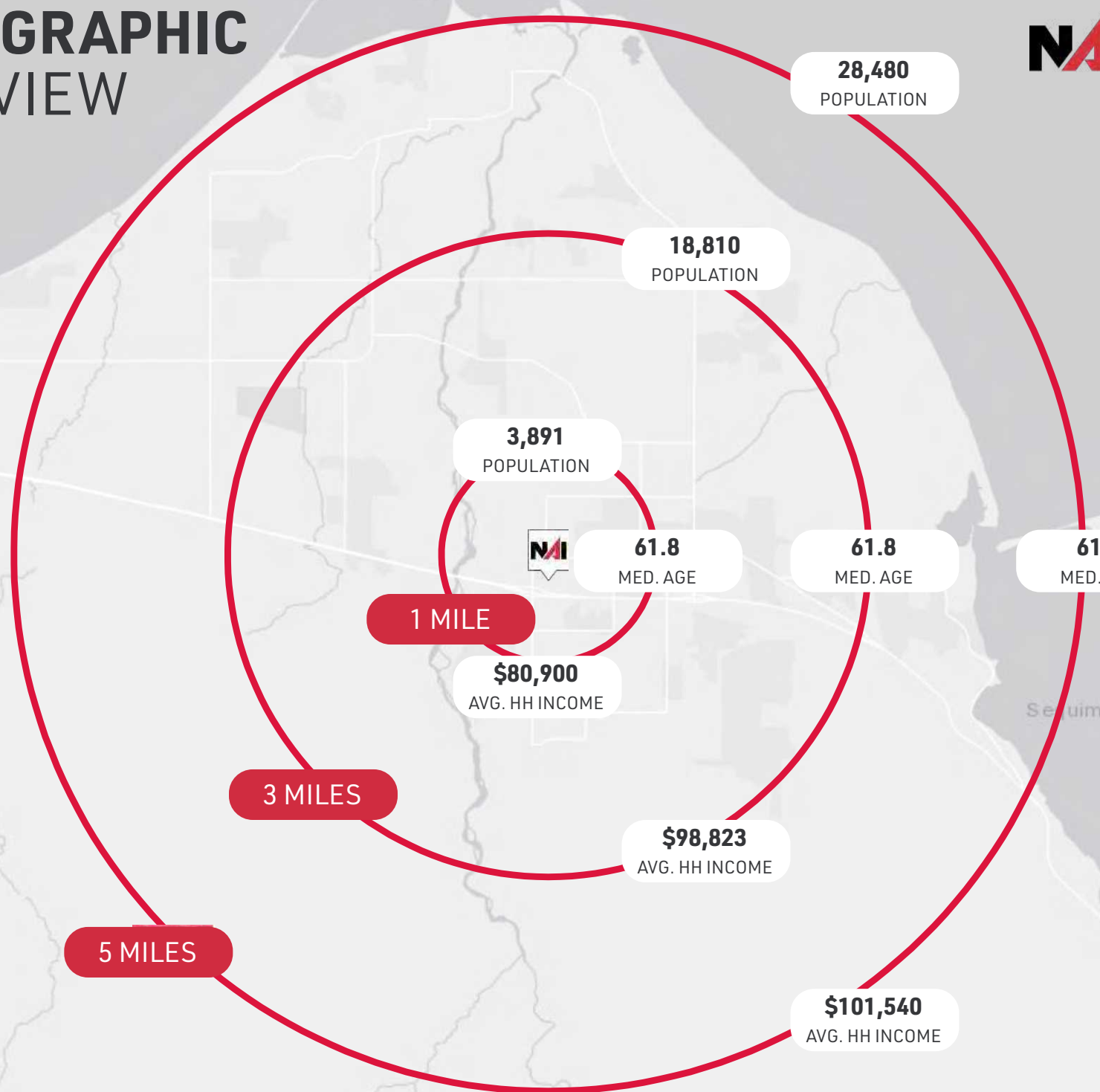

28,480
POPULATION

18,810
POPULATION

3,891
POPULATION

61.8
MED. AGE

61.8
MED. AGE

61.6
MED. AGE

1 MILE

\$80,900
AVG. HH INCOME

3 MILES

\$98,823
AVG. HH INCOME

5 MILES

\$101,540
AVG. HH INCOME

Dungeness Bay

Sequim Bay

FOR GROUND LEASE OR BUILD TO SUIT

SEQUIM RETAIL PADS
190 N PRIEST RD, SEQUIM, WA 98382

EXCLUSIVELY MARKETING BY:

RICK GRAFF

NAI Puget Sound Properties
+1 206 332 1493
rgraff@nai-psp.com

BARRY KELLY

NAI Puget Sound Properties
+1 425 586 5625
bkelly@nai-psp.com

ANDREW GRAFF

NAI Puget Sound Properties
+1 203 336 1486
agraff@nai-psp.com

KYLE GRAFF

NAI Puget Sound Properties
+1 203 336 1494
kgraff@nai-psp.com



Bellevue | Tacoma

nai-psp.com

THE INFORMATION CONTAINED HEREIN HAS BEEN GIVEN TO US BY THE OWNER OF THE PROPERTY OR OTHER SOURCES WE DEEM RELIABLE. WE HAVE NO REASON TO DOUBT ITS ACCURACY, BUT WE DO NOT GUARANTEE IT. ALL INFORMATION SHOULD BE VERIFIED PRIOR TO PURCHASE OR LEASE. SEQUIM RETAIL PADS (190 N PRIEST RD) - DESIGN 2