

FOR LEASE



FORMER COSTA VIDA SPACE

SUITE C

Lease Rate: \$35.00 PSF, NNN

Suite Size: ±2,480 SF

BUILDING DETAILS

Total Building Size: ±7,720 SF

Year Built: 2014

Lot Size: ±62,234 SF

Parcel #: 36202.0087

CO-TENANTS:

Verizon

Sherwin-Williams

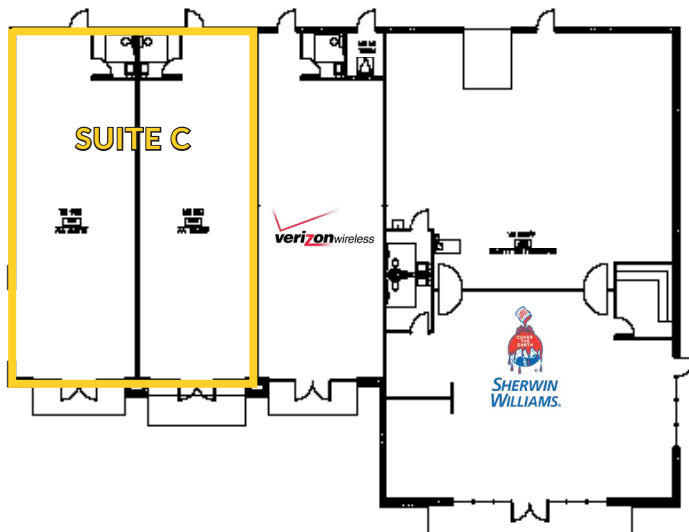

RETAIL SPACE FOR LEASE

9412 N Newport Highway
Spokane, WA 99218

CHAD CARPER, BROKER

D | 509.755.7572

C | 509.991.2222

chad.carper@kiemlehagood.com

**KIEMLE
HAGOOD**

INTERIOR PHOTOS

9412 N Newport Highway
Spokane, WA 99218



SURROUDNING AREA

9412 N Newport Highway
Spokane, WA 99218



DEMOGRAPHICS	1 MILE	3 MILES	5 MILES
2023 Population	11,074	76,199	175,279
Average HHI	\$102,611	\$96,643	\$98,678
Daytime Demos	10,829	47,568	99,736

TRAFFIC COUNTS	AVERAGE DAILY TRAFFIC
N Newport Highway	±23,348 ADT
E Holland Avenue	±9,845 ADT



- ### NEARBY BUSINESSES
- Applebee's
 - Azteca Mexican Restaurants
 - Bath & Body Works
 - Bets Buy
 - Chipotle Mexican Grill
 - Dick's Sporting Goods
 - Famous Footwear
 - Muv Fitness
 - Olive Garden
 - Panda Express
 - Papa Murphy's
 - Safeway
 - Staples
 - Subway
 - Taco Bell
 - Target
 - Total Wine & More
 - TJMaxx
 - ...& more!!

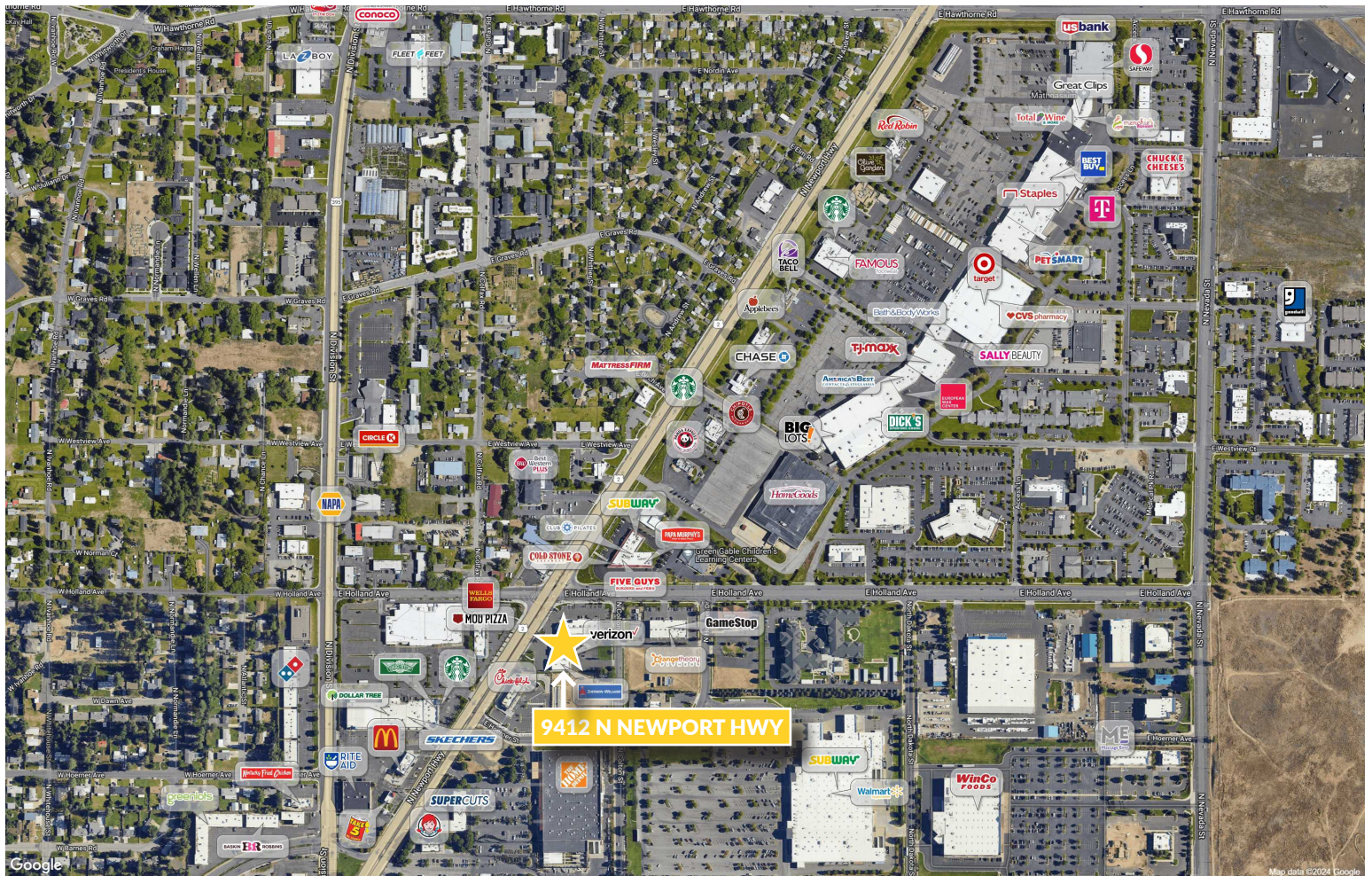

RETAIL SPACE FOR LEASE

9412 N Newport Highway
Spokane, WA 99218

CHAD CARPER, BROKER

D | 509.755.7572

C | 509.991.2222

chad.carper@kiemlehagood.com

**KIEMLE
HAGOOD**

601 WEST MAIN AVENUE, SUITE 400
SPOKANE, WA 99201

OFFICE LOCATIONS

SPOKANE | COEUR D'ALENE | TRI-CITIES | PALOUSE | MISSOULA

No warranty or representation, expressed or implied, is made by Kiemle Hagood, its agents or its employees as to the accuracy of the information contained herein. All information furnished is from sources deemed reliable and submitted subject to errors, omissions, change of terms and conditions, prior sale, lease or financing, or withdrawal without notice. No one should rely solely on the above information, but instead should conduct their own investigation to independently satisfy themselves.

Kiemle Hagood respects the intellectual property of others:

If you believe the copyright in your work has been violated through this Website, please contact our office for notice of claims of copyright infringement. For your complaint to be valid under the Digital Millennium Copyright Act of 1998 (DMCA), you must provide the following information when providing notice of the claimed copyright infringement: identify the material on the Website that you believe infringes your work, with enough detail so that we may locate it on the Website; provide your address, telephone number and email address; provide a statement that you have a good faith belief that the disputed use is not authorized by the copyright owner, its agent, or the law; provide a statement that the information in the notification is accurate, and under penalty of perjury, that the complaining party is authorized to act on behalf of the owner of an exclusive right that is allegedly infringed; and provide your physical or electronic signature. Upon receiving your complaint, Kiemle Hagood will, upon review, remove content that you believe infringes your copyright if the complaint is found to be valid.

