

MODERA®

BY MILL CREEK
BROADWAY



WCCR

West Coast Commercial Realty

1812 - 1818 BROADWAY | SEATTLE, WA 98122

MODERA[®]

1812 - 1818 BROADWAY | SEATTLE, WA 98122

BY MILL CREEK
BROADWAY



Join Modera Broadway, a mixed-use development project split between two buildings, in the heart of Capitol Hill.

The first building, located at 1812 Broadway consists of 139 units and the second building is located at 1818 Broadway with 89 units. Modera Broadway is surrounded by a dense residential population as well as emerging restaurants, bars, breweries, shopping and entertainment. The site is less than two blocks from the Capitol Hill Streetcar and Light Rail Station providing easy access to Downtown Seattle, Pioneer Square and South Lake Union. Join this vibrant neighborhood in the commercial core of Capitol Hill.





MODERA[®]
BY MILL CREEK
BROADWAY



99
Walk Score
"Walker's Paradise"



100
Transit Score
"Rider's Paradise"



89
Bike Score
"Very Bikeable"



**TOTAL
POPULATION**

1-Mile: 94,742
2-Mile: 208,483
3-Mile: 277,605



**AVERAGE
HOUSEHOLD
INCOME**

1-Mile: \$122,971
2-Mile: \$133,395
3-Mile: \$134,210

Tiffini Connell | Jonathan Willett | Avery Connell (206) 283-5212 www.wccommercialrealty.com

WCCR

West Coast Commercial Realty

DISCLAIMER: The above information has been secured from sources believed to be reliable, however, no representations are made to its accuracy. Prospective tenants or buyers should consult their professional advisors and conduct their own independent investigation. Site plan and configuration are subject to change. Properties are subject to change in price and/or availability without notice. West Coast Commercial Realty, LLC



MODERA[®]
BY MILL CREEK
BROADWAY

LEGEND

SEATTLE STREETCAR



MODERA[®]

BY MILL CREEK
BROADWAY

1812 - 1818 BROADWAY | SEATTLE, WA 98122



SITE PLAN

Street Level Facing Nagle Place

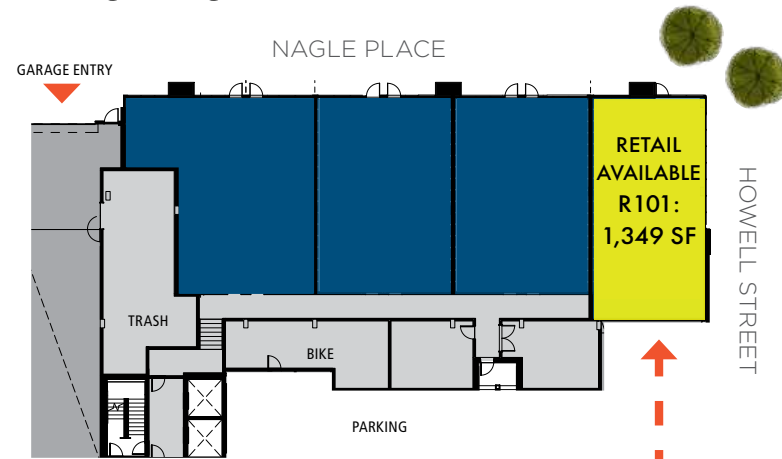

Street Level Facing Broadway

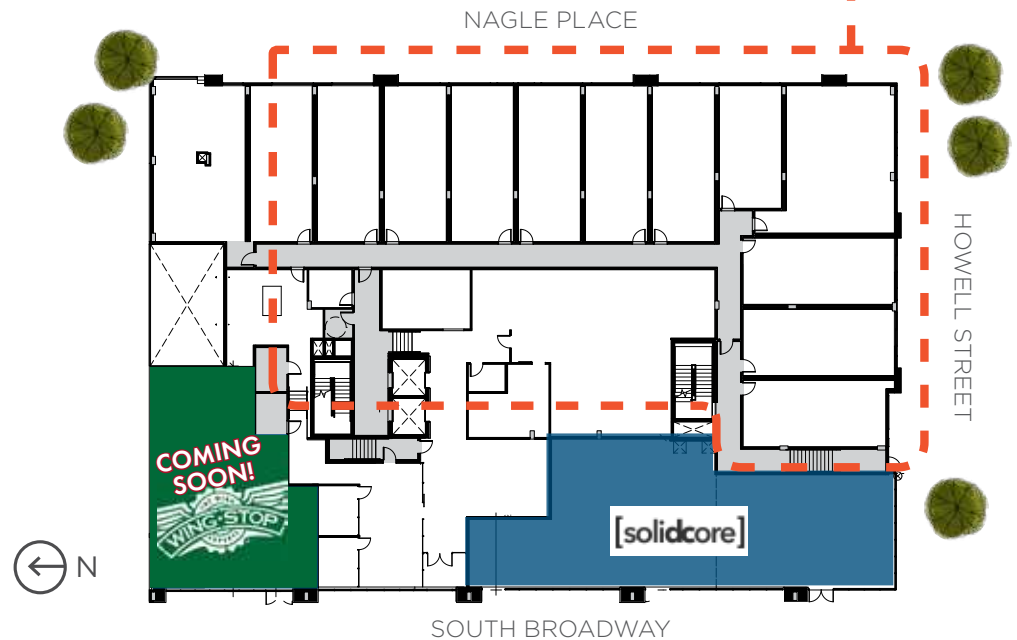

Tiffini Connell | Jonathan Willett | Avery Connell (206) 283-5212 www.wccommercialrealty.com

WCCR

DISCLAIMER: The above information has been secured from sources believed to be reliable, however, no representations are made to its accuracy. Prospective tenants or buyers should consult their professional advisors and conduct their own independent investigation. Site plan and configuration are subject to change. Properties are subject to change in price and/or availability without notice. West Coast Commercial Realty, LLC

West Coast Commercial Realty

m
MODERA[®]
BY MILL CREEK
BROADWAY



Tiffini Connell | Jonathan Willett | Avery Connell (206) 283-5212 www.wccommercialrealty.com

DISCLAIMER: The above information has been secured from sources believed to be reliable, however, no representations are made to its accuracy. Prospective tenants or buyers should consult their professional advisors and conduct their own independent investigation. Site plan and configuration are subject to change. Properties are subject to change in price and/or availability without notice. West Coast Commercial Realty, LLC

WCCR
West Coast Commercial Realty