

The Bristol at Southport

RETAIL FOR LEASE

1083-1133 Lake Washington Blvd N,
Renton, WA 98056



Anchovies
in Salt



PRIME RETAIL OPPORTUNITY: WATERFRONT RETAIL FOR LEASE

KENNEDY WILSON

Tiffini Connell | Avery Connell

(206) 283-5212
www.wccommercialrealty.com

WCCR

West Coast Commercial Realty



DISCLAIMER: The above information has been secured from sources believed to be reliable, however, no representations are made to its accuracy. Prospective tenants or buyers should consult their professional advisors and conduct their own independent investigation. Site plan and configuration are subject to change. Properties are subject to change in price and/or availability without notice. West Coast Commercial Realty, LLC

The Bristol at Southport

RETAIL FOR LEASE

1083-1133 Lake Washington Blvd N,
Renton, WA 98056

Welcome to **The Bristol at Southport**, a modern, resort-style community in Renton, Washington. Join this waterfront, luxury community with 383 apartments between two buildings directly next to three Southport office campus buildings and the Hyatt Regency. Conveniently located near The Renton Landing, a high-end lifestyle and entertainment center, with easy access to I-405 to downtown Bellevue, I-90 corridor, 10 minutes to Sea-Tac International Airport, and less than 20 minutes from downtown Seattle. Perfect opportunity for retailers and a restaurant operator to join this project to create a high-end, destination waterfront dining experience.

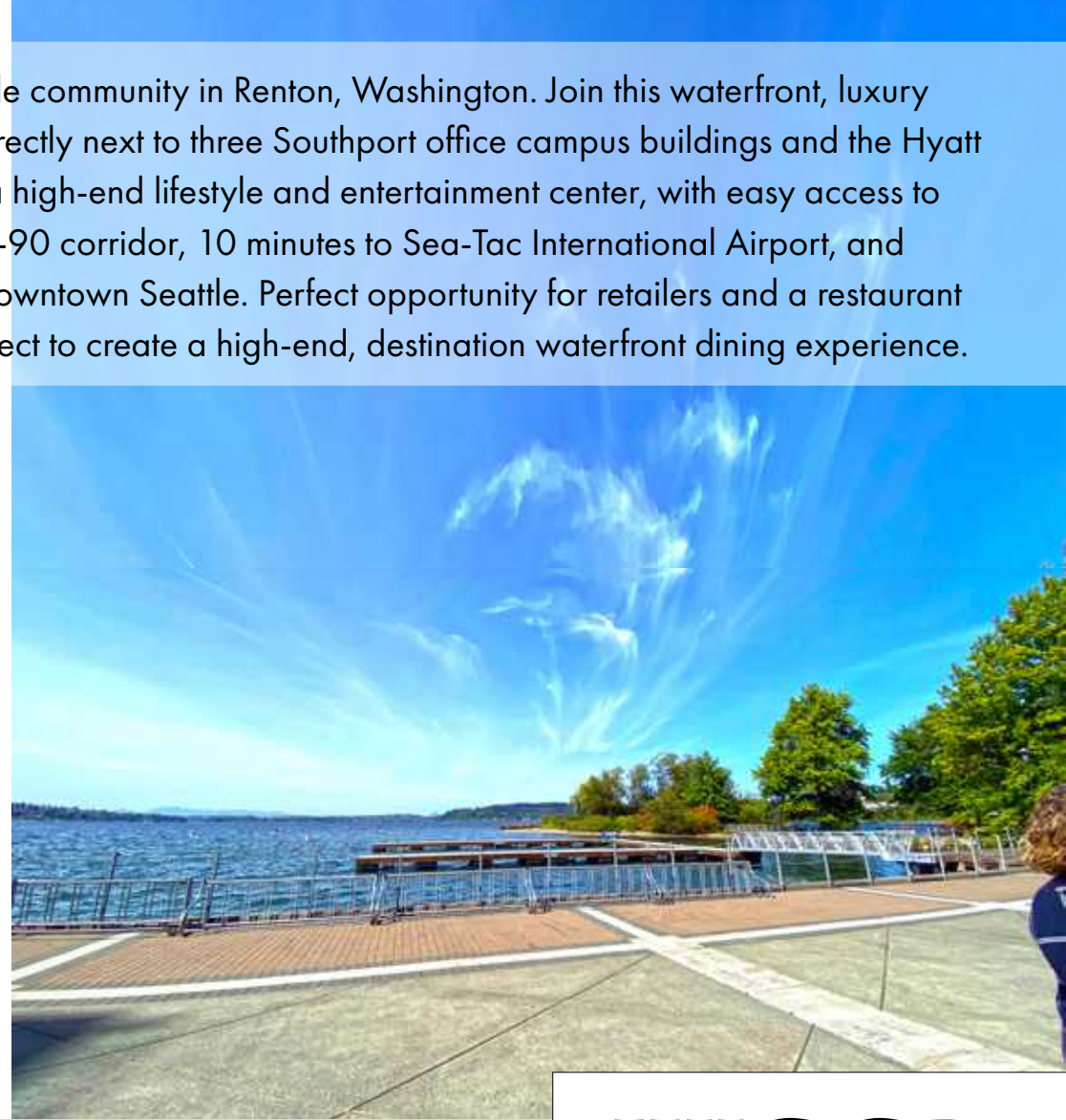

KENNEDY WILSON

Tiffini Connell | Avery Connell

(206) 283-5212

www.wccommercialrealty.com

WCCR

West Coast Commercial Realty



DISCLAIMER: The above information has been secured from sources believed to be reliable, however, no representations are made to its accuracy. Prospective tenants or buyers should consult their professional advisors and conduct their own independent investigation. Site plan and configuration are subject to change. Properties are subject to change in price and/or availability without notice. West Coast Commercial Realty, LLC

The Bristol at Southport

RETAIL FOR LEASE

1083-1133 Lake Washington Blvd N,
Renton, WA 98056



KENNEDY WILSON

Tiffini Connell | Avery Connell

(206) 283-5212

www.wccommercialrealty.com

WCCR

West Coast Commercial Realty



DISCLAIMER: The above information has been secured from sources believed to be reliable, however, no representations are made to its accuracy. Prospective tenants or buyers should consult their professional advisors and conduct their own independent investigation. Site plan and configuration are subject to change. Properties are subject to change in price and/or availability without notice. West Coast Commercial Realty, LLC

The Bristol at Southport

RETAIL FOR LEASE

1083-1133 Lake Washington Blvd N,
Renton, WA 98056



KENNEDY WILSON

Tiffini Connell | Avery Connell

(206) 283-5212

www.wccommercialrealty.com

WCCR

West Coast Commercial Realty



DISCLAIMER: The above information has been secured from sources believed to be reliable, however, no representations are made to its accuracy. Prospective tenants or buyers should consult their professional advisors and conduct their own independent investigation. Site plan and configuration are subject to change. Properties are subject to change in price and/or availability without notice. West Coast Commercial Realty, LLC

The Bristol at Southport

RETAIL FOR LEASE

1083-1133 Lake Washington Blvd N,
Renton, WA 98056



KENNEDY WILSON

Tiffini Connell | Avery Connell

(206) 283-5212
www.wccommercialrealty.com

WCCR

West Coast Commercial Realty

CBA ICSC CoStar POWERBROKER

DISCLAIMER: The above information has been secured from sources believed to be reliable, however, no representations are made to its accuracy. Prospective tenants or buyers should consult their professional advisors and conduct their own independent investigation. Site plan and configuration are subject to change. Properties are subject to change in price and/or availability without notice. West Coast Commercial Realty, LLC

The Bristol at Southport

RETAIL FOR LEASE

1083-1133 Lake Washington Blvd N,
Renton, WA 98056

DEMOGRAPHICS

TOTAL POPULATION

1-Mile: 49,267
2-Mile: 209,516
5-Mile: 453,295

TOTAL EMPLOYEES

1-Mile: 110,155
2-Mile: 313,177
5-Mile: 475,895

AVERAGE HOUSEHOLD INCOME

1-Mile: \$101,978
2-Mile: \$135,623
5-Mile: \$140,920

KENNEDY WILSON

Tiffini Connell | Avery Connell

(206) 283-5212

www.wccommercialrealty.com

WCCR

West Coast Commercial Realty



DISCLAIMER: The above information has been secured from sources believed to be reliable, however, no representations are made to its accuracy. Prospective tenants or buyers should consult their professional advisors and conduct their own independent investigation. Site plan and configuration are subject to change. Properties are subject to change in price and/or availability without notice. West Coast Commercial Realty, LLC

The Bristol at Southport

RETAIL FOR LEASE

1083-1133 Lake Washington Blvd N,
Renton, WA 98056

Suite 3
1,591 SF
Fitness space
+
557 SF mezzanine

Bristol I Site Plan

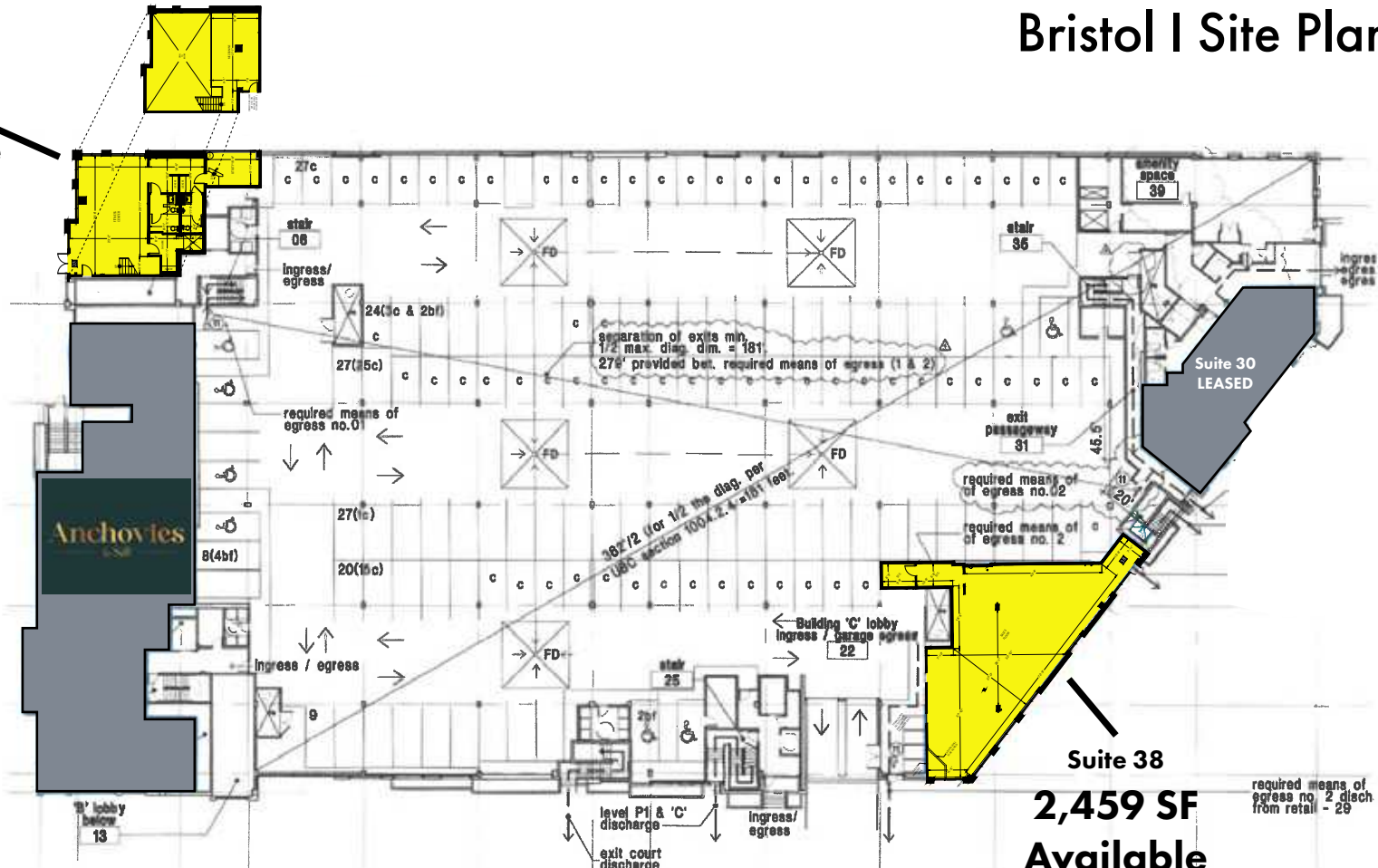

f Lake Washington



f to the Hyatt

Suite 38
2,459 SF
Available
can be demised

KENNEDY WILSON

Tiffini Connell | Avery Connell

(206) 283-5212

www.wccommercialrealty.com

WCCR

West Coast Commercial Realty



DISCLAIMER: The above information has been secured from sources believed to be reliable, however, no representations are made to its accuracy. Prospective tenants or buyers should consult their professional advisors and conduct their own independent investigation. Site plan and configuration are subject to change. Properties are subject to change in price and/or availability without notice. West Coast Commercial Realty, LLC

The Bristol at Southport

RETAIL FOR LEASE

1083-1133 Lake Washington Blvd N,
Renton, WA 98056

Suite 90
4,084 SF
Available
can be demised

Bristol II Site Plan

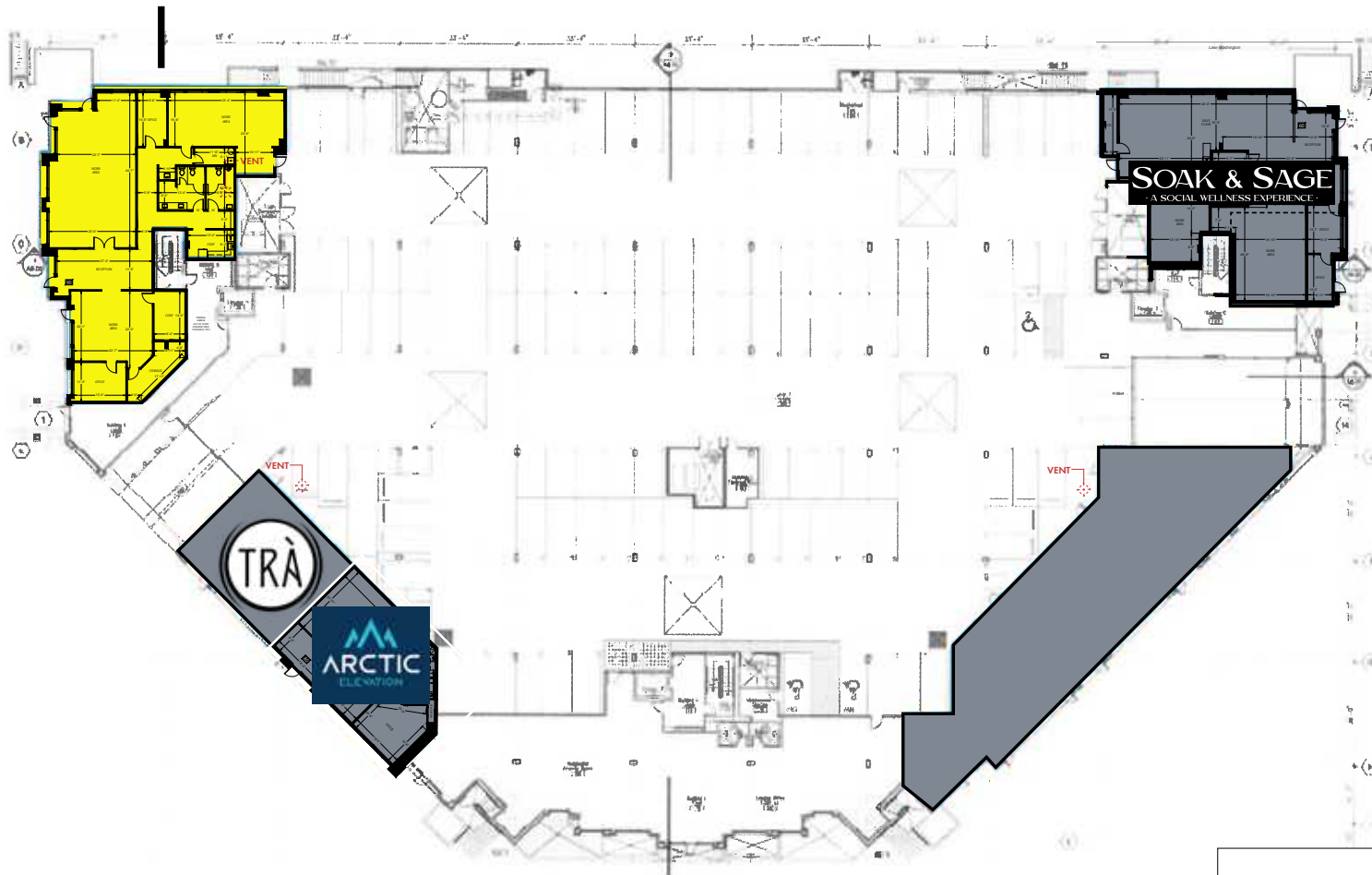

KENNEDY WILSON

Tiffini Connell | Avery Connell

(206) 283-5212
www.wccommercialrealty.com

WCCR

West Coast Commercial Realty



DISCLAIMER: The above information has been secured from sources believed to be reliable, however, no representations are made to its accuracy. Prospective tenants or buyers should consult their professional advisors and conduct their own independent investigation. Site plan and configuration are subject to change. Properties are subject to change in price and/or availability without notice. West Coast Commercial Realty, LLC