

FOR LEASE



SUITE 1

OFFICE SPACE

SUITE 1

Lease Rate: \$15.00 PSF + NNN

Suite Space: ±4,948 RSF

SUITE 14

Lease Rate: \$13.00 PSF + NNN

Suite Space: ±19,678 RSF

2ND FLOOR OFFICE

Lease Rate: \$13.00 PSF + NNN

Suite Space: ±95,000 RSF

BUILDING AMENITIES:

- Gym and showers
- Cafeteria area
- Building conference room
- 4:1,000 Parking ratio
- Close to restaurants & shopping



LIBERTY LAKE BUSINESS PARK

22425 E Appleway Avenue
Liberty Lake, WA 99019

**View
Location**



CRAIG SOEHREN, BROKER

509.755.7548

craigs@kiemleahagood.com

**KIEMLE
HAGOOD**

FIRST FLOOR

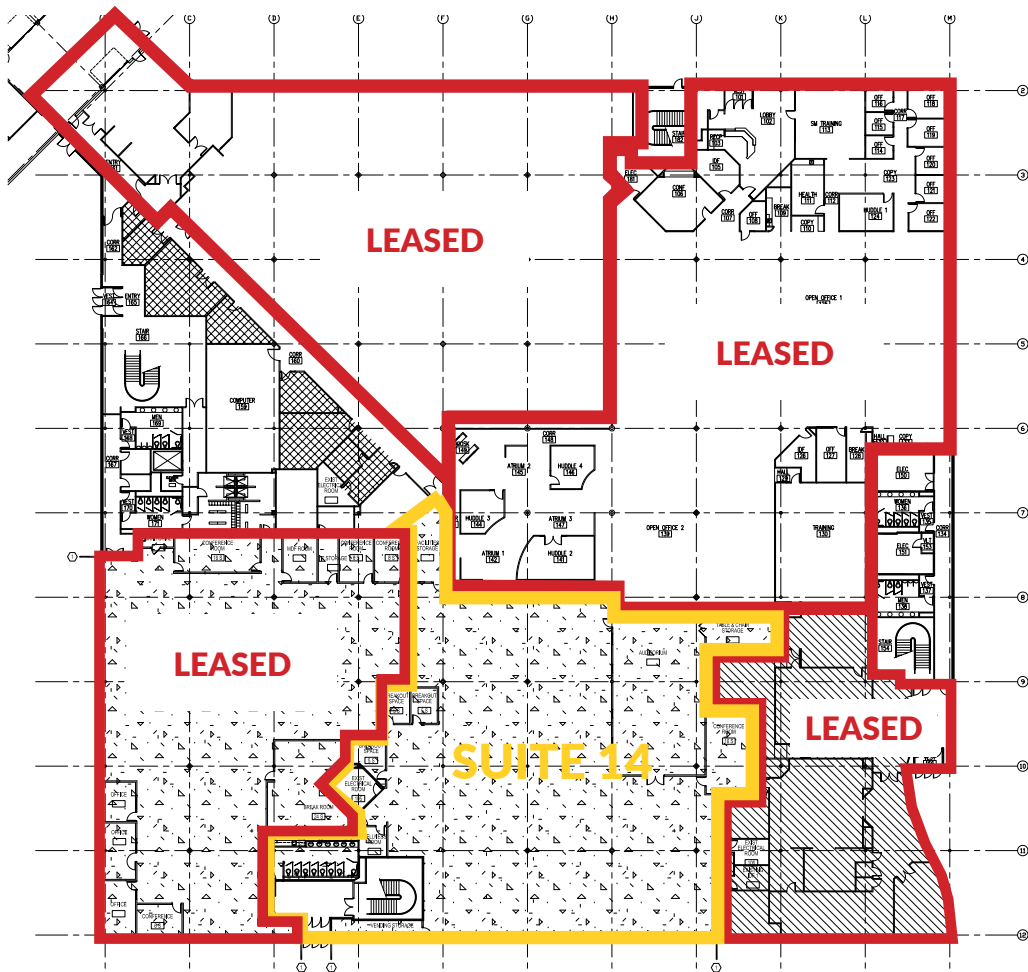
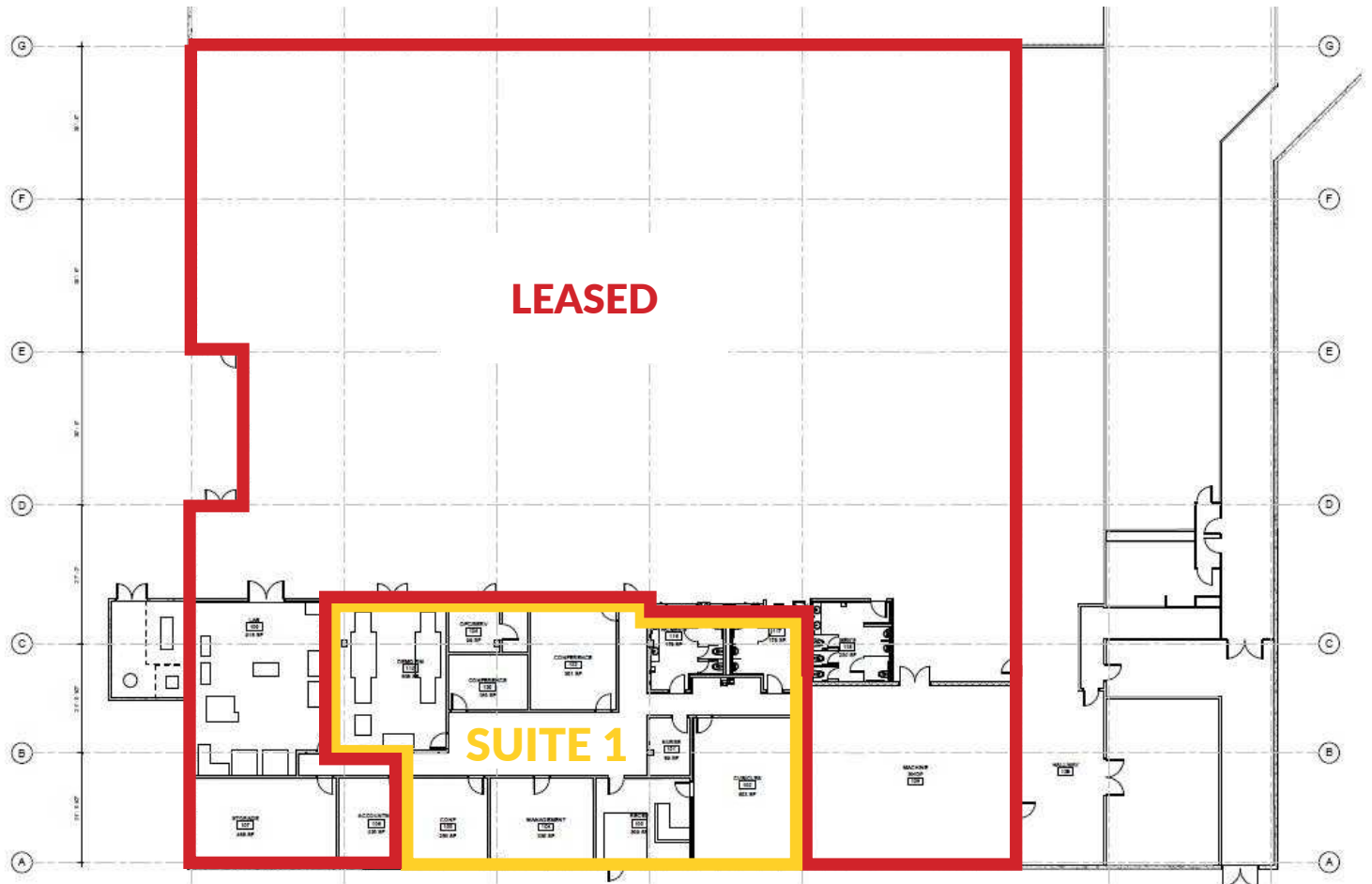

2ND FLOOR



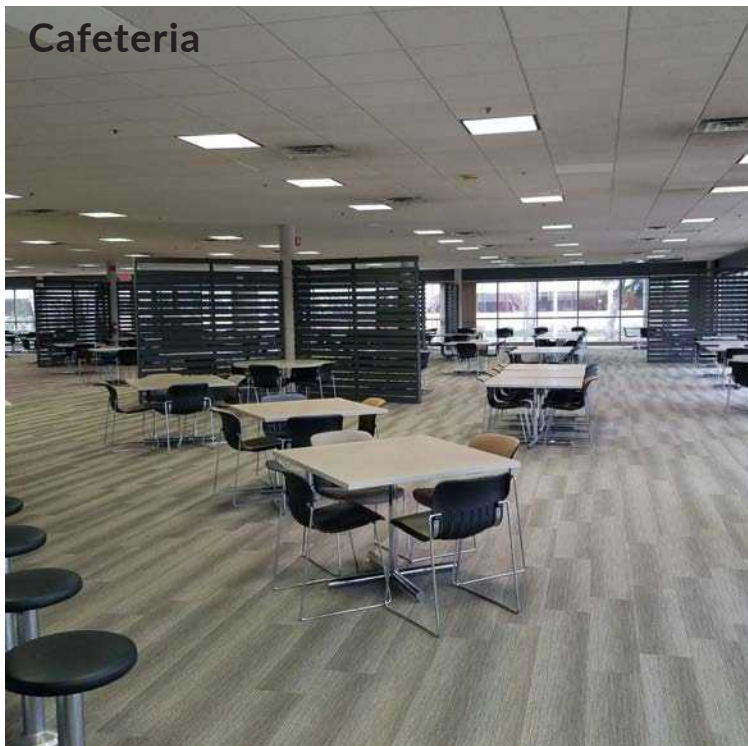

Cafeteria



Gym

LIBERTY LAKE BUSINESS PARK

22425 E Appleway Avenue
Liberty Lake, WA 99019

601 WEST MAIN AVENUE, SUITE 400
SPOKANE, WA 99201

CRAIG SOEHREN, BROKER
509.755.7548
craigs@kiemlehagood.com



OFFICE LOCATIONS

SPOKANE | COEUR D'ALENE | TRI-CITIES | PALOUSE | MISSOULA

No warranty or representation, expressed or implied, is made by Kiemle Hagood, its agents or its employees as to the accuracy of the information contained herein. All information furnished is from sources deemed reliable and submitted subject to errors, omissions, change of terms and conditions, prior sale, lease or financing, or withdrawal without notice. No one should rely solely on the above information, but instead should conduct their own investigation to independently satisfy themselves.

Kiemle Hagood respects the intellectual property of others:
If you believe the copyright in your work has been violated through this Website, please contact our office for notice of claims of copyright infringement. For your complaint to be valid under the Digital Millennium Copyright Act of 1998 (DMCA), you must provide the following information when providing notice of the claimed copyright infringement: Identify the material on the Website that you believe infringes your work, with enough detail so that we may locate it on the Website; provide your address, telephone number and email address; provide a statement that you have a good faith belief that the disputed use is not authorized by the copyright owner, its agent, or the law; provide a statement that the information in the notification is accurate, and under penalty of perjury, that the complaining party is authorized to act on behalf of the owner of an exclusive right that is allegedly infringed; and provide your physical or electronic signature. Upon receiving your complaint, Kiemle Hagood will, upon review, remove content that you believe infringes your copyright if the complaint is found to be valid.

